

ENGINE WIRE HARNESS, GSi / DPX

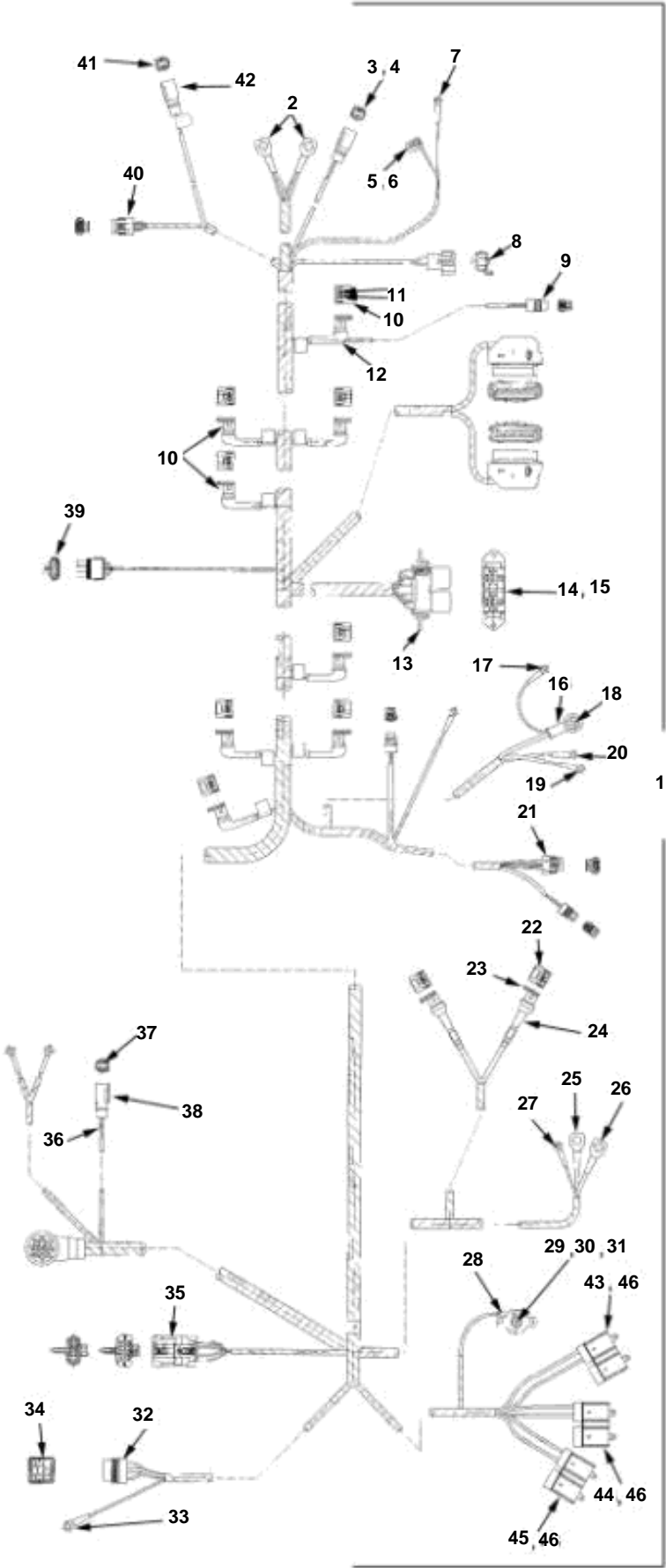

ENGINE WIRE HARNESS, GSi / DPX

REF	PART NO.	QTY	DESCRIPTION
1	3860047	1	Cable harness
2	3852527	2	Cable terminal
3	3853565	1	Connector, Trim sender
4	3852229	2	Cable terminal, Trim sender
5	3852084	1	Cable terminal, Oil pressure switch
6	3853320	1	Cover, Oil pressure switch
7	3852233	1	Cable terminal, Oil pressure transmitter
8	3854244	1	Cable, Ignition coil
9	3857142	1	Connector, MAT sensor
10	3855021	8	Housing, Injector cylinder
11	3853679	12	Cable terminal, Injector cylinder
12	3853711	8	Cable sleeve, Injector cylinder
13	3852210	1	Bracket, Fuel pump and ignition relay
14	3852247	4	Cable terminal
15	3852246	4	Cable terminal
16	3852038	1	Cable terminal, Alternator output
17	3852233	1	Cable terminal, Alternator sense
18	3852130	1	Rubber cap, Alternator output
19	3852235	1	Cable terminal, Alternator excite
20	3852245	1	Cable terminal, Alternator ground
21	514106	1	
22	3853679	2	Cable terminal, High pressure fuel pump
23	3855021	1	Housing, High pressure fuel pump
24	3853681	1	Cover, High pressure fuel pump
25	3852527	1	Cable terminal, Alternator output
26	3852527	1	Cable terminal, Starter solenoid
27	3852235	1	Cable terminal, Starter solenoid to starter terminal
28	3852245	1	Cable terminal, Circuit breaker
29	3854164	1	Fuse, 50 amp
30	3852064	2	Nut
31	3852001	2	Lock washer
32	3854192	1	Connector
33	3852227	1	Cable terminal, Starter relay
34	3852254	4	Cable terminal, Starter relay
35	3850025	1	
36	3852158	1	Lock strap
37	3852229	2	Cable terminal, Shift interrupt
38	3853565	1	Connector, Shift interrupt
39	3857189	3	Seal, MAP sensor
40	514106	1	Distributor
41	3852229	2	Cable terminal
42	3853565	1	Connector
43	979686	2	Fuse, 40 amp
44	966329	2	Fuse, 15 amp
45	968547	2	Fuse, 20 amp
46	3860455	3	Fuse holder