

AQ231B

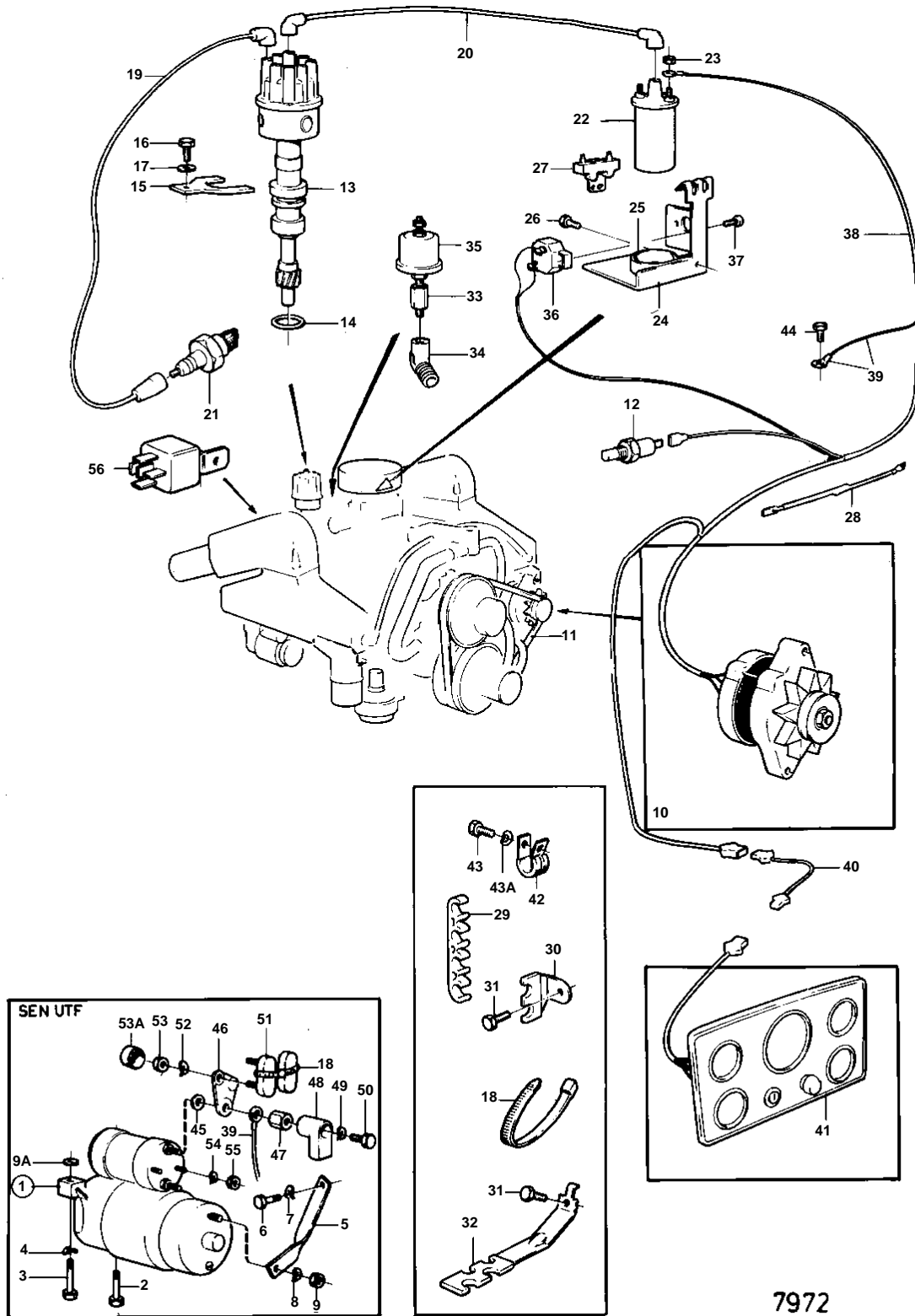

AQ231B

REF	PART NO.	QTY	DESCRIPTION	SEE SEC.	NOTES
1	855326	1	Starter motor		
				030-0450	
2	835424	1	Screw		
3	835425	1	Screw		
4	942336	2	Spring washer		
5	855315	1	Anchorage		
6	940113	1	Screw		
7	941907	1	Spring washer		
8	941906	1	Spring washer		
9	955825	1	Nut		
9A	841194	X	Adjusting washer		
10		1	ALTERNATOR AND INSTALLATION COMPONENTS	030-0188	
11	958498	1	V-belt		SEE GROUP 2B
12	835630	1	Temperature sensor		SEE GROUP 2B
	835649	1	Sender		FOR FLYING BRIDGE.
13	855929	1	Distributor, DISTRIBUTOR		
				030-0195	
14	835154	1	Gasket	IK	
15	841530	1	Clamp		
16	855824	1	Screw		
17	941744	1	Washer		
18	948210	X	Strip clamp		
19	855678	2	Ignition cable		CYL 1,2
	855677	2	Ignition cable		CYL 3,4
	855676	2	Ignition cable		CYL 5,6
	855675	2	Ignition cable		CYL 7,8 (855674)
20	856272	1	Ignition cable		
21	876047	2	Spark plug kit		
22	835998	1	Ignition coil		
23	834772	2	Nut		
24		1	BRACKET		SEE GROUP 2D
25	1219561	1	Clamp		
26	834371	1	Screw		
27	835999	1	Resistor		
28	834784	1	Resistor		
29	835429	2	Retainer		
30	835428	2	Retainer		
31	841426	1	Screw		
32	835427	2	Retainer		
33	835980	1	Nipple		
34	809109	1	Elbow nipple		
35	834920	1	Oil pressure sensor		
	834921	1	Oil pressure sensor		FOR FLYING BRIDGE.
36	841178	1	Fuse		40A
37	950013	2	Screw		
38	855316	1	Cable trunk		
39		X	· CABLE AND CABLE TERMINALS	030-0625	
			· TERMINALS		
40		X	EXTENSION CABLE		
41	841958	1	Instrument panel		
				030-0560	
	841960	1	Instrument panel		
				030-0570	
42	942810	1	Clamp		
43	955534	1	Screw		
43A	942336	1	Spring washer		
44	841426	3	Screw		
45	1585449	1	Gasket		
46	852986	1	Current bar		

AQ231B

REF	PART NO.	QTY	DESCRIPTION	SEE SEC.	NOTES
47	855330	1	Nut		
48	855798	1	Protecting sleeve		
49	940109	1	Lock washer		
50	970943	1	Screw		(955314)
51	856355	2	Fuse		55A (853502)
52	941906	1	Spring washer		
53	955781	1	Nut		
53A	853572	1	Protective cap		SERIAL NO 64892-
54	941905	2	Spring washer		
55	955780	2	Nut		
56	841177	1	Relay		