

AQ225D

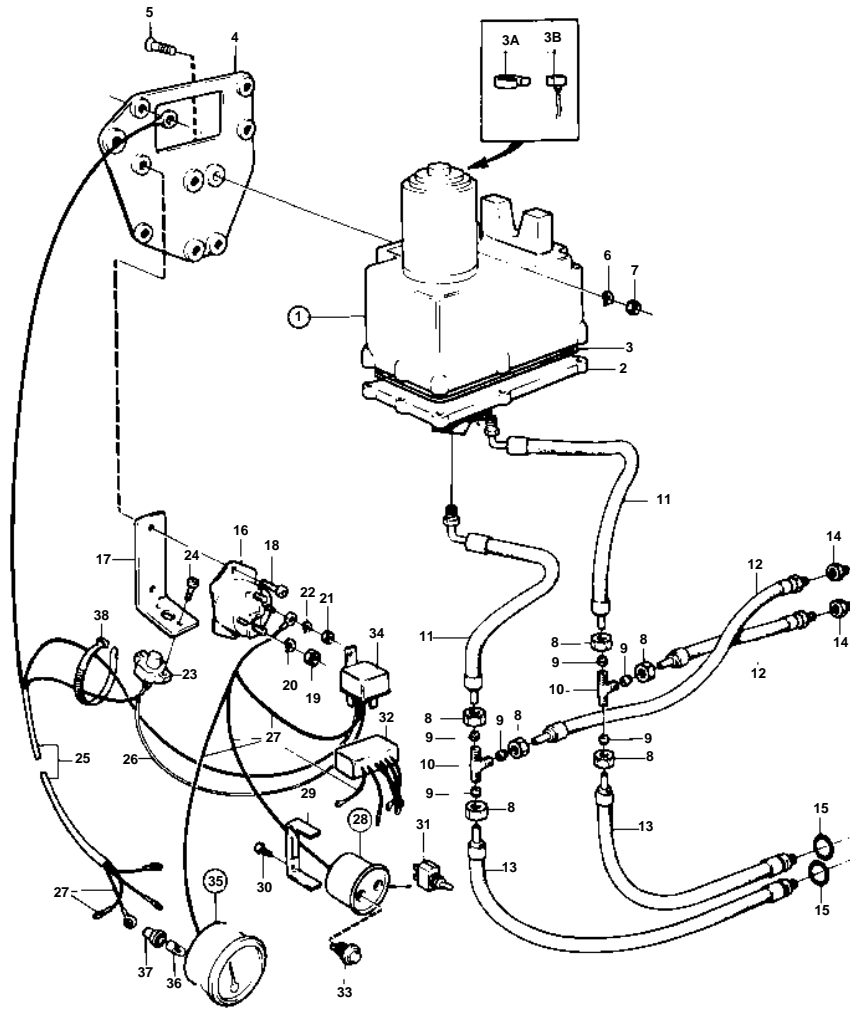

7518

AQ225D

REF	PART NO.	QTY	DESCRIPTION	SEE SEC.	NOTES
1		1	Hydraulic pump		
2		1	· Pump unit		
3		1	· Sealing ring		
3A		1	Carbon brush set		
3B		1	Spring kit		
4		1	Bracket		
5		4	Cross recessed sunk		L = 32 MM
6	941906	4	Spring washer		
7	955826	4	Hexagon nut		
8	941521	9	Fitting nut		
9	956967	6	Ferrule		
	964086	3	Plug		
10	964034	2	T-nipple		
11	852504	2	Hose coupling		
12	850909	2	Hose		
13	850908	2	Hose		
14	851042	2	Nipple	17257	
15	941820	2	O-ring	17257	
16	852565	2	Relay		
17		1	Bracket		
18	950046	3	Cross recessed screw		
19	955834	4	Hexagon nut		
20	941907	4	Spring washer		
21	955844	4	Hexagon nut		
22	941905	4	Spring washer		
23	841178	1	Automatic fuse		
24	950013	2	Cross recessed screw		
25		1	Cable trunk		
26		1	Cable trunk		
27		X	CABELS AND CABLE TERMINALS		SEE GROUP 3
28		1	Instrument panel		USA
		1	Instrument panel		(851501) EXCL USA
29	850372	1	· Attaching brace		
30	944201	2	· Cross recessed screw		
31	814322	1	· Toggle switch		
32		1	· Trimming limiter		(851771)
33	852026	1	· Switch		
34	876040	1	· Relay kit		
35	851502	1	· Trim indicator		INCLUDED ONLY IN 851501., EXCL USA
36	192451	1	· · Bulb		
37	841954	1	· · Lamp socket		
38	948210	X	Cable tie		