

AQ225D

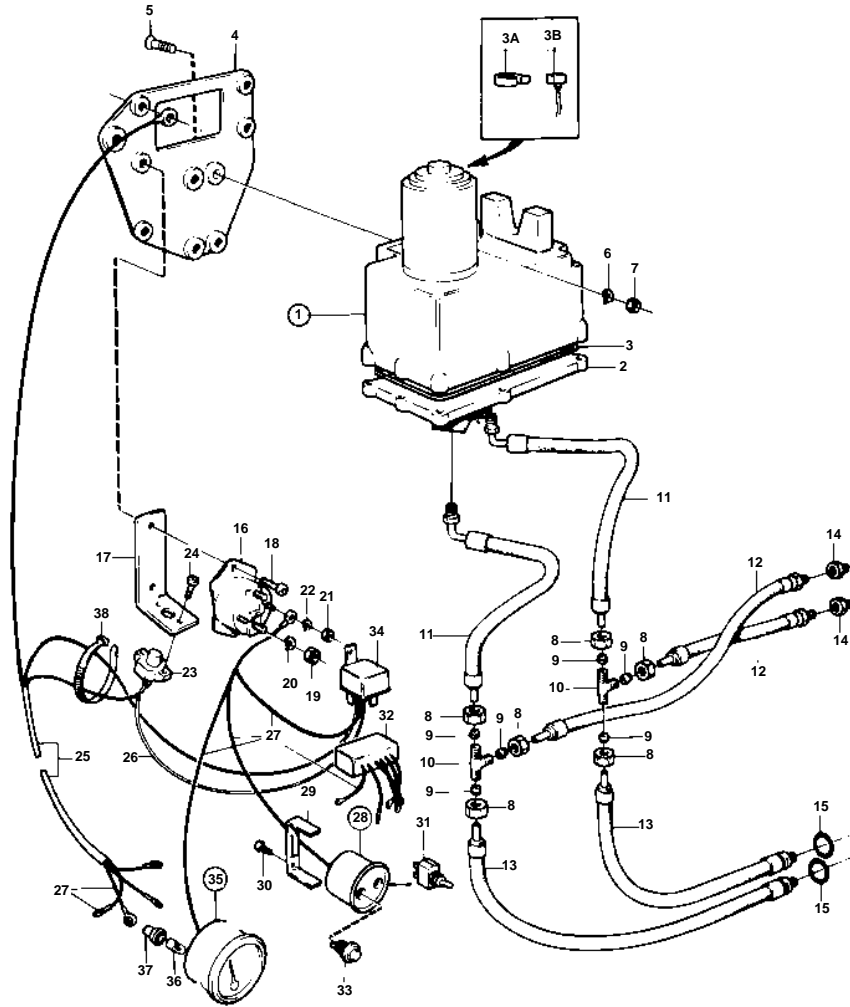

7518

AQ225D

| REF | PART NO. | QTY | DESCRIPTION                | SEE SEC. | NOTES                              |
|-----|----------|-----|----------------------------|----------|------------------------------------|
| 1   |          | 1   | Hydraulic pump             |          |                                    |
| 2   |          | 1   | • Pump unit                |          |                                    |
| 3   |          | 1   | • Sealing ring             |          |                                    |
| 3A  |          | 1   | Carbon brush set           |          |                                    |
| 3B  |          | 1   | Spring kit                 |          |                                    |
| 4   |          | 1   | Bracket                    |          |                                    |
| 5   |          | 4   | Cross recessed sunk        |          | L = 32 MM                          |
| 6   | 941906   | 4   | Spring washer              |          |                                    |
| 7   | 955826   | 4   | Hexagon nut                |          |                                    |
| 8   | 941521   | 9   | Fitting nut                |          |                                    |
| 9   | 956967   | 6   | Ferrule                    |          |                                    |
|     | 964086   | 3   | Plug                       |          |                                    |
| 10  | 964034   | 2   | T-nipple                   |          |                                    |
| 11  | 852504   | 2   | Hose coupling              |          |                                    |
| 12  | 850909   | 2   | Hose                       |          |                                    |
| 13  | 850908   | 2   | Hose                       |          |                                    |
| 14  | 851042   | 2   | Nipple                     | 17257    |                                    |
| 15  | 941820   | 2   | O-ring                     | 17257    |                                    |
| 16  | 852565   | 2   | Relay                      |          |                                    |
| 17  |          | 1   | Bracket                    |          |                                    |
| 18  | 950046   | 3   | Cross recessed screw       |          |                                    |
| 19  | 955834   | 4   | Hexagon nut                |          |                                    |
| 20  | 941907   | 4   | Spring washer              |          |                                    |
| 21  | 955844   | 4   | Hexagon nut                |          |                                    |
| 22  | 941905   | 4   | Spring washer              |          |                                    |
| 23  | 841178   | 1   | Automatic fuse             |          |                                    |
| 24  | 950013   | 2   | Cross recessed screw       |          |                                    |
| 25  |          | 1   | Cable trunk                |          |                                    |
| 26  |          | 1   | Cable trunk                |          |                                    |
| 27  |          | X   | CABELS AND CABLE TERMINALS |          | SEE GROUP 3                        |
| 28  |          | 1   | Instrument panel           |          | USA                                |
|     |          | 1   | Instrument panel           |          | (851501) EXCL USA                  |
| 29  | 850372   | 1   | • Attaching brace          |          |                                    |
| 30  | 944201   | 2   | • Cross recessed screw     |          |                                    |
| 31  | 814322   | 1   | • Toggle switch            |          |                                    |
| 32  |          | 1   | • Trimming limiter         |          | (851771)                           |
| 33  | 852026   | 1   | • Switch                   |          |                                    |
| 34  | 876040   | 1   | • Relay kit                |          |                                    |
| 35  | 851502   | 1   | • Trim indicator           |          | INCLUDED ONLY IN 851501., EXCL USA |
| 36  | 192451   | 1   | • • Bulb                   |          |                                    |
| 37  | 841954   | 1   | • • Lamp socket            |          |                                    |
| 38  | 948210   | X   | Cable tie                  |          |                                    |