

AQ225D, AQ225E, AQ225F, BB225A, BB225B, BB225C

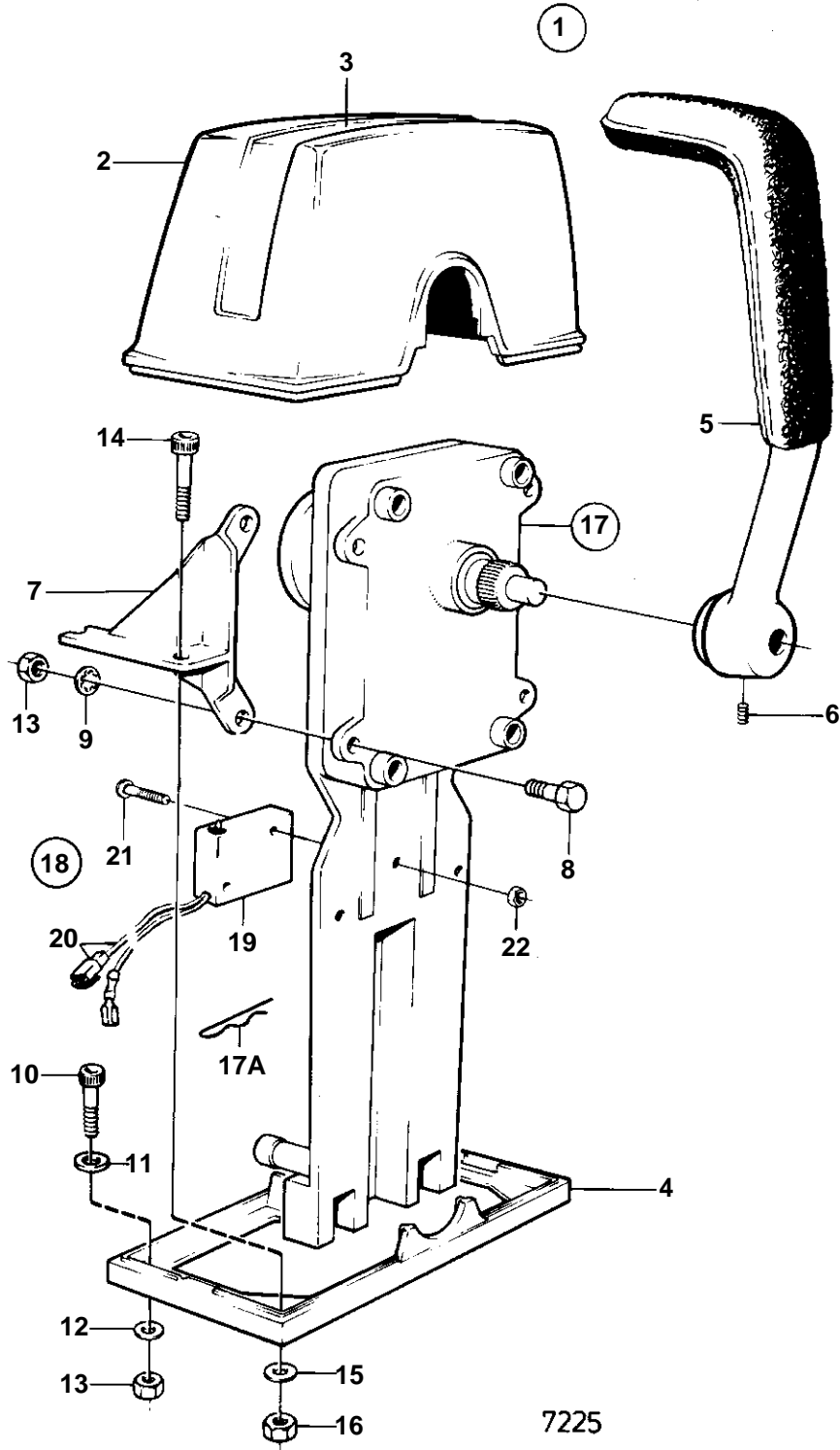

AQ225D, AQ225E, AQ225F, BB225A, BB225B, BB225C

REF	PART NO.	QTY	DESCRIPTION	NOTES
1	851602	2	Mounting kit	
2	839472	2	• Cover	
3		2	• Decal	
4	839474	2	• Plate	
5	839475	2	• Hand lever	
6	839693	2	• Lock screw	M8
10	947671	4	• Hex. socket screw	
11	940090	4	• Washer	
12	960138	4	• Washer	
13	955780	4	• Hexagon nut	
14	947671	4	• Hex. socket screw	
15	960138	4	• Washer	
16	955780	4	• Hexagon nut	
17	851600	2	Control	
17A	852924	1	• Clip	
18	841165	1	Switch	MAIN STATION.
	841166	1	Switch	SECOND STATION.
19	850200	2	• Toggle switch	
20		X	• • CABLES AND TERMINALS	SEE GROUP 3
21	946177	4	• Cross recessed screw	
22	947536	4	• Hexagon nut	