

AQ225E

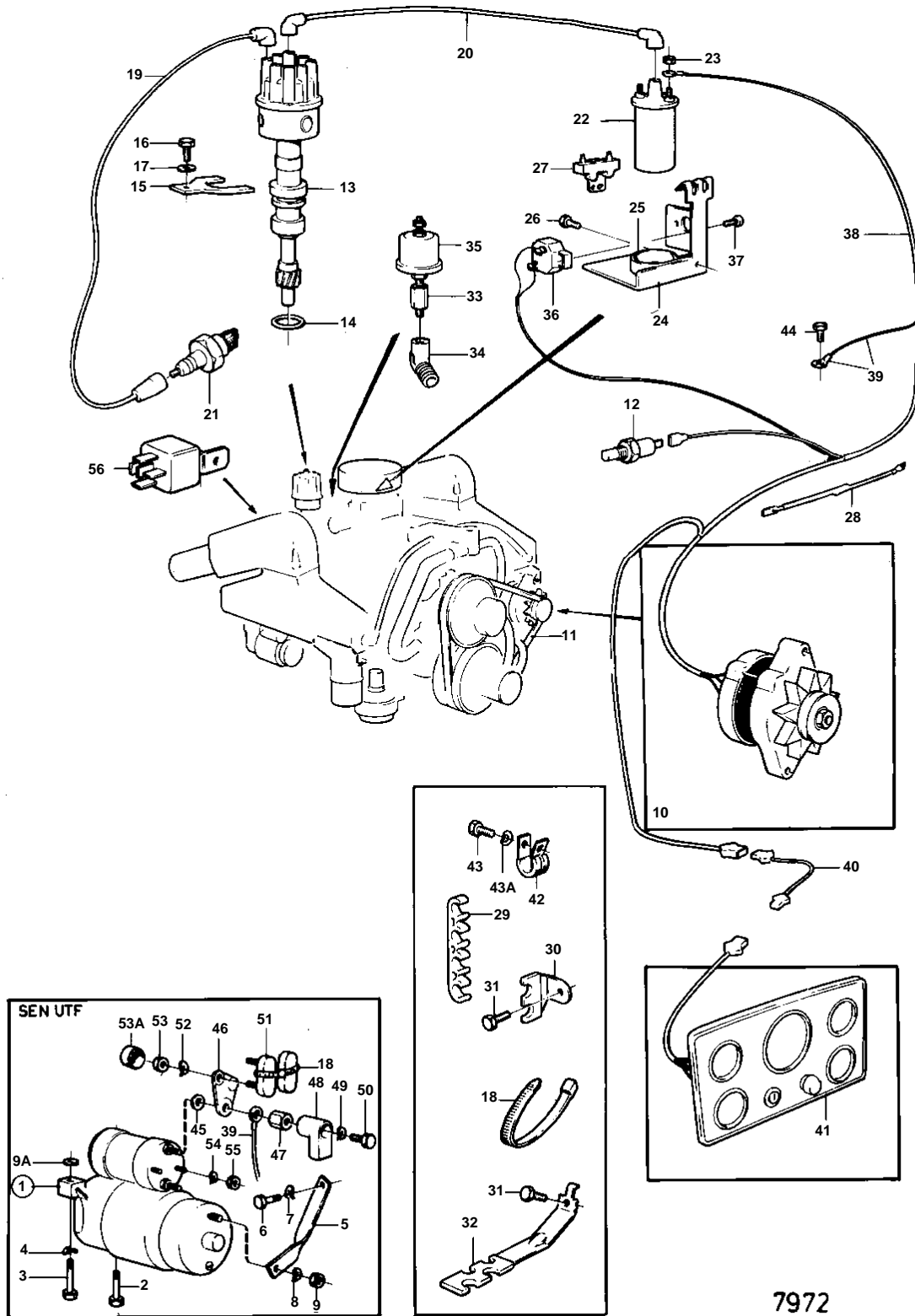

AQ225E

REF	PART NO.	QTY	DESCRIPTION	SEE SEC.	NOTES
1	855326	1	Starter motor		
				17247	
2	835424	1	Screw		
3	835425	1	Screw		
4	942336	2	Spring washer		
5	855315	1	Anchorage		
6	940113	1	Hexagon screw		
7	941907	1	Spring washer		
8	941906	1	Spring washer		
9	955825	1	Hexagon nut		
9A	841194	X	Adjusting washer		
10		1	ALTERNATOR AND INSTALLATION COMPONENTS	17239	
11	958498	1	V-belt		SEE GROUP 2B
12	835630	1	Temperature sensor		SEE GROUP 2B
	835649	1	Sensor		FOR FLY BRIDGE.
13	841069	1	Distributor, DISTRIBUTOR		
				17243	
14	835154	1	Gasket		
15	841530	1	Retainer		
16	855824	1	Screw		
17	941744	1	Washer		
18	948210	X	Cable tie		
19	841228	2	Ignition cable		CYL 1,2
	841227	2	Ignition cable		CYL 3,4
	841226	2	Ignition cable		CYL 5,6
	841225	2	Ignition cable		CYL 7,8
20	855674	1	Ignition cable		
21	876047	2	Spark plug kit		
22	835998	1	Ignition coil		
23		2	Nut		
24	834700	1	Bracket		SEE GROUP 2D
25	1219561	1	Clamp		
26		1	Screw		
27	835999	1	Series resistance		
28	834784	1	Resistor		
29		2	Retainer		
30		2	Retainer		
31	841426	1	Screw		
32	835427	2	Retainer		
33	835980	1	Nipple		
34	809109	1	Elbow nipple		
35	834920	1	Oil pressure sensor		
	834921	1	Oil pressure sensor		FOR FLY BRIDGE.
36	841178	1	Automatic fuse		40A
37	950013	2	Cross recessed screw		
38		1	Cable trunk		
39		X	CABLE AND CABLE TERMINALS	17252	
40		X	EXTENSION CABLE		
41		1	Instrument panel		
				17250	
		1	Instrument panel		
				17251	
42	942810	1	Clamp		
43	955534	1	Hexagon screw		
43A	942336	1	Spring washer		
44	841426	3	Screw		
45	1585449	1	Gasket		
46	852986	1	Current bar		
47	855330	1	Nut		
48	855798	1	Protecting sleeve		
49	940109	1	Toothed washer		

AQ225E

REF	PART NO.	QTY	DESCRIPTION	SEE SEC.	NOTES
50	955314	1	Hexagon screw		
51	853502	2	Fuse		
52	941906	1	Spring washer		
53	955781	1	Hexagon nut		
53A	853572	1	Protective cap		
54	941905	2	Spring washer		
55	955780	2	Hexagon nut		
56	841177	1	Relay		