

BB225A

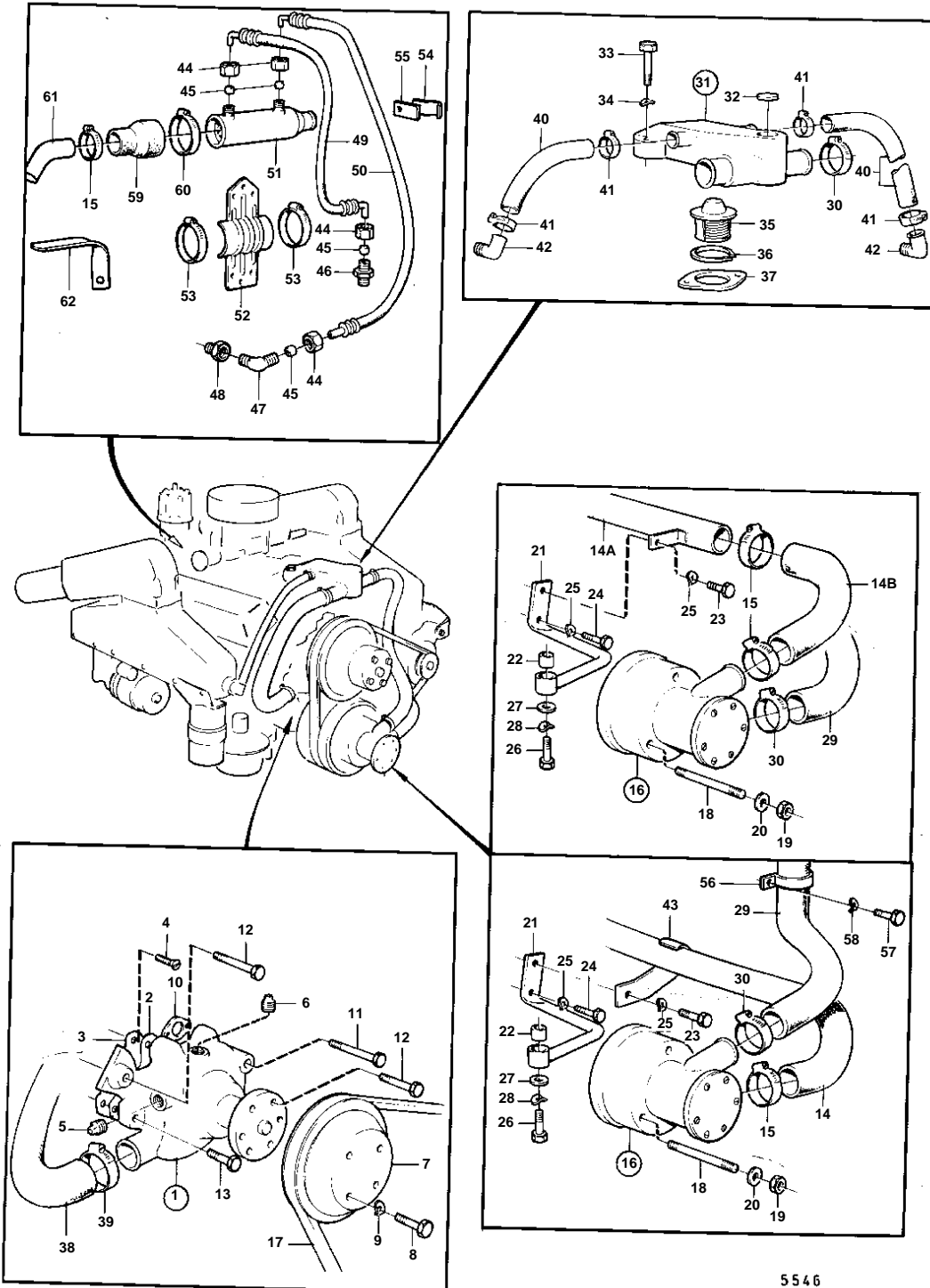

5546

BB225A

REF	PART NO.	QTY	DESCRIPTION	SEE SEC.	NOTES
1	835390	1	Water pump		
2	841036	1	· Gasket		
3		1	· Plate		
4	955511	6	· Hexagon screw		(835369)
5	952358	1	· Plug		
6	952359	1	· Plug		
7	855283	1	Pulley		
8	955655	4	Hexagon screw		
9	941907	4	Spring washer		
10	835210	2	Gasket		
11	940162	1	Hexagon screw		
12	955536	2	Hexagon screw		
13	955540	1	Hexagon screw		
14	841147	1	Hose		FOR LEFT HAND ROTATION ON ENGINE.
14A		1	Suction line		FOR RIGHT HAND ROTATION ON ENGINE.
14B		1	Hose		FOR RIGHT HAND ROTATION ON ENGINE.
15	961669	3	Hose clamp		
16	826456	1	Sea water pump		REPL. BY 1EA 841640, 3EA 948324, 3EA 955894 AND 3EA 942336.
				17217	
	841640	1	Sea water pump		
				17217	
17	958497	1	V-belt		
18	826500	3	Stud		
19		3	Lock nut		
20	941907	3	Spring washer		
21	826421	1	Torque rod		
22	826422	1	Rubber bushing		
23	940115	1	Hexagon screw		
24	955534	1	Hexagon screw		SEE GROUP 3
25	942336	2	Spring washer		
26	955523	1	Hexagon screw		
27	960141	1	Washer		
28	941907	1	Spring washer		
29	826423	1	Hose		
30	961669	2	Hose clamp		
31	841923	1	Thermostat housing		REPLACED BY 1EA 855485 THERMOSTAT HOUSING, 1EA 855486 CIRCLIP AND 1EA 1317466 SEAL RING., EARLY TYPE
	855485		Thermostat housing		LATE TYPE
32	192426	1	· Expansion plug		
33	955537	2	Hexagon screw		
34	942336	2	Spring washer		
35	875794	1	Thermostat kit		
36	835552	1	Lock ring		
37	835417	1	Gasket		
38	834906	1	Hose		
39	961671	2	Hose clamp		
40	952970	X	Hose		L = 2X350 MM
41	841037	4	Hose clamp		
42	961610	2	Hose nipple	17207	
43	834974	1	Clamp		FOR LEFT HAND ROTATION ON ENGINE.
44	956984	4	Fitting nut		
45	956970	4	Ferrule		
46	804533	1	Nipple		SEE GROUP 4A
47	941757	1	Elbow nipple		SEE GROUP 4A
48	941750	1	Nipple		SEE GROUP 4A
49	841171	1	Hose assembly		L = 400 MM
50		1	Hose assembly		L = 575 MM
51		1	Oil cooler		
52	841383	1	Bracket		SEE GROUP 2A
53	961671	1	Hose clamp		
56	841307	1	Clamp		
57	955534	1	Hexagon screw		
58	942336	1	Spring washer		

BB225A

REF	PART NO.	QTY	DESCRIPTION	SEE SEC.	NOTES
59		1	Radiator hose		
60	961671	1	Hose clamp		
61		1	Riser		FOR LEFT HAND ROTATION ON ENGINE.
62		1	Clamp		FOR LEFT HAND ROTATION ON ENGINE.