

AQ130A, AQ130B, AQ130C, AQ130D

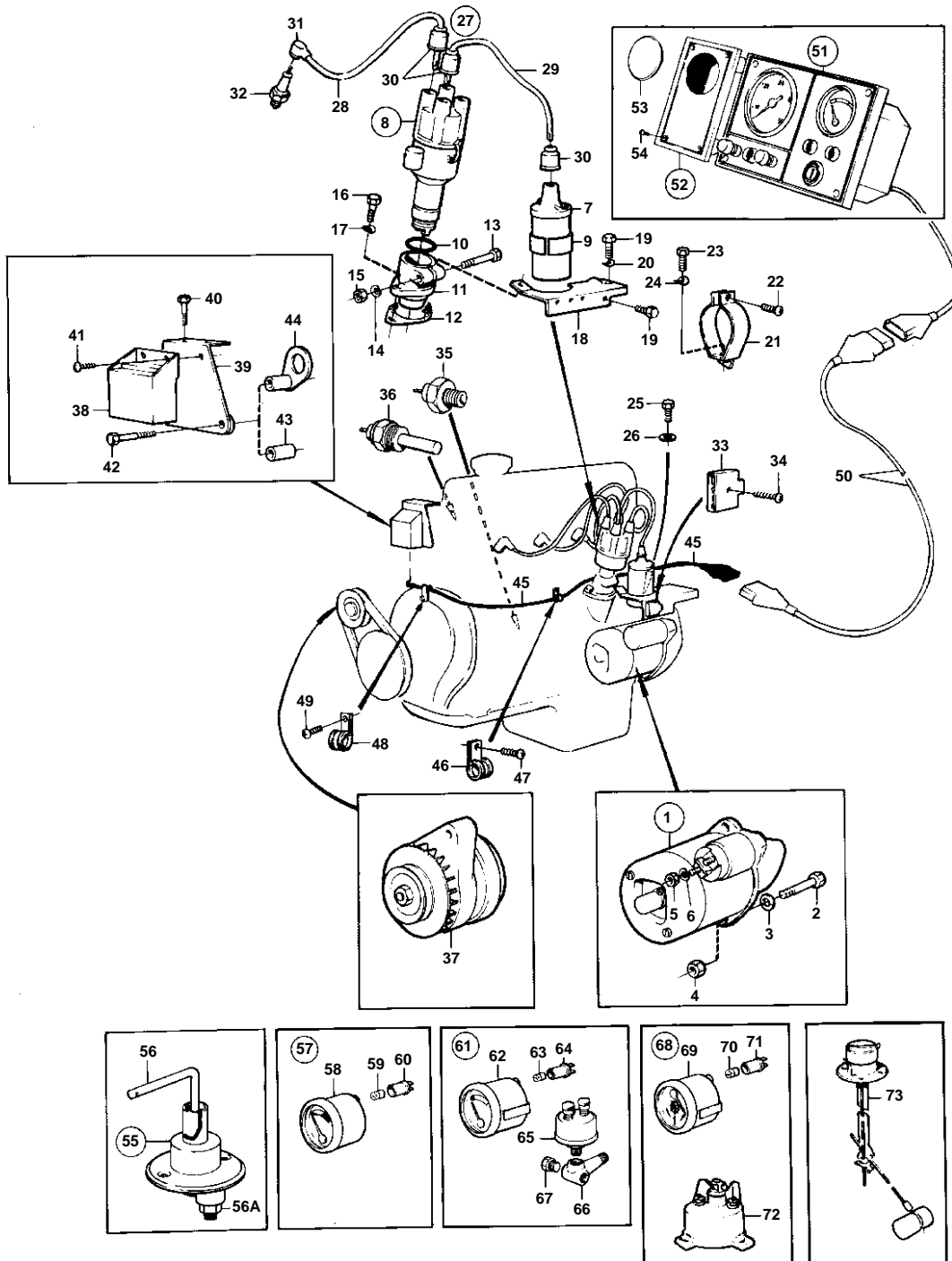

6104

## AQ130A, AQ130B, AQ130C, AQ130D

REF	PART NO.	QTY	DESCRIPTION	SEE SEC.	NOTES
1		1			POUR SECTION CABLE 0,5-1,5 MILLIM%ETRE-CARR%E1
				12843	
	834339	1	Starter motor		MOXXXX/114815-
	3803074	1	Starter motor, exch, exch		MOXXXX/114815-
				12844	
2		2	Hexagon screw		
3	955896	2	Washer		
4	940157	2	Hexagon nut		
5	955782	1	Hexagon nut		
6	941907	1	Spring washer		
7		1	IGNITION COIL		FOR CABLE AREA 0,75-2,0 SQMM., MO-XXXX/120676
	834462	1	Ignition coil		MOXXXX/120677-
8	241531	1	Distributor		FOR CABLE AREA 1,5-2,5 SQMM., FOR CABLE AREA 6,5-10,5 SQMM., ALT
				12864	
	834465	1	Distributor		FOR CABLE AREA 10,5-16,0 SQMM., ALT
				12864	
9		1	Intermediate ring		MO-XXXX/120676
10	925060	1	O-ring		
11		1	Flange		
12	418265	1	Gasket		
13	955515	1	Hexagon screw		
14	941906	1	Spring washer		
15	955825	1	Hexagon nut		
16	955524	2	Hexagon screw		
17	941907	2	Spring washer		
18		1	BRACKET		FOR CABLE AREA 3,0-6,0 SQMM.
		1	Bracket		MO-XXXX/103956
		1	Bracket		MOXXXX/103957-
19	955524	2	Hexagon screw		MO-XXXX/103956
20	941907	1	Spring washer		MO-XXXX/103956
21		1	Clamp, CLAMP		MOXXXX/103957-
					MO-XXXX/120676
		1	Clamp		MOXXXX/120677-
22		1	Screw		MOXXXX/103957-
23	955524	1	Hexagon screw		MOXXXX/103957-
24	955894	1	Washer		MOXXXX/103957-
25	940113	1	Hexagon screw		MOXXXX/103957-
26	941907	1	Spring washer		MOXXXX/103957-
27	875363	1	Cable kit		
28		4	· IGNITION CABLE		
29		1	· IGNITION CABLE		
30	241608	6	· Protective sleeve		
31	956913	4	· Cable terminal		
32	875803	1	Spark plug kit		(241627)
33		1	FUSE BOX		FOR CABLE AREA 16 SQ MM., EARLY TYPE
	824823	1	Fuse box		LATE TYPE
34		2	Screw		EARLY TYPE
		1	Screw		LATE TYPE
35	1266085	1	Pressure switch		(672910)
36	824552	1	Temperature sensor		
37		1	ALTERNATOR AND INSTALLATION COMPONENTS	12866	
38		1	CHARGING RELAY BRACKET		REPLACED BYLATE TYPE 845108., MO-XXXX/75892
39		1	Bracket		MO-XXXX/75892
40	955528	2	Hexagon screw		SEE GROUP 2B
41		3	Cross recessed screw		MO-XXXX/75892
42	955539	1	Hexagon screw		MO-XXXX/75892
43		1	Spacer tube		AQ200D MO-11576, AQ225D MO-11736, AQ260A MO-11506, AQ290A MO-12259., EARLY TYPE

## AQ130A, AQ130B, AQ130C, AQ130D

REF	PART NO.	QTY	DESCRIPTION	SEE SEC.	NOTES
44		1	Lifting eye, LIFT EYE		AQ200D MO-11576, AQ225D MO-11736, AQ260A MO-11506, AQ290A MO-12259., AQ200D MO 11577-, AQ225D MO 11737-, AQ260A MO 11507-, AQ290A MO12260-., LATE TYPE
		1	LIFT EYE		MO-XXXX/75892
		1	LIFT EYE		MOXXXX/75893-
45		1	Cable trunk		MO-XXXX/103956
		1	Cable trunk		MOXXXX/103957-
46	952627	1	Clamp		MO-XXXX/103956
47	950046	1	Cross recessed screw		MO-XXXX/103956
48	946834	2	Clamp		MO-XXXX/103956
	946834	1	Clamp		MOXXXX/103957-
49		2	Cross recessed screw		MO-XXXX/103956
		1	Cross recessed screw		MOXXXX/103957-
50	825738	X	Cable trunk		L = 2500 MM
	820419	X	Cable		L = 7000 MM
		X	LIFT DEVICE		SEE GROUP 4A, 9
51		1	Instrument panel, INSTRUMENT PANEL SINGLE INSTALLATION		EARLY TYPE
				12851	
		1	Instrument panel, INSTRUMENT PANEL TWIN INSTALLATION		EARLY TYPE
			· COMPONENTS		SEE GROUP 9
		1			REPLACED BY 1EA 846622 FLOW SWITCH AND 1EA 846632 NIPPLE., ACC. TO CLASSIFICATION., MO-XXXX/114815
				12852	
		1	Instrument panel		ACC. TO CLASSIFICATION., MOXXXX/114815-
				12852	
52		1	Instrument panel		
53	839128	1	· Plastic plug		
54	944540	4	· Screw		
55	870980	1	Main switch		
56	243700	1	· Handle		
56A	955783	2	· Hexagon nut		
57		1	Voltmeter		12V
58		1	· Voltmeter		
59	19923	1	· Bulb		
60	808175	1	· Lamp socket		
61		1	Instrument		
62		1	· Instrument		
63	19923	1	· Bulb		
64	808175	1	· Lamp socket		
65	881432	1	· Sensor		
66	834391	1	· T-nipple		
67	191026	1	· Plug		
68		1	Rudder indicator		
69		1	· Rudder indicator		
70	19923	1	· Bulb		
71	808175	1	· Lamp socket		
72	837772	1	· Position sensor		
73		1	Tank gauge		SEE GROUP 9
			DRINKING WATER		
		1	Tank gauge		SEE GROUP 9
			FUEL		