

7.4GLPMDA, 7.4GLPMDM, 8.2GLPMDA, 8.2GLPMDM, 7.4GLIMDA, 7.4GLIMDM, 8.2GLIMDA, 8.2GLIMDM

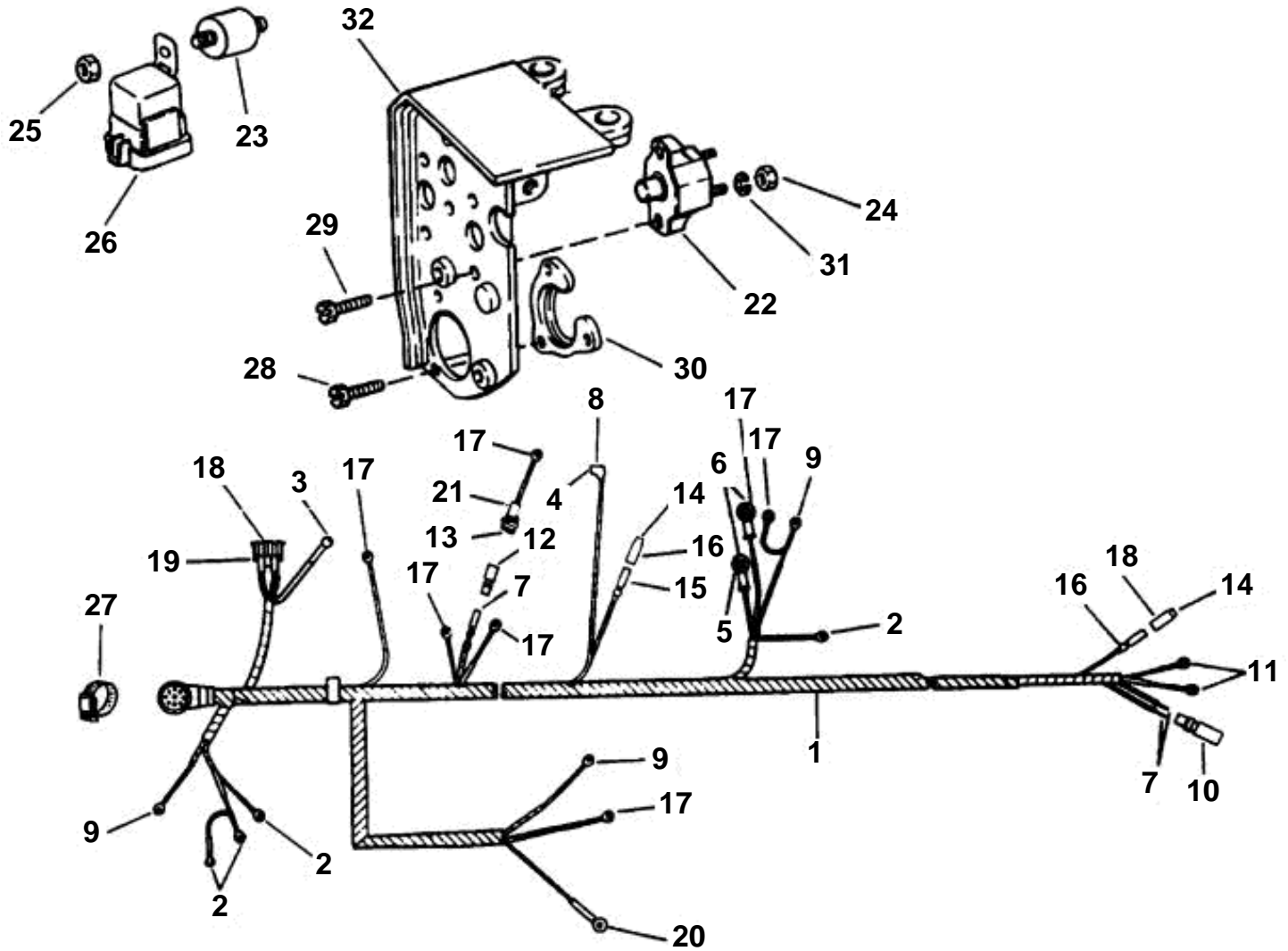

7.4GLPMDA, 7.4GLPMDM, 8.2GLPMDA, 8.2GLPMDM, 7.4GLIMDA, 7.4GLIMDM, 8.2GLIMDA, 8.2GLIMDM

REF	PART NO.	QTY	DESCRIPTION	NOTES
1	3850451	1	Cable harness	GL DP
2	3852245	4	· Cable terminal	
3	3852107	1	· Cable terminal, Bracket ground	
4	3852084	1	· Cable terminal, Choke	
5	3852038	1	· Cable terminal, Alternator output	
6	3852130	2	· Rubber cap	
7	3852229	2	· Cable terminal, Pin	
8	3853320	1	· Cover, Terminal, choke	
9		3	· Cable terminal	
10	3853565	1	· Connector	
11	3850998	2	· Cable terminal, Ground	
12		1	· Connector, Socket	
13		1	· Connector	
14	3852181	2	· Cap, Socket	
15		2	· Terminal	
16	3852244	2	· Cable terminal, Socket	
17	3852233	2	· Cable terminal	
18	3852254	4	· Cable terminal, Starter relay	
19	3854192	1	· Connector	
20	3852037	1	· Cable terminal, Starter	
21	3850991	1	· Connector	
22	3854164	1	· Breaker, 50A	
23	3850234	1	Isolator, Starter relay	
24	3852064	4	Nut, Circuit breaker	
25	3852118	1	Nut, Starter relay	
26	3854138	1	Relay, Starter motor	
27	3853786	1	Clamp, Instrument cable	
28	3852208	3	Screw, Cable retainer	
29	3853620	2	Screw, Circuit breaker to bracket	
30	3852825	1	Retainer, Engine cable	
31	3852001	4	Lock washer, Circuit breaker	
32	3850455	1	Bracket, Engine cable	