

500A, 501A, 501A/MS4

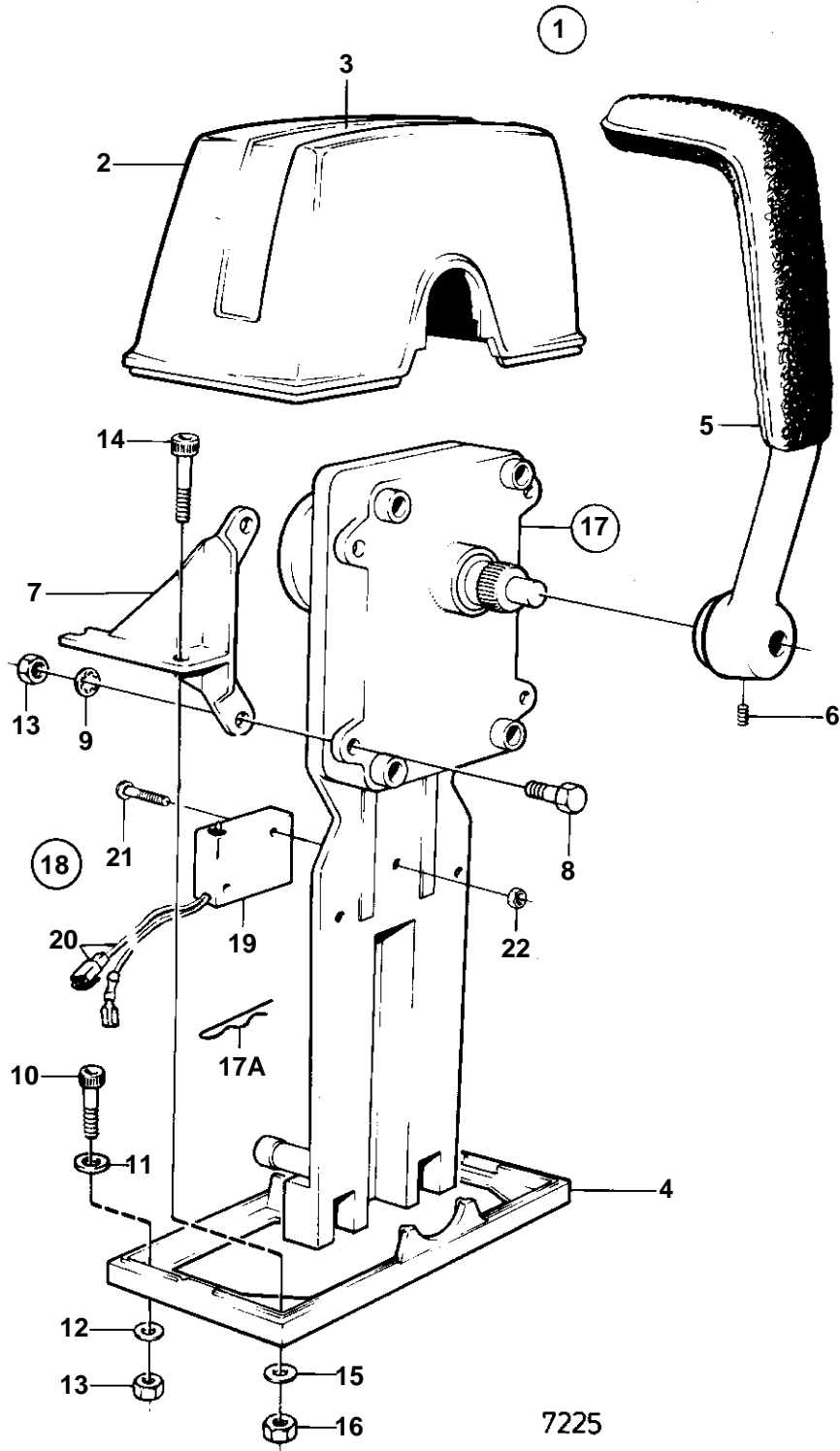

500A, 501A, 501A/MS4

REF	PART NO.	QTY	DESCRIPTION	NOTES
1	851602	1	Mounting kit	
2	839472	1	· Cover	
3		1	· Decal	
4	839474	1	· Plate	
5	839475	1	· Hand lever	
6	839693	1	· Lock screw	M8
10	947671	2	· Hex. socket screw	
11	940090	2	· Washer	
12	960138	2	· Washer	
13	955780	2	· Hexagon nut	
14	947671	2	· Hex. socket screw	
15	960138	2	· Washer	
16	955780	2	· Hexagon nut	
17	851600	1	Control	
17A	852924	1	· Clip	
18	855352	1	Neutral position con	MAIN STATION., (841165)
19	850200	1	· Toggle switch	
20		X	· · CABLES AND TERMINALS	SEE GROUP 3
21	946177	2	· Cross recessed screw	
22	947536	2	· Hexagon nut	