

500A, 501A, 501A/MS4

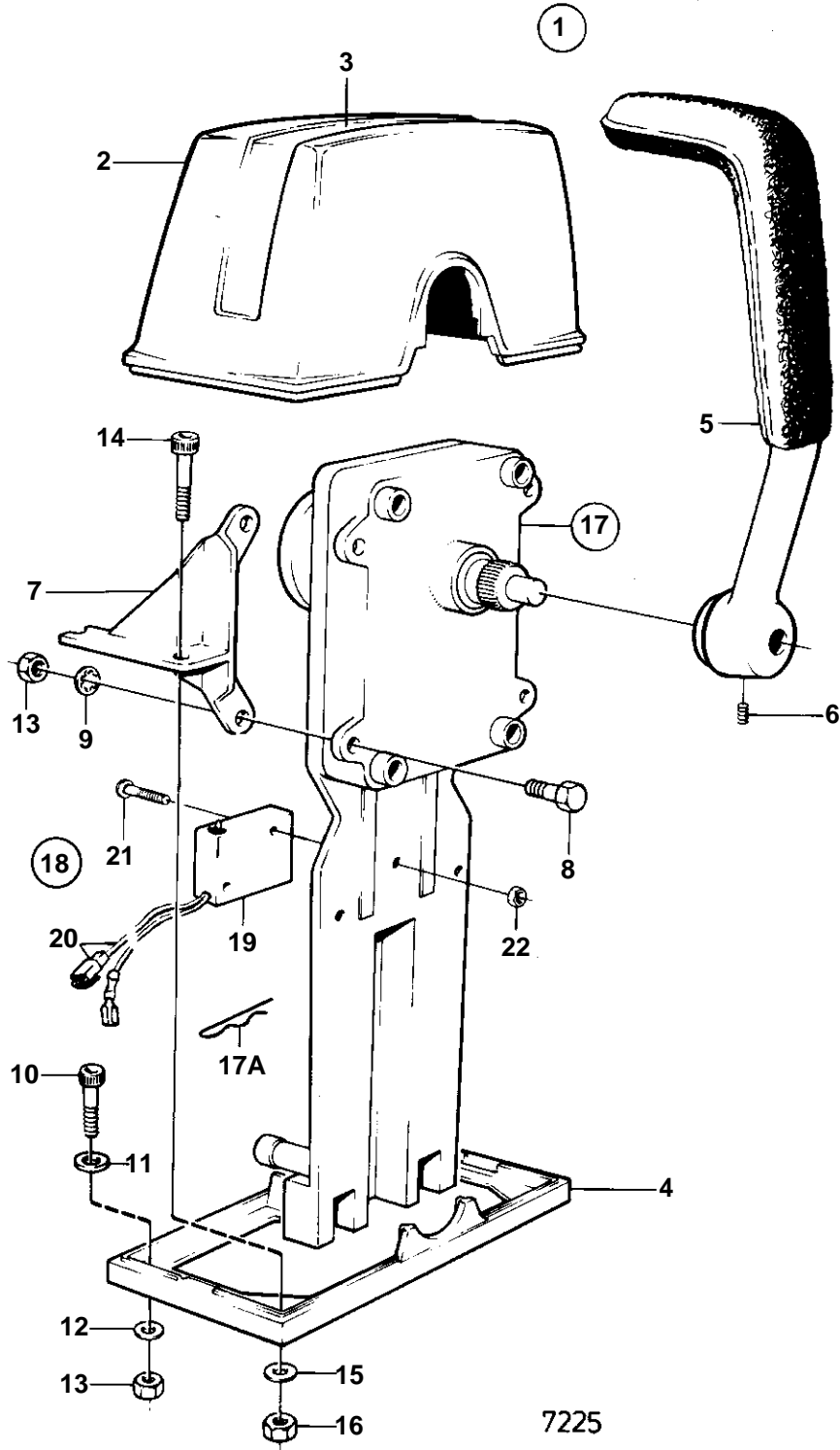

500A, 501A, 501A/MS4

REF	PART NO.	QTY	DESCRIPTION	NOTES
1	839470	2	Mounting kit	REPL BY 851602
2	839472	2	· Cover	
4	839474	2	· Plate	
5	839475	2	· Hand lever	
6		2	· Lock screw	M5
	839693	2	· Lock screw	M8
7		2	· Bracket	MARKED 839480
	839481	2	· Bracket	MARKED 839481
8	955244	8	· Hexagon screw	
9		8	· Toothed washer	
10	947671	4	· Hex. socket screw	
12	960138	4	· Washer	
13	955780	12	· Hexagon nut	
14	947672	4	· Hex. socket screw	
15	960139	4	· Washer	
16	955781	4	· Hexagon nut	
17	839469	2	Control	REPL BY 851600
18	855352	1	Neutral position con	MAIN STATION., (841165)
	855352	1	Neutral position con	SECOND STATION.
19	850200	2	· Toggle switch	
20		X	· · CABLES AND TERMINALS	SEE GROUP 3
21	946177	4	· Cross recessed screw	
22	947536	4	· Hexagon nut	