

500A, 501A, 501A/MS4

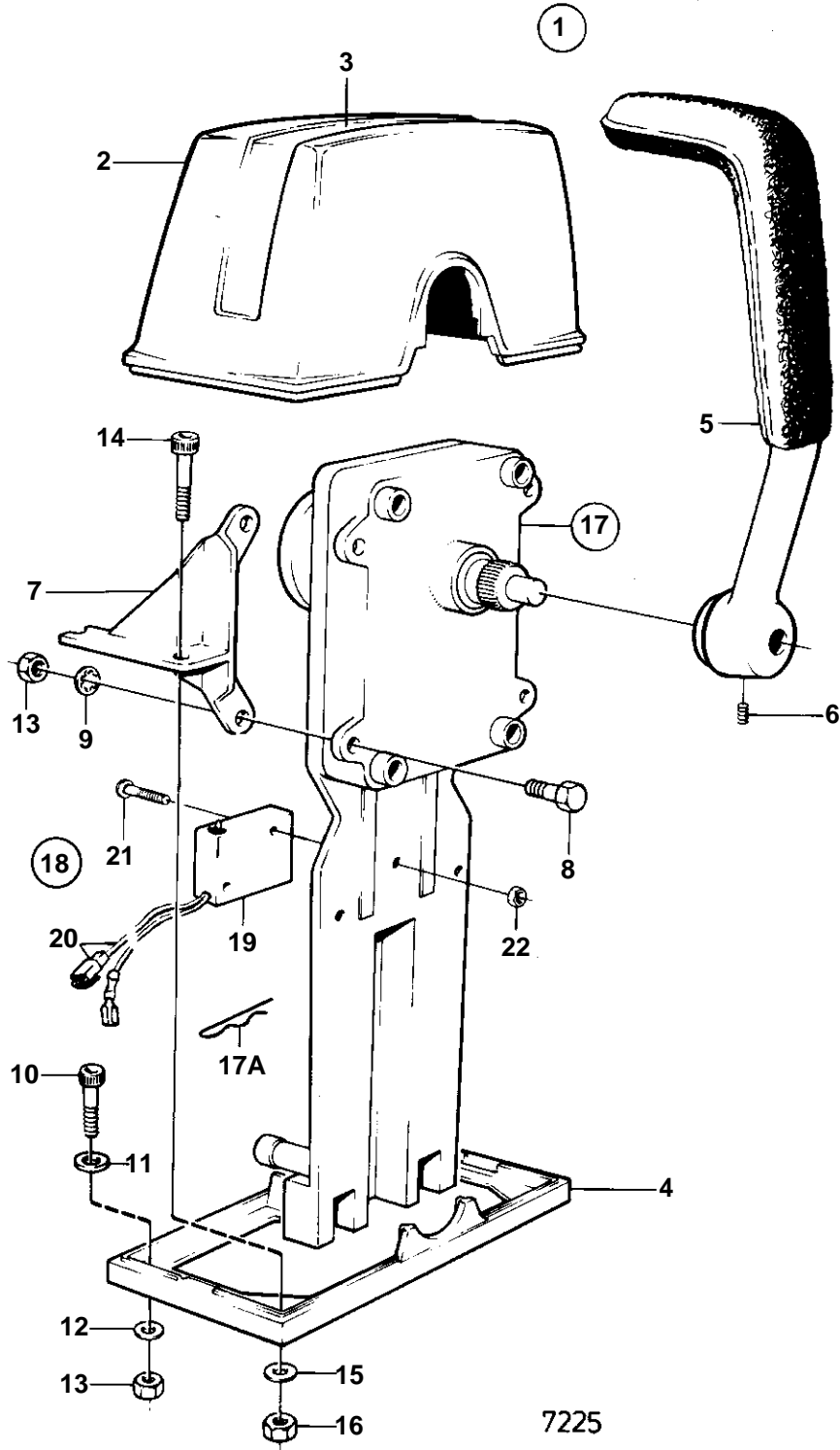

500A, 501A, 501A/MS4

REF	PART NO.	QTY	DESCRIPTION	SEE SEC.	NOTES
1	839470	1	Mounting kit		REPL BY 851602
2	839472	1	· Cover		
4	839474	1	· Plate		
5	839475	1	· Hand lever		
6		1	· Lock screw		M5
	839693	1	· Lock screw		M8
7		1	· Bracket		MARKED 839480
	839481	1	· Bracket		MARKED 839481
8	955244	4	· Hexagon screw		
9		4	· Toothed washer		
10	947671	2	· Hex. socket screw		
12	960138	2	· Washer		
13	955780	6	· Hexagon nut		
14	947672	2	· Hex. socket screw		
15	960139	2	· Washer		
16	955781	2	· Hexagon nut		
17	839469	1	Control		REPL BY 851600
				19813	
				19813	
18	855352	1	Neutral position con		MAIN STATION., (841165)
19	850200	1	· Toggle switch		
20		X	· · CABLES AND TERMINALS		SEE GROUP 3
21	946177	2	· Cross recessed screw		
22	947536	2	· Hexagon nut		