

5.8FIPNACE, 5.8FIPNCBCE, 5.8FIPNCMCE, 5.8FIPNCSCE, 5.8FSIINCC, 5.8FSIINCS, 5.8FSIPNACE, 5.8FSIPNCD, 5.8FSIPNCS

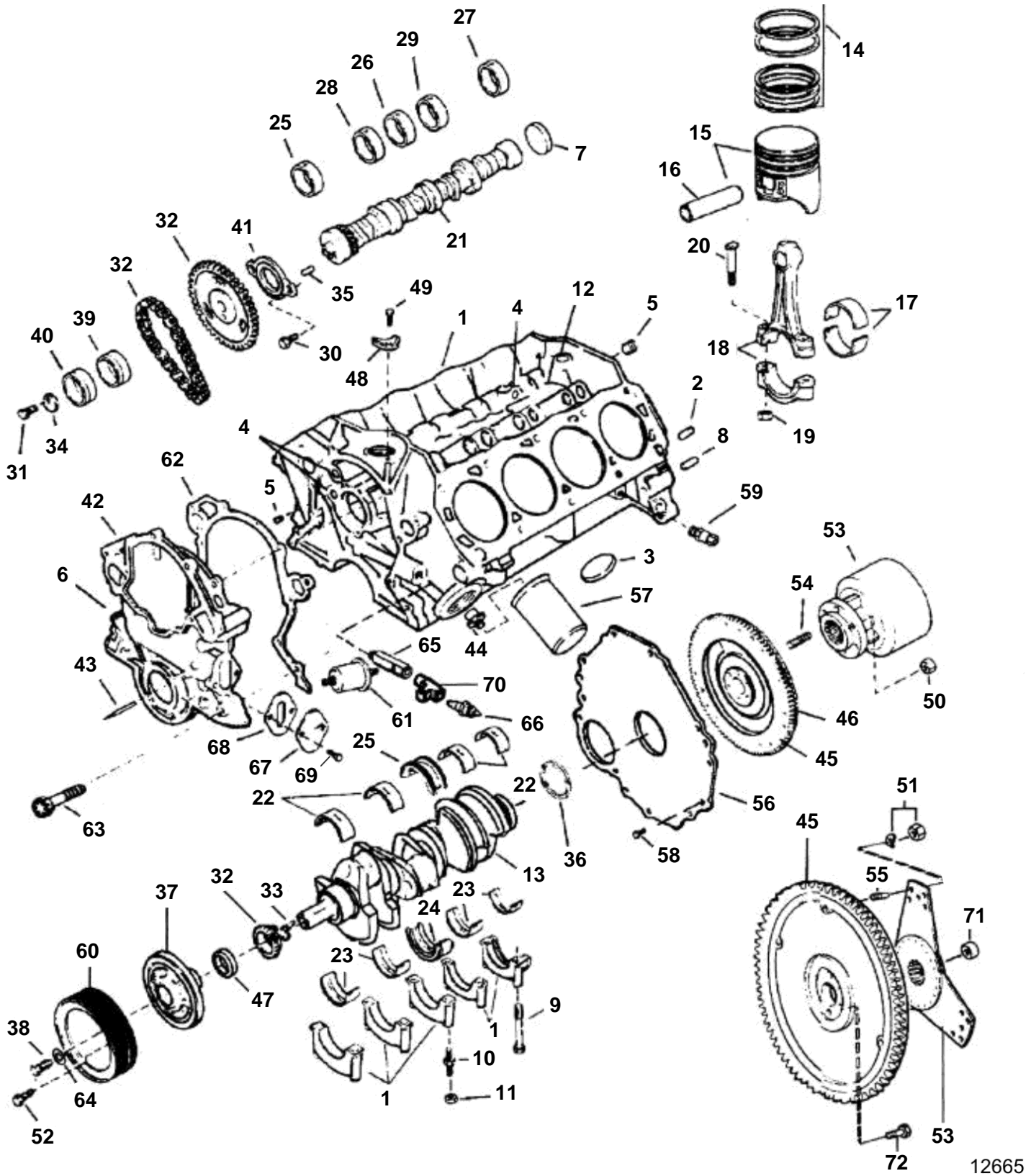

## 5.8FIPNCACE, 5.8FIPNCBCE, 5.8FIPNCMCE, 5.8FIPNCSCE, 5.8FSIINCC, 5.8FSIINCS, 5.8FSIPNCACE, 5.8FSIPNCD, 5.8FSIPNCS

REF	PART NO.	QTY	DESCRIPTION	SEE SEC.	NOTES
1	3855167	1	Longblock		5.8Fi
			· Bulletin P-21-0-7	P-21-0-7-EN	Longblock guidelines, 5.0L, 5.8L, Ford
1	3855168	1	Longblock		5.8FSi
			· Bulletin P-21-0-7	P-21-0-7-EN	Longblock guidelines, 5.0L, 5.8L, Ford
2	3853007	4	Guide sleeve, Cylinder head to block		
3		6	Cap plug, Core hole		
4	3853008	2	Cap plug, Oil passage		
5		6	Plug, Oil gallery		
6	3853008	2	Cap plug, Indicator hole		
7		1	Cap plug, Rear, cam, standard		
	3853009	1	Cap plug, Rear cam, 0.060 in. OS		
8		1	Locating pin, Adapter hsg to block		
9		9	Bolt, Main bearing cap		
10		1	Stud, Main bearing cap		
11	3853026	1	Nut, Main bearing cap		
12		1	Cap plug, Rear hole in block		
13	3852793	1	Crankshaft, 235 model		
14	3856753	4	Piston ring kit		Contains Rings for 2 Pistons
		1	Piston ring kit, 0.020 in. OS		Contains Rings for 2 Pistons
15	3856752	1	Piston, Standard		
	3856751	1	Piston, 0.020 in. OS		
16	3852773	8	Piston pin, Piston, standard		
17		16	Bearing, Connecting rod, standard		
	3853081	1	Bearing, Connecting rod, 0.010 in. US		
		1	Bearing, Connecting rod, 0.030 in. US		
		1	Bearing, Connecting rod, 0.020 in. US		
18		8	Connecting rod		
19	3852675	16	Nut, Connecting rod		
20		16	Bolt, Connecting rod		
21	3853770	1	Camshaft, Fi		
	3855272	1	Camshaft, FSi		
22		8	Bearing, Main, standard, upper		
			· Bulletin P-21-6-1	P-21-6-1-EN	Main Bearing Kits, 5.0 and 5.8L Ford
22		1	Bearing, Main, 0.010 in. US, upper		
		1	Bearing, Main, 0.020 in. US, upper		
		1	Bearing, Main, 0.030 in. US, upper		
23		8	Bearing, Main, standard, lower		
			· Bulletin P-21-6-1	P-21-6-1-EN	Main Bearing Kits, 5.0 and 5.8L Ford
23		1	Bearing, Main, 0.020 in. US, lower		
		1	Bearing, Main, 0.030 in. US, lower		
		1	Bearing, Main, 0.10 US, lower		
24		2	Bearing, Main, center, standard		
			· Bulletin P-21-6-1	P-21-6-1-EN	Main Bearing Kits, 5.0 and 5.8L Ford
24		1	Bearing, Main, center, 0.010 in. US		
		1	Bearing, Main, center, 0.020 in. US		
		1	Bearing, Main, center, 0.030 in. US		
25		1	Bearing, Camshaft, front		
		1	Bearing, Front, 0.015 in. US		
26	3852781	1	Bearing, Camshaft, center		
		1	Bearing, Center, 0.015 in. US		
27	3852782	1	Bearing, Camshaft, rear		
	3853020	1	Bearing, Rear, 0.015 in. US		
28	3852783	1	Bearing, Camshaft		
		1	Bearing, Front intermed, 0.015 in. US		
29	3852784	1	Bearing, Camshaft, rear intermediate		
		1	Bearing, 0.015 in. US		
30	3852788	2	Bolt, Camshaft, thrust plate		
31		1	Bolt, Camshaft sprocket		
32	3856741	1	Chain, set		double roller
	3853903	1	· Chain		not sold separately
	3852785	1	· Sprocket, camshaft		not sold separately
	3852794	1	· Sprocket, crankshaft		not sold separately
33		1	Woodruff key, Sprocket to crankshaft		

5.8FIPNCACE, 5.8FIPNCBCE, 5.8FIPNCMCE, 5.8FIPNCSCE, 5.8FSIINCC, 5.8FSIINCS, 5.8FSIPNCACE, 5.8FSIPNCD, 5.8FSIPNCS

REF	PART NO.	QTY	DESCRIPTION	SEE SEC.	NOTES
34	3852790	1	Washer, Camshaft sprocket		
35	3852786	1	Locating pin, Camshaft sprocket		
36	3852806	1	Sealing, Crankshaft, rear		
37		1	Vibration damper, Crankshaft		4 holes
38	3853021	1	Bolt, Crankshaft damper		
39		1	Eccentric, Fuel pump, outer		
40	3852789	1	Guide, Fuel pump, inner		
41	3852787	1	Plate, Camshaft thrust, standard		
		1	Plate, 0.002 in. OS, camshaft thrust		
		1	Plate, 0.004 in. OS, camshaft thrust		
42	3853893	1	Timing gear casing, Cylinder front		
43	3852768	1	Turn signal, timing		
44	3853035	1	Insert, Oil filter		
45		1	Flywheel		
46		1	Gear ring, Flywheel		
47	3853827	1	Sealing, Front cover		
48	3853078	1	Clamp, Distributor		
49	3853077	1	Screw, Clamp, distributor		
50	3853273	6	Nut, Flywheel & coupler to crankshaft		SX
51	3854496	6	Washer, Dampener to flywheel		290 DP
	3854497	6	Lock nut, Damper to flywheel		
52	3853557	4	Screw, Pulley to crankshaft		
53	3853862	1	Clutch, Flywheel		SX, DP-S
		1	Oscillation damper, Flywheel		290 DP
54	3853274	6	Stud, Flywheel & coupler to crankshaft		SX, DP-S
55		6	Stud, Dampener to flywheel		290 DP
56	3853003	1	Cardboard tube		
57	835779	1	Oil		
58	3852421	5	Screw, Flywheel cover to hsg		
59	3854494	2	Drain cock, Engine water drain		
60		1	V-belt pulley, Crankshaft		4 holes
61	3853800	1	Oil pressure sensor		
	872064	1	Pressure sensor		
62	3852767	1	Gasket, Front cover		
63		1	Bolt, Front cover, 2 in		
		1	Bolt, Front cover, 1-3/4 in		
		1	Bolt, Front cover, 2-1/4 in		
	3853014	1	Bolt, Front cover, 2-1/2 in		
64	3853075	1	Washer, Crankshaft damper		
65	3853640	1	Fitting, Oil pressure switch & sender		
66	3854181	1	Breaker		
67	3854284	1	Cardboard tube, Fuel pump opening		
68	3852600	1	Gasket, Fuel pump opening		
69	3853266	1	Screw, Fuel pump cover		
70	3852503	1	Elbow, Street, oil press SW to tee		
71	3850412	1	Bushing, Pilot, Crankshaft		DP
72	3855532	8	Screw, Flywheel to Crankshaft		290 DP