

5.7GLPLKA, 5.7GLPLKD, 5.7GLPLKE, 5.7GLPLKR, 5.7GSPLKD, 5.7GSPLKE

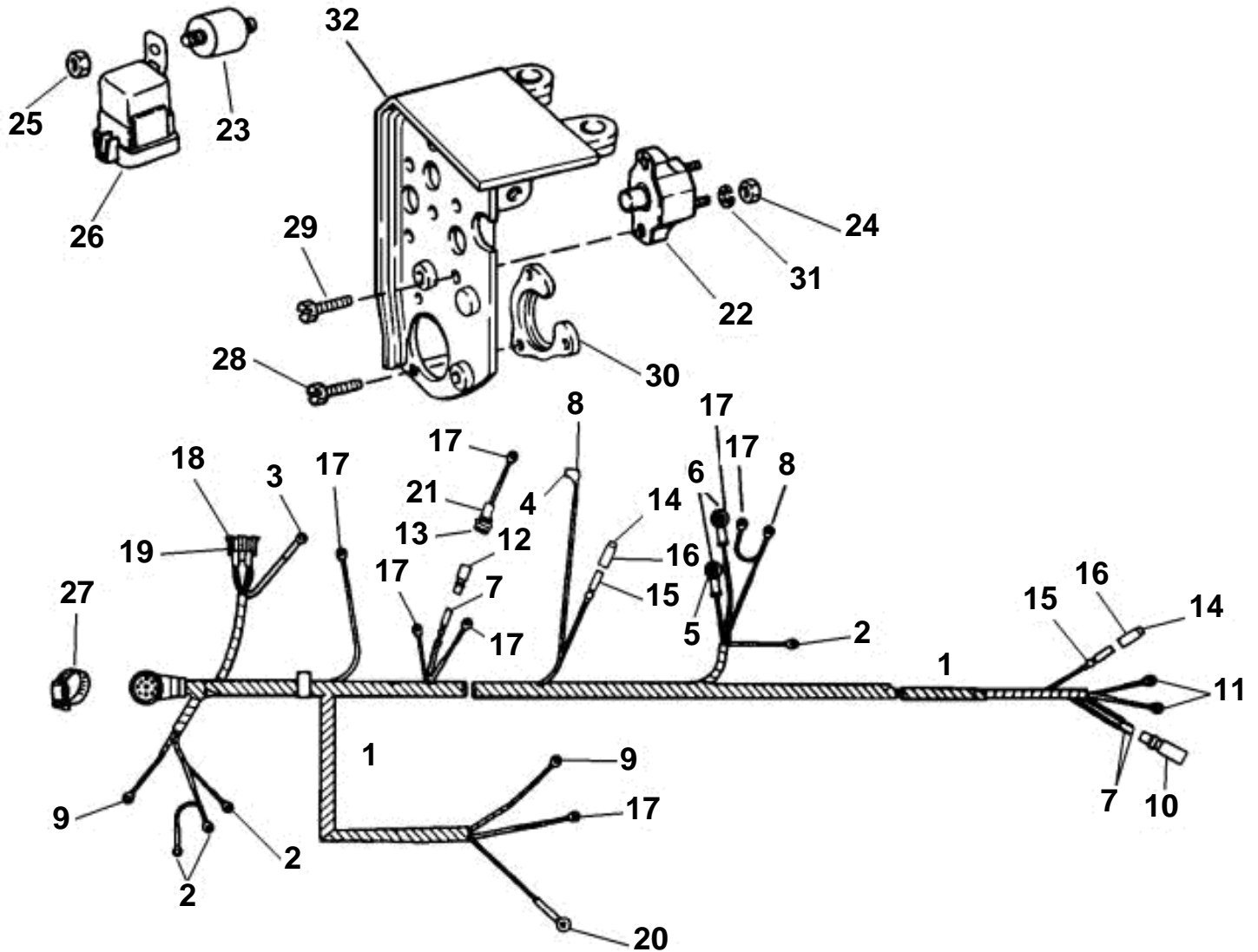

5.7GLPLKA, 5.7GLPLKD, 5.7GLPLKE, 5.7GLPLKR, 5.7GSPLKD, 5.7GSPLKE

REF	PART NO.	QTY	DESCRIPTION	NOTES
1	3856190	1	Wiring harness	
2	3852245	4	• Terminal	
3	3852107	1	• Terminal, Bracket ground	
4	3852084	1	• Terminal, Choke	
5	3852038	1	• Terminal, Alternator output	
6	3852130	2	• Rubber cap, Alternator	
7	3852229	2	• Terminal, Pin	
8	3853320	1	• Cardboard tube, Terminal	
9		3	• Terminal	
10	3853565	1	• Connector, 2-pin	
11	3850998	2	• Terminal, Ground	
12		1	• Connector, Socket	
13	3852257	1	• Terminal	
14		2	• Cardboard tube, Socket	
15		2	• Terminal	
16	3852244	2	• Terminal, Socket	
17	3852233	2	• Terminal	
18	3852254	4	• Terminal, Starter relay	
19	3854192	1	• Relay	
20	3852037	1	• Terminal, Starter	
21	3850991	1	• Connector	
22	3854164	2	Automatic fuse, 50A	
23	3850234	1	Rubber cushion, Starter relay	
24	3852064	2	Nut, Circuit breaker	
25	3852118	1	Nut, Starter motor to bracket	
26	3854138	1	Relay, Starter motor	
27	3853786	1	Hose clamp, Instrument cable	
28	3852208	3	Screw, Cable retainer	
29	3853620	2	Hexagon screw, Circuit breaker to bracket	Engine
30	3852825	1	Retainer, Engine cable	
31	3852001	2	Spring washer, Circuit breaker terminals	
32	3856186	1	Bracket, Circuit breaker & engine cable	