

5.8FIIHUBCE, 5.8FIIHUECE, 5.8FIPHUBCE, 5.8FIPHUCCE, 5.8FIPHUECE, 5.8FIPHURCE, 5.8FIPHUSCE, 5.8FSIPHUBCE, 5.8FSIPHUCCE, 5.8FSIPHUECE, 5.8FSIPHURCE, 5.8FSIPHUSCE

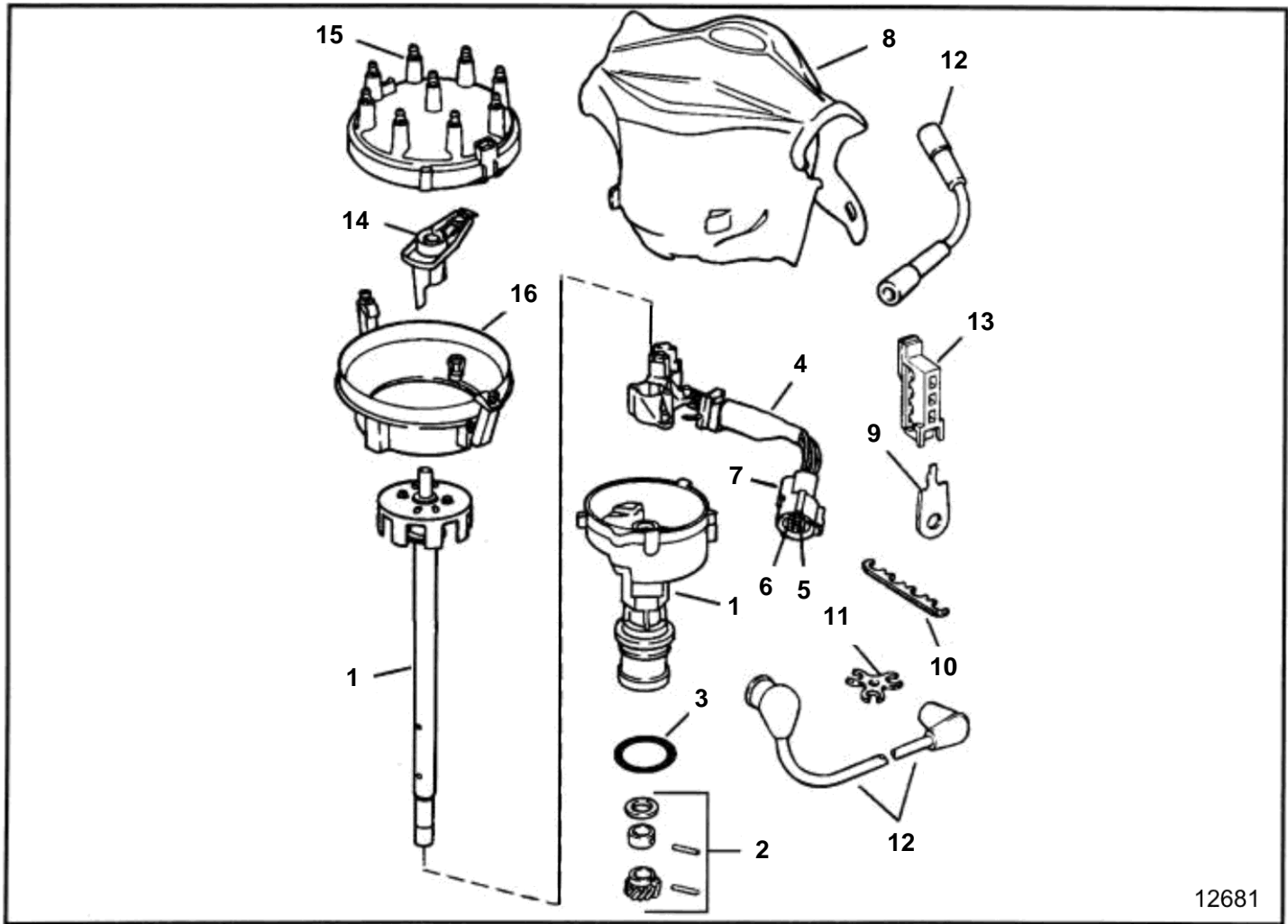

12681

5.8FIIHUBCE, 5.8FIIHUECE, 5.8FIPHUBCE, 5.8FIPHUCCE, 5.8FIPHUECE, 5.8FIPHURCE, 5.8FIPHUSCE, 5.8FSIPHUBCE,
5.8FSIPHUCCE, 5.8FSIPHUECE, 5.8FSIPHURCE, 5.8FSIPHUSCE

REF	PART NO.	QTY	DESCRIPTION	NOTES
1	3854176	1	Distributor, complete	
		1	· Shaft	not sold separately
2		1	· Gear	
3		1	· O-ring	
4	3854224	1	· Stator	
5		6	· · Terminal	
6		1	· · Retainer	
7		1	· · Connector	
8	3853585	1	Shield, Distributor	
9	3852826	1	Bracket, Lead retainer to lift bracket	Front, stbd
10	3852491	2	Retainer, 4 wire ignition leads	
11	3852492	2	· Retainer, 3 wire ignition leads	
12		1	Ignition cable kit, Spark plug wire	
13	3852619	1	Retainer, Front ignition leads, 4 wire	Port
14		1	Rotor	
15	3854217	1	Cardboard tube, Distributor	
16		1	Adapter	