

D4-180I-B, D4-180I-C, D4-180I-D, D4-210A-A, D4-210A-B, D4-210I-A, D4-210I-B, D4-225A-B, D4-225A-C, D4-225A-D, D4-225I-B, D4-225I-C, D4-225I-D, D4-260A-A, D4-260A-B, D4-260A-C, D4-260A-D, D4-260D-B, D4-260D-C, D4-260D-D, D4-260I-A, D4-260I-B, D4-260I-C, D4-260I-D, D4-300A-A, D4-300A-C, D4-300A-D, D4-300D-A, D4-300D-C, D4-300D-D, D4-300I-A, D4-300I-C, D4-300I-D

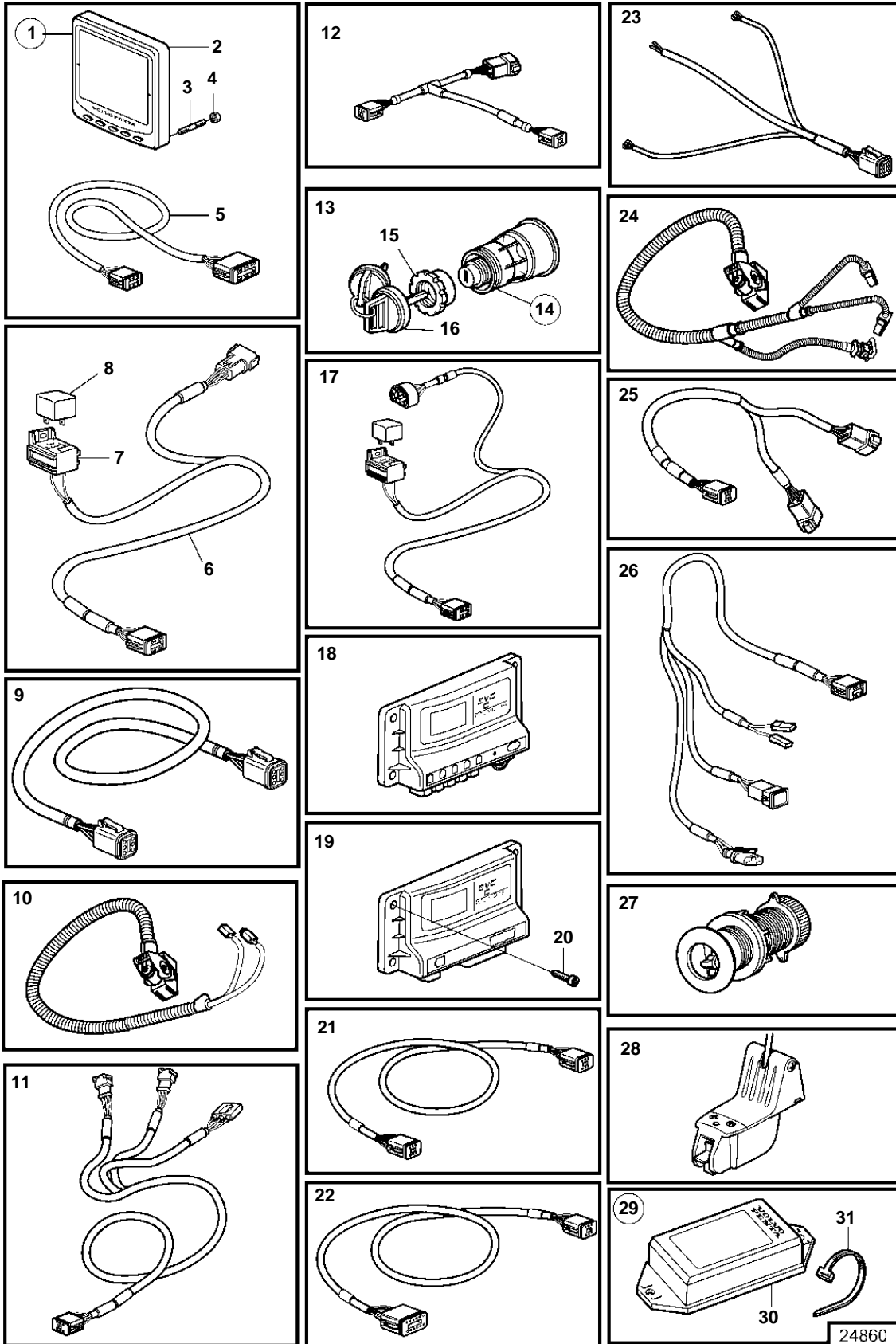

D4-180I-B, D4-180I-C, D4-180I-D, D4-210A-A, D4-210A-B, D4-210I-A, D4-210I-B, D4-225A-B, D4-225A-C, D4-225A-D, D4-225I-B, D4-225I-C, D4-225I-D, D4-260A-A, D4-260A-B, D4-260A-C, D4-260A-D, D4-260D-B, D4-260D-C, D4-260D-D, D4-260I-A, D4-260I-B, D4-260I-C, D4-260I-D, D4-300A-A, D4-300A-C, D4-300A-D, D4-300D-A, D4-300D-C, D4-300D-D, D4-300I-A, D4-300I-C, D4-300I-D

REF	PART NO.	QTY	DESCRIPTION	SEE SEC.	NOTES
1	21352262	1	Display		
2		1	• Display		
3	830928	4	• Stud		
4	830930	4	• Nut		
5	3588207	1	• Cable kit		
6	881786	1	Cable kit		
7	977184	1	Housing		
8	873765	1	Relay		12V
	20374662	1	Relay		24V
9	3842733	1	Extension cable\verl		L=3.0m
	3842734	1	Extension cable\verl		L=5.0m
	3842735	1	Extension cable\verl		L=7.0m
	3842736	1	Extension cable\verl		L=9.0m
	3842737	1	Extension cable\verl		L=11.0m
	21172469	1	Extension cable\verl		L=20m
	21172470	1	Extension cable\verl		L=40m
	874789	1	Cable kit		PCU-HCU, 6 pole., L=5.0m
	889550	1	Cable		PCU-HCU, 6 pole., L=7.0m
	889551	1	Cable		PCU-HCU, 6 pole., L=9.0m
	889552	1	Cable		PCU-HCU, 6 pole., L=11.0m
	888013	1	Cable		PCU-HCU, 6 pole., L=13.0m
10	40005754	1	Wiring harness		Engine-PCU cable., L=2.65m
11	874676	1	Cable kit		EVC control lever cable, 6-pole., L=1.5m
12	3588972	1	Cable kit		T-connector bus cable, 6-pole., L=0.5m
13	3587070	1	Starter switch, set		Kit with 2 key switch with identical key.
14	3587071	1	Starter switch		
15	859955	1	• Plastic nut		
16	859953	1	• Key		State key code when ordering.
			• Bulletin 49-30	49-30-EN	Key P/N 859953
17	888004	1	Cable, starter switch		
18	21321153	X	Control unit, not programmed		HCU. Software ordered separately or downloaded with VODIA.
	3586261	X	Software		Warehouse programming. This p/n can not be ordered, but will be used for invoicing.
	3586259	X	Software		Vodia-programming. This p/n can not be ordered, but will be used for invoicing.
	21172467		Control unit		XCU
19	21370489	X	Kit, not programmed		PCU. Software ordered separately or downloaded with VODIA.
			• Bulletin P-28-4-14	P-28-4-14-EN	Changed Control units for EVC-C2 Engines
			• Bulletin P-28-4-15	P-28-4-15-EN	Campaign Kits, EVC
19	3586267	X	Software		Warehouse programming. This p/n can not be ordered, but will be used for invoicing.
	3586266	X	Software		Vodia-programming. This p/n can not be ordered, but will be used for invoicing.
20	976104	4	Flange screw		
21	3886666	1	Cable, synchronizing		Synchronizing cabel for twin installation. 6 pole., L=1.5m
	21166002	1	Wiring harness		L=7m
	21166003	1	Wiring harness		L=9m
	21166004	1	Wiring harness		L=13m
22	3885343	1	Wiring harness		Triple and quadruple installation.
23	3807229	1	Wiring harness, fuel		
24	40005753	1	Wiring harness		
25	3588206	1	Cable kit, y-split		For connecting extra equipment to MULTILINK
26	3808852	1	Cable kit, instruments, panels		
27	3587054	1	Kit		
28	3587055	1	Kit		
29		1	Converter		
30		1	• Converter		
31	948211	2	• Cable tie		