

COMMON

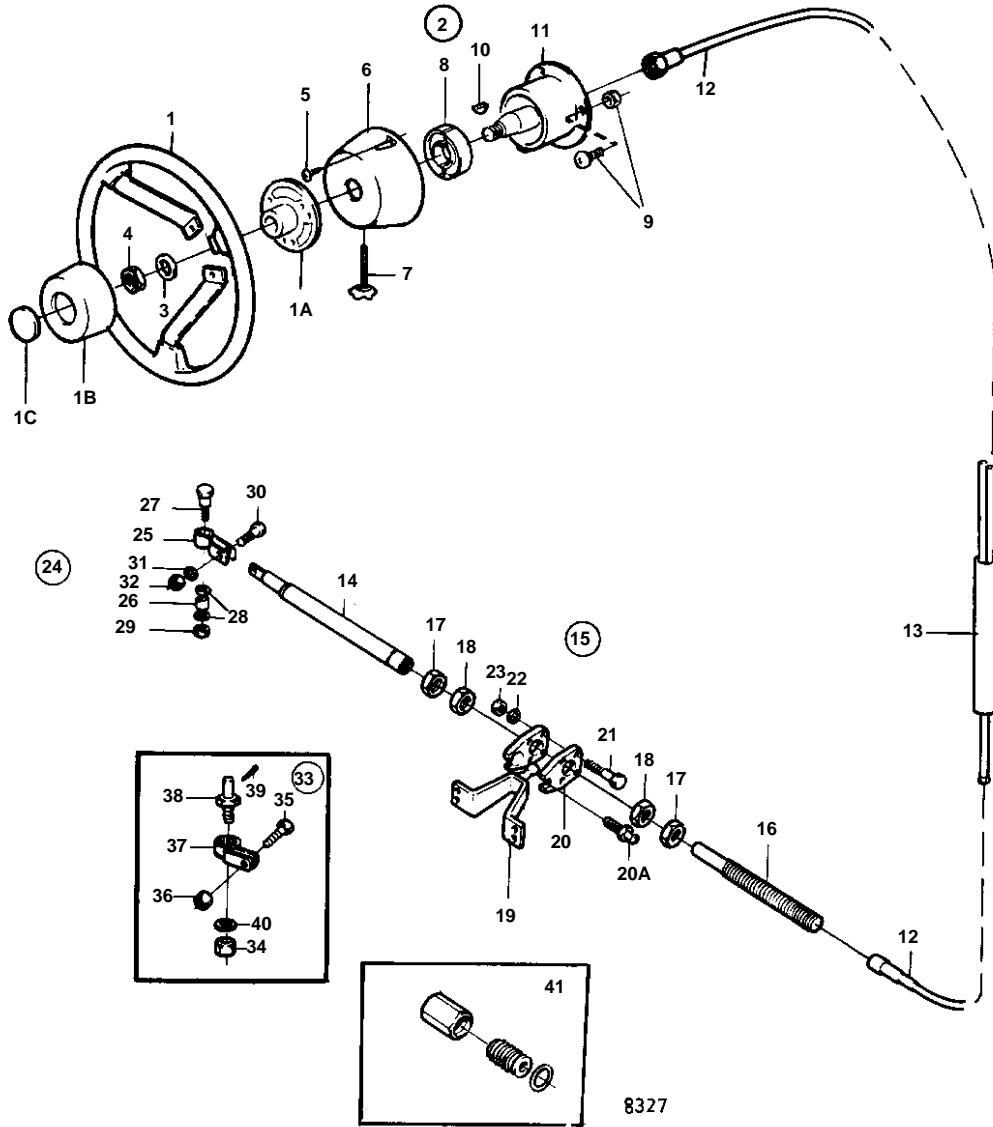

COMMON

REF	PART NO.	QTY	DESCRIPTION		NOTES
1	850936	1	Steering wheel		
1A	850937	1	· Steering wheel hub		
1B	828943	1	· Steering wheel pad		
1C	850938	1	· Steering wh emblem		
2	853182	1	Mounting kit	IK	90%Z9
	1140023	1	Mounting kit	IK	90%Z9 BLACK
	853183	1	Mounting kit	IK	70%Z9
	1140024	1	Mounting kit	IK	70%Z9 BLACK
3		1	· WASHER	IK	
4		1	· NUT	IK	
5		2	· SCREW	IK	
6		1	· COVER	IK	
7		1	· BRAKE SCREW	IK	
8		1	· BRAKE	IK	
9		4	· SCREW AND NUT	IK	
10		1	· KEY	IK	
11	853181	1	Steering box		
12	828886	1	Steering cable		L = 2000 MM
	828887	1	Steering cable		L = 2250 MM
	828888	1	Steering cable		L = 2500 MM
	828889	1	Steering cable		L = 2750 MM
	853185	X	Steering cable		L = 3000 MM
	853186	X	Steering cable		L = 3250 MM
	853187	X	Steering cable		L = 3500 MM
	853188	X	Steering cable		L = 3750 MM
	853189	X	Steering cable		L = 4000 MM
	853190	X	Steering cable		L = 4250 MM
	853191	X	Steering cable		L = 4500 MM
	853192	X	Steering cable		L = 4750 MM
	853193	X	Steering cable		L = 5000 MM
	828863	X	Steering cable		L = 5250 MM
	853194	X	Steering cable		L = 5500 MM
	828864	X	Steering cable		L = 5750 MM
	853195	X	Steering cable		L = 6000 MM
	828865	X	Steering cable		L = 6250 MM
	853196	X	Steering cable		L = 6500 MM
	828866	X	Steering cable		L = 6750 MM
	853197	X	Steering cable		L = 7000 MM
	853286	X	Steering cable		L = 7500 MM
	853287	X	Steering cable		L = 8000 MM
	853288	X	Steering cable		L = 8500 MM
	853289	X	Steering cable		L = 9000 MM
	828867	X	Steering cable		L = 9750 MM
	828868	X	Steering cable		L = 10500 MM
	828869	X	Steering cable		L = 11250 MM
	828874	X	Steering cable		L = 12000 MM
13	853291	1	Ds unit		ONLY FOR FLYING BRIDGE
14	851059	1	Steering cylinder		FOR PORT MOUNTING.
	851147	1	Steering cylinder		FOR STARBOARD MOUNTING.
15	853290	1	Stern attachment		
16	850771	1	· Anchorage		
17	850778	2	· Nut		
18	853306	2	· Nut		
19	851093	1	· Bracket		
20	851077	2	· Anchorage		EARLY TYPE
	828854	1	· Anchorage		LATE TYPE
	828857	1	· Anchorage		LATE TYPE
20A	951739	1	· Lubricating nipple		FOR 828857
21	940101	4	· Screw		EARLY TYPE
	940101	2	· Screw		LATE TYPE
22	941906	4	· Spring washer		EARLY TYPE
	941906	2	· Spring washer		LATE TYPE
23	963105	4	· Nut		EARLY TYPE

COMMON

REF	PART NO.	QTY	DESCRIPTION	NOTES
23	963105	2	• Nut	LATE TYPE
24	851122	1	• Ball joint kit	REPL BY 828924
25		1	• • BRACKET	
26	851121	1	• • Sleeve	
27	851117	1	• • Shoulder screw	
28	942551	2	• • Washer	
29	966172	1	• • Nut	
30	851118	1	• • Shoulder screw	
31	941670	1	• • Washer	
32	966171	1	• • Lock nut	
33	853214	X	Adapter	FOR FOREIGN STEERING CABLES.
34	828924	1	• Ball joint kit	
35	851118	1	• Shoulder screw	
36	966171	1	• Lock nut	
37		1	• BRACKET	
38		1	• SPLIT PIN SCREW	
39	967707	1	• Cotter pin	
40	955897	1	• Washer	
41	963119	1	• Nut	