

TAMD120A

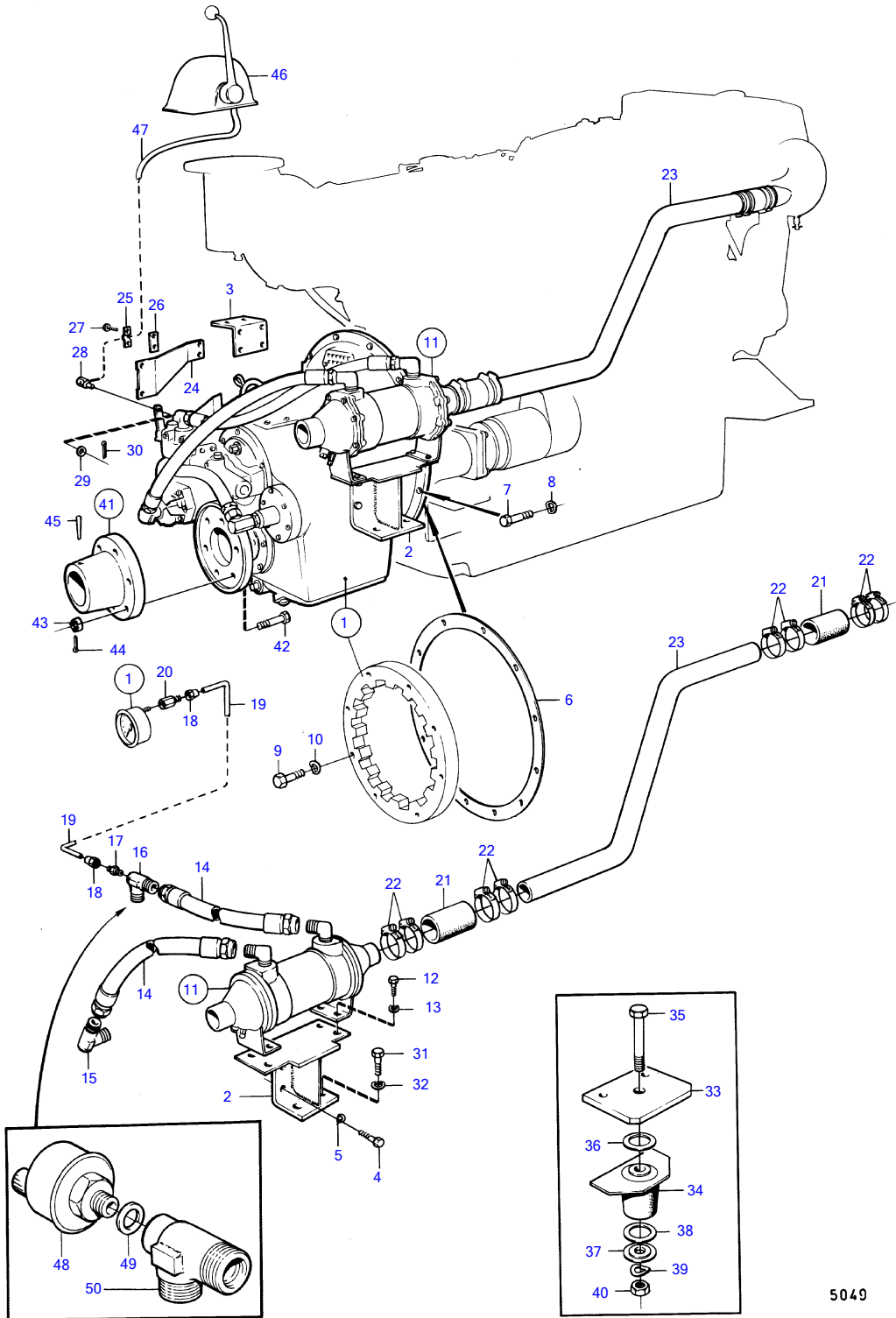

5049

TAMD120A

REF	PART NO.	QTY	DESCRIPTION	SEE SEC.	NOTES
1		1	rev. gear, ratio 1,5:1		
		1	rev. gear, ratio 2:1		MG509
		1	rev. gear, ratio 3:1		MG509
			• components		
2	(837062)	1	Bracket		Obsolete part
3	(837060)	1	Bracket		Obsolete part
4	955561	8	Hexagon screw		
5	940280	8	Spring washer		
6	800314	1	Gasket		
7	940134	12	Hexagon screw		
8	941909	12	Spring washer		
9	955561	8	Hexagon screw		
10	940280	8	Spring washer		
11	837099	1	Oil cooler		
			•	14618	
12	940098	4	Hexagon screw		
13	942336	4	Spring washer		
14	(837119)	1	Hose		L=600mm, Obsolete part
	837095	1	Oil hose		L=695mm
15	837063	1	Elbow union		
16	(837064)	1	Elbow union		Obsolete part
17	(954334)	1	Nipple		Obsolete part
18	954320	2	Fitting nut		
19	(954303)	X	Tube		L=5000mm, Obsolete part
20	(836064)	1	Nipple		Obsolete part
21	943372	X	Rubber hose		L=150mm (952980)
22	943480	8	Hose clamp		
23	(837229)	1	Coolant pipe		Obsolete part
24	(836117)	1	Bracket		Obsolete part
25	21471054	1	Bracket		
26	819068	1	Washer		
27	950021	2	Cross recessed screw		
28	(813674)	1	Cube		Obsolete part
29	940191	1	Washer		
30	907824	1	Split pin		
31	955589	4	Hexagon screw		
32	941912	4	Spring washer		
33	(824374)	2	Intermediate plate		Obsolete part
34	836961	2	Rubber cushion		
35	959827	2	Hexagon screw		
36	836325	2	Washer		
37	836962	2	Stop washer		
38	836963	2	Rubber washer		
39	941912	2	Spring washer		
40	955829	2	Hexagon nut		
41	(837055)	1	Clutch flange		Obsolete part
42	(955750)	6	Hexagon screw		Obsolete part
43	955887	6	Castle nut		
44	907861	6	Split pin		
45	17178	2	Taper pin		
46			control		See group 9
47			control cable		See group 9
48	837781	1	Oil pressure sensor		See group 3
49	957181	1	Gasket		See group 3
50	842717	1	Elbow union		