

TAMD120A

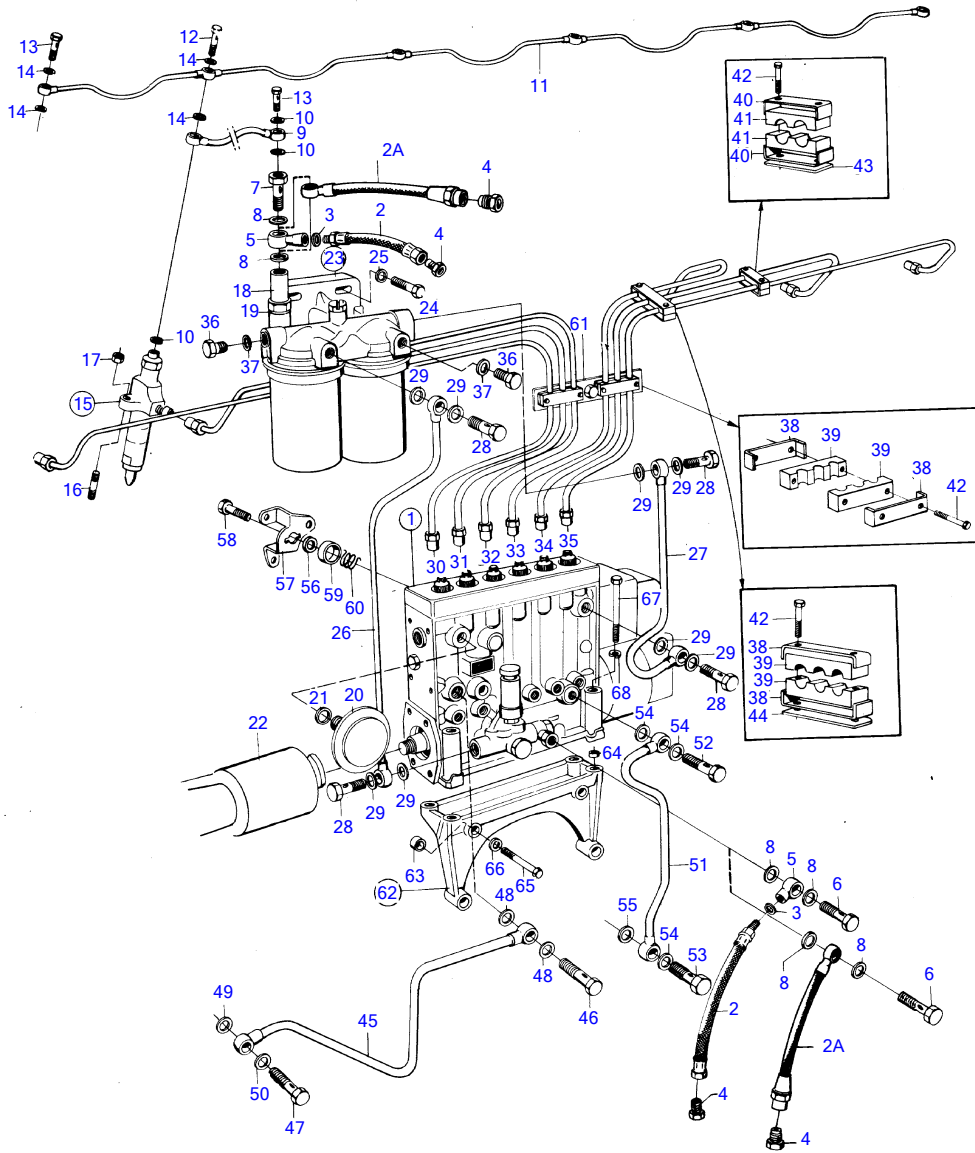

5857

TAMD120A

REF	PART NO.	QTY	DESCRIPTION	SEE SEC.	NOTES
1		1			Repl by 843979
	(843979)	1	Injection pump		Obsolete part
2		2	fuel hose		Std Repl by 837363
		2	fuel hose		Spec VER Repl by 837364
2A	845372	2	Fuel hose		(837363)
2	845372	2	Fuel hose		(837364)
3	11998	2	Gasket		
4	22753	2	Nipple		
5	(26016)	2	Banjo nipple		Obsolete part
6	25167	1	Hollow screw		
7	16496	1	Hollow screw		
8	18671	4	Gasket		
9	822592	1	Leak-off line		
10	957171	3	Gasket		
11	822564	1	Leak-off line		
12	74034	1	Hollow screw		
13	74033	6	Hollow screw		
14	957171	12	Gasket		
15	837097	6	Injector	14538	
	3803249	6	Injector, exch	14538	
16	941928	12	Stud		
17	417110	12	Nut		
18	35096	1	Overflow valve		
	35096	2	Overflow valve		Included in repair kit 6210761.
19	18671	1	Gasket		
	18671	2	Gasket		Included in repair kit 6210761.
20	466398	1	Pressure equalizer		
21	18671	1	Gasket		
22					
23	241672	1	Filter housing		Replaced by 77989.
	471172	1	Filter housing		
24	940162	2	Hexagon screw		
25	942336	2	Spring washer		
26	(822590)	1	Fuel pipe		Obsolete part
27	822591	1	Fuel pipe		
28	25167	4	Hollow screw		
29	18671	8	Gasket		
30	823781	1	Delivery pipe		Cyl. no. 1
31	823782	1	Delivery pipe		Cyl. no. 2
32	(823783)	1	Delivery pipe		Cyl. no. 3, Obsolete part
33	823784	1	Delivery pipe		Cyl. no. 4
34	823785	1	Delivery pipe		Cyl. no. 5
35	823786	1	Delivery pipe		Cyl. no. 6
36	960630	2	Plug		
37	18671	2	Gasket		
38	414346	8	Attaching clamp		
39	414347	8	Attaching clamp		
40	414344	2	Attaching clamp		
41	414345	2	Attaching clamp		
42	955247	10	Hexagon screw		
43	414736	1	Nut plate		
44	414735	2	Nut plate		
45	423393	1	Pressure oil line		
46	48634	1	Hollow screw		
47	942081	1	Hollow screw		MO-18662/XXXX
	837709	1	Hollow screw		MO18663/XXXX-
48	957173	2	Gasket		
49	18666	1	Gasket		
50	11994	1	Gasket		
51	422246	1	Return pipe		
52	25167	1	Hollow screw		
53	954394	1	Hollow screw		
54	18671	3	Gasket		

TAMD120A

REF	PART NO.	QTY	DESCRIPTION	SEE SEC.	NOTES
55	11998	1	Gasket		
56	941906	1	Spring washer		See group 2D
57	821134	1	Lever		See group 2D
58	955270	1	Hexagon screw		See group 2D
61	822546	1	Bracket		See group 2B
62	468558	1	Bracket		
63	(423161)	2	Guide sleeve		Obsolete part
64	417588	1	Guide sleeve		
65	955566	4	Hexagon screw		
66	940280	4	Spring washer		
67	940156	4	Hexagon screw		
68	190509	4	Washer		