

MD120A

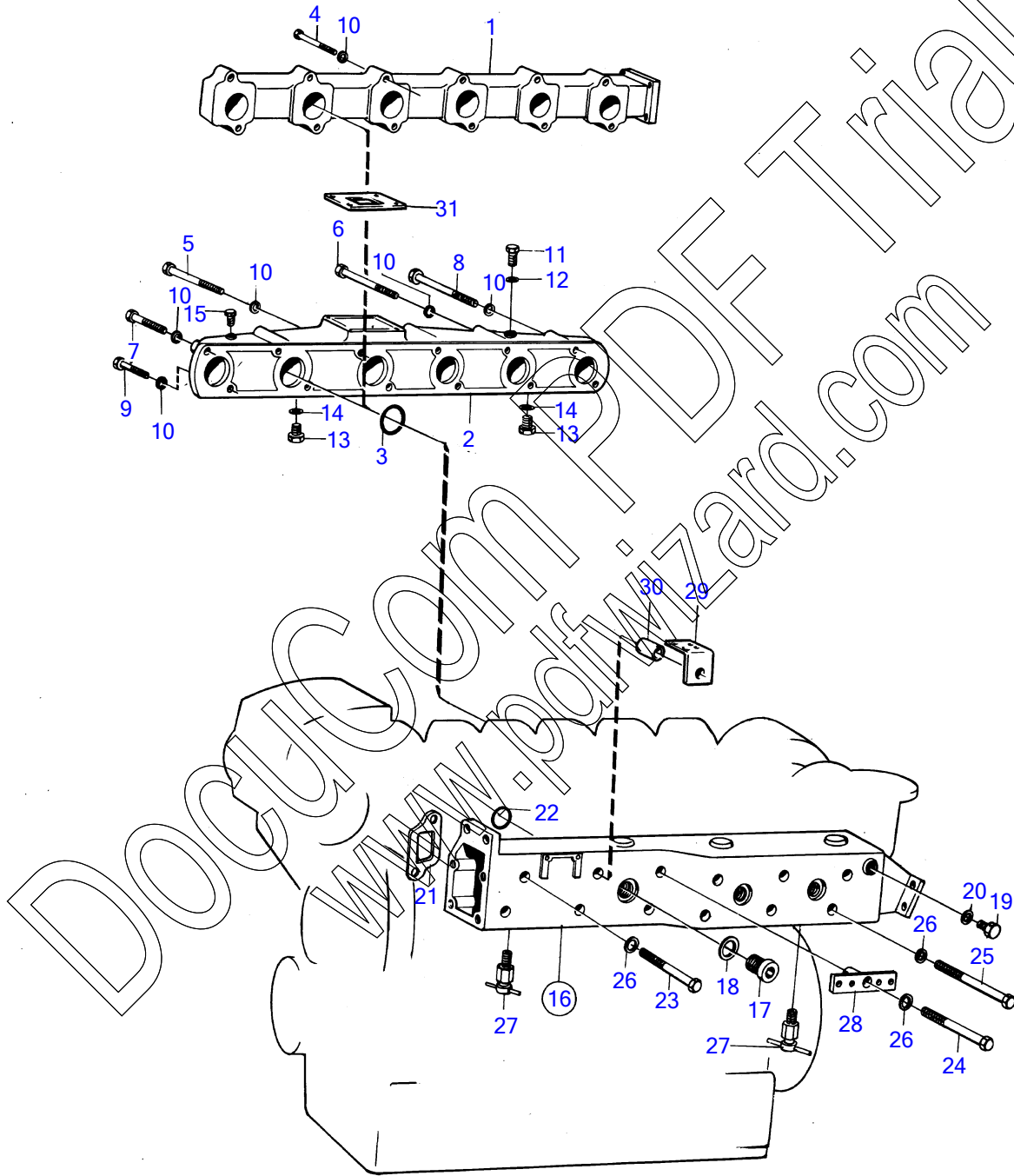

5399

MD120A

| REF | PART NO. | QTY | DESCRIPTION | SEE SEC. | NOTES |
|-----|----------|-----|---------------|----------------|---|
| 1 | 820831 | 1 | Inlet pipe | | |
| 3 | 423174 | 6 | Rubber ring | | |
| 4 | 955529 | 12 | Hexagon screw | | |
| 8 | | | | 14495 | |
| 10 | 941907 | 12 | Spring washer | | |
| 16 | 824128 | 1 | Exhaust pipe | 14502 14503 | |
| 17 | 467367 | 6 | • Plug | | (467649) |
| 18 | 469328 | 6 | • Gasket | | |
| 19 | (191086) | 1 | • Plug | | Obsolete part |
| 20 | 190957 | 1 | • Gasket | | |
| 21 | 468647 | 6 | Gasket | | |
| 22 | 822575 | 6 | Sealing ring | | |
| | | | • | 14502 14503 | |
| 23 | 942547 | 5 | Hexagon screw | | |
| 24 | 192058 | 1 | Hexagon screw | | Spec. 867054, 867057 MO-XXXXX/6621, 867132. D70BK alt., L=152mm |
| 25 | 941252 | 6 | Hexagon screw | | L=171mm |
| 26 | 942336 | 12 | Spring washer | | |
| 27 | 82745 | 2 | Shut-off cock | | |
| 28 | 822546 | 1 | Bracket | | See group 2C |

MD120A

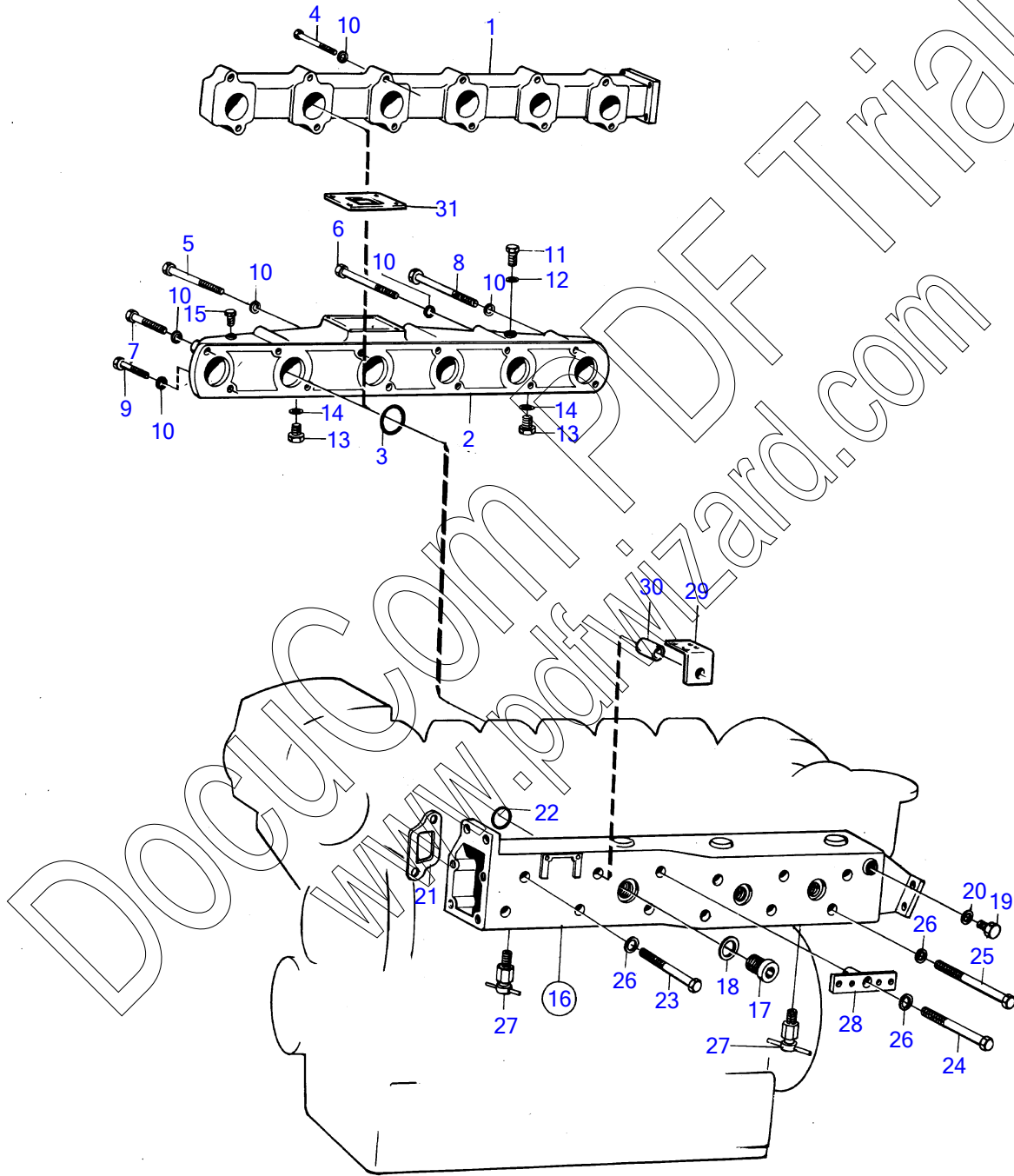

5399

MD120A

| REF | PART NO. | QTY | DESCRIPTION | SEE SEC. | NOTES |
|-----|----------|-----|---------------|----------------|---|
| 1 | 820831 | 1 | Inlet pipe | | |
| 3 | 423174 | 6 | Rubber ring | | |
| 4 | 955529 | 12 | Hexagon screw | | |
| 8 | | | | 14495 | |
| 10 | 941907 | 12 | Spring washer | | |
| 16 | 824128 | 1 | Exhaust pipe | 14502 14503 | |
| 17 | 467367 | 6 | • Plug | | (467649) |
| 18 | 469328 | 6 | • Gasket | | |
| 19 | (191086) | 1 | • Plug | | Obsolete part |
| 20 | 190957 | 1 | • Gasket | | |
| 21 | 468647 | 6 | Gasket | | |
| 22 | 822575 | 6 | Sealing ring | | |
| | | | • | 14502 14503 | |
| 23 | 942547 | 5 | Hexagon screw | | |
| 24 | 192058 | 1 | Hexagon screw | | Spec. 867054, 867057 MO-XXXXX/6621, 867132. D70BK alt., L=152mm |
| 25 | 941252 | 6 | Hexagon screw | | L=171mm |
| 26 | 942336 | 12 | Spring washer | | |
| 27 | 82745 | 2 | Shut-off cock | | |
| 28 | 822546 | 1 | Bracket | | See group 2C |