

MD120A

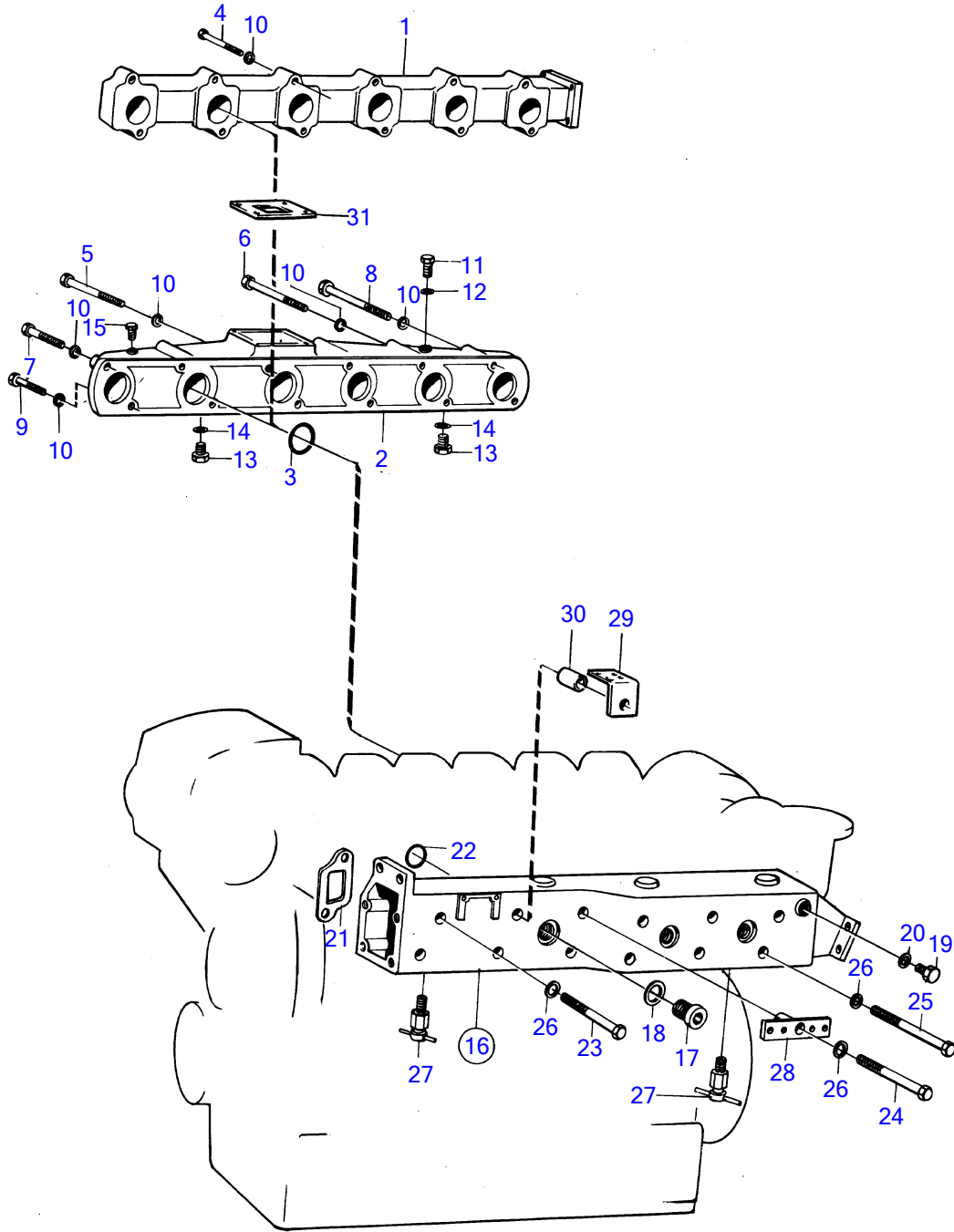

5399

MD120A

| REF | PART NO. | QTY | DESCRIPTION   | SEE SEC.       | NOTES  |
|-----|----------|-----|---------------|----------------|--|
| 1   | 820831   | 1   | Inlet pipe    |                |  |
| 3   | 423174   | 6   | Rubber ring   |                |  |
| 4   | 955529   | 12  | Hexagon screw |                |  |
| 8   |          |     |               | 14495          |  |
| 10  | 941907   | 12  | Spring washer |                |  |
| 16  | 824128   | 1   | Exhaust pipe  | 14502<br>14503 |  |
| 17  | 467367   | 6   | • Plug        |                | (467649)   |
| 18  | 469328   | 6   | • Gasket      |                |  |
| 19  | (191086) | 1   | • Plug        |                | Obsolete part  |
| 20  | 190957   | 1   | • Gasket      |                |  |
| 21  | 468647   | 6   | Gasket        |                |  |
| 22  | 822575   | 6   | Sealing ring  |                |  |
|     |          |     | •             | 14502<br>14503 |  |
| 23  | 942547   | 5   | Hexagon screw |                |  |
| 24  | 192058   | 1   | Hexagon screw |                | Spec. 867054, 867057 MO-XXXXXX/6621, 867132. D70BK alt., L=152mm |
| 25  | 941252   | 6   | Hexagon screw |                | L=171mm  |
| 26  | 942336   | 12  | Spring washer |                |  |
| 27  | 82745    | 2   | Shut-off cock |                |  |
| 28  | 822546   | 1   | Bracket       |                | See group 2C   |