

MD11C

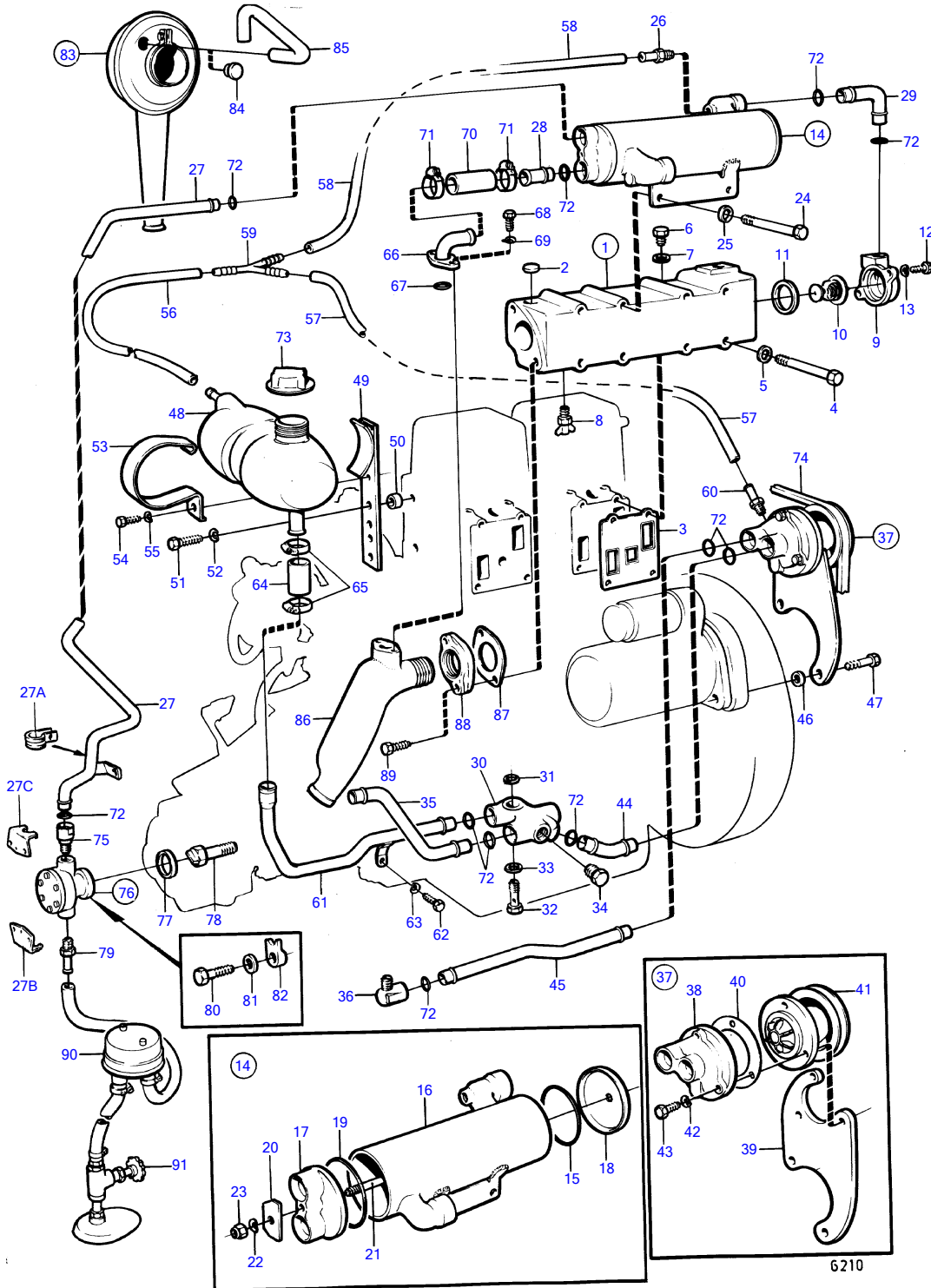

MD11C

REF	PART NO.	QTY	DESCRIPTION	SEE SEC.	NOTES
1	829930	1	Exhaust pipe		
2	192211	3	• Expansion plug		
3	833598	2	Gasket		
4	940129	6	Hexagon screw		
5	955894	6	Washer		
6	960630	1	Plug		FOR EXHAUST MANIFOLD 829930.
7	957178	1	Gasket		FOR EXHAUST MANIFOLD 829930.
8	829592	1	Drain cock		
9	829916	1	Thermostat housing		
10	838501	1	Thermostat		76°C, OBSOLETE PART
11	416033	1	Sealing ring		
12	940132	2	Hexagon screw		
13	941907	2	Spring washer		
14	829911	1	Heat exchanger		
15	829972	1	• Gasket		
16		1	• HOUSING		
17	829987	1	• End plate		OBSOLETE PART
18	829988	1	• End plate		
19	829989	1	• Gasket		
20	829990	1	• Bracket		OBSOLETE PART
21	829991	1	• Bar		
22	941906	3	• Spring washer		
23	963105	3	• Lock nut		
24	100223	2	Hexagon screw		L = 95 MM
25	960141	4	Washer		
26	829917	1	Hose coupling		
27	829937	1	Coolant pipe		
28	829901	1	Connection pipe		
29	829932	1	Coolant pipe		
30	829905	1	Coupling piece		
31	829915	1	Spacer ring		
32	180211	1	Hollow screw		
33	957178	1	Gasket		
34	927963	1	Plug		
35	829933	1	Coolant pipe		
36	829920	1	Insert nipple		
37		1	CIRCULATION PUMP		
38	829847	1	• Pump housing		
39	829899	1	• Bracket		OBSOLETE PART
40	829923	1	• Gasket		
41	829953	1	• Circulation pump		
			Bulletin 43-04	43-04-EN	Circulation Pump
42	941906	3	• Spring washer		
43	955275	3	• Hexagon screw		
44	829935	1	Coolant pipe		
45	829936	1	Coolant pipe		
46	955897	2	Washer		
47	955345	2	Hexagon screw		L = 55 MM
48	1276040	1	Expansion tank		
49	840172	1	Bracket		
50	829653	2	Spacer sleeve		
51	940142	2	Hexagon screw		L = 30 MM
52	941907	2	Spring washer		
53	840171	1	Clamp		
54	956092	1	Cross recessed screw		
55	941906	1	Spring washer		
56	942700	X	Hose		L = 605 MM
57	942700	X	Hose		L = 295 MM
58	942700	X	Hose		L = 40 MM
59	840179	1	Hose coupling		
60	829917	1	Hose coupling		
61	829934	1	Coolant pipe		
62	940280	1	Spring washer		(955924) L = 16 MM

MD11C

REF	PART NO.	QTY	DESCRIPTION	SEE SEC.	NOTES
63	941907	1	Spring washer		
64	943369	X	Rubber hose		L = 95 MM
65	943472	2	Hose clamp		
66	829928	1	Hose connection		
67	418445	1	Sealing ring		
68	955269	2	Hexagon screw		L = 12 MM
69	941906	2	Spring washer		
70	952969	X	Hose		L = 50 MM
71	943473	2	Hose clamp		
72	418411	12	Sealing ring		
73	844624	1	Pressure cap		(1542591)
74	958332	1	V-belt		L = 1550 MM
75	833969	1	Insert nipple		OBSOLETE PART
76	833883	1	Water pump		
			•	15111	
			•	15113	
77	955998	1	O-ring		
78	807031	1	Screw		SEE GROUP 2A, OBSOLETE PART
79	801197	1	Hose attachment		
80	955296	2	Hexagon screw		
81	941907	2	Spring washer		
82	833878	2	Clamp		
83	833414	2	Air filter		OBSOLETE PART
84	833546	2	• Plug		
85	833468	1	Rubber hose		SEE GROUP 2A, OBSOLETE PART
86	833998	1	Exhaust riser		
87	803374	1	Gasket		
88	807050	1	Exhaust pipe flange		
89	955319	2	Hexagon screw		
90	831733	1	Strainer		SEE GROUP 9
91	828242	1	Cooling water inlet		SEE GROUP 9