

MD17D

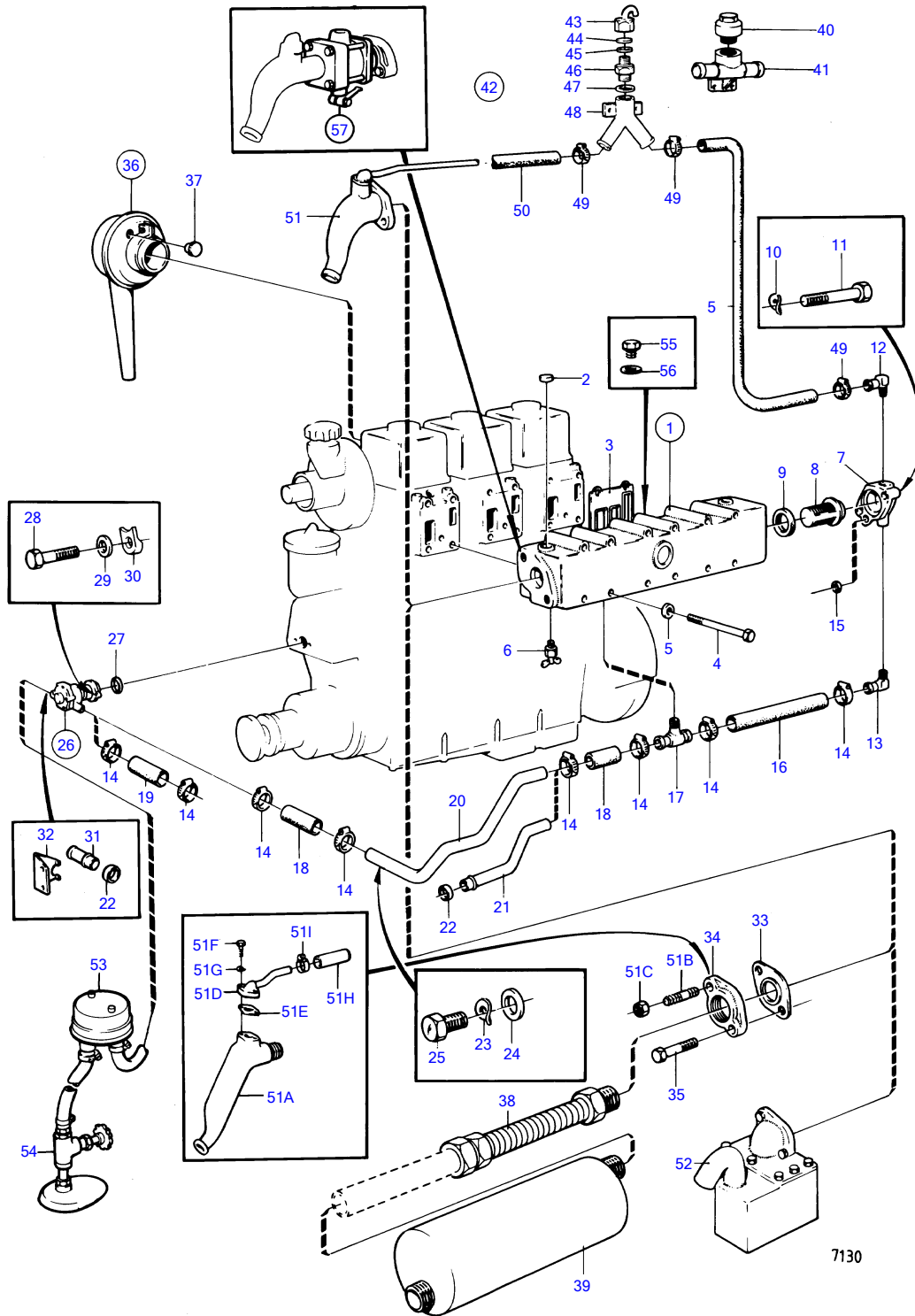

MD17D

REF	PART NO.	QTY	DESCRIPTION	NOTES
1	829950	1	Exhaust pipe	MO 16843-
2	192211	5	• Expansion plug	
3	833598	3	Gasket	
4	940129	12	Hexagon screw	
5	955894	12	Washer	
6	829592	1	Drain cock	
7	876080	1	Thermostat kit	LATE TYPE
8	876080	1	Thermostat kit	62°C
9	416033	1	Sealing ring	MO 16293-
10	941907	2	Spring washer	
11	955299	2	Hexagon screw	
12	801197	1	Hose attachment	
13	801197	1	Hose attachment	LATE TYPE
14	943472	4	Hose clamp	SPEC 867423, -426, -428, -500., MD17D SPEC 867681, -682, -683.
15	955989	1	O-ring	
16	952969	X	Hose	L = 290 MM
17	833356	1	Hose attachment	OBSOLETE PART
18	952969	X	Hose	SPEC 867423, -426, -428, -500., MD17D SPEC 867681, -682, -683., L = 1X70 MM
20	829896	1	Coolant pipe	SPEC 867426, -428, -500., MD17D SPEC 867681, -682, -683., OBSOLETE PART
22	418411	1	Sealing ring	MD17D SPEC 867681, -682, -683.
26	829895	1	Sea water pump	MD17C/HD-BT, MD17C/HD. SPEC 867500 MO17973-.
	875698	1	Repair kit	FOR WATER PUMP 829895.
27	925091	1	O-ring	
28	955296	2	Hexagon screw	MD17D SPEC 867681, -682, -683., L = 22 MM
29	941907	2	Spring washer	MD17D SPEC 867681, -682, -683.
30	833878	2	Clamp	MD17C/HD-HY., MD17C/110S., SPEC 867426, -428, -500., MD17D SPEC 867681, -682, -683.
31	829901	1	Connection pipe	MD17D SPEC 867681, -682, -683.
32	840194	1	Anchorage	SPEC 867423., SPEC 867426, 867428.
33	803374	1	Gasket	
34	807050	1	Exhaust pipe flange	
35	955319	2	Hexagon screw	
36	833414	3	Air filter	LATE TYPE, OBSOLETE PART
37	833546	3	• Plug	
38	833841	1	Compensator	DRY EXHAUST LINE., OBSOLETE PART
39	833840	1	Muffler, DRY	DRY EXHAUST LINE.
42	828534	1	Vacuum valve	(828263)
43		1	• UPPER UNIT	
44		2	• Diaphragm	
45	828424	2	• Gasket	
46		1	• LOWER PART	
47	947282	2	• Gasket	
48	828262	1	Hose connection	LATE TYPE
49	961666	4	Hose clamp	
50	13569	X	Hose	
51A	833998	1	Exhaust riser	MD17D SPEC 867681, -682, -683., MD17C SPEC 867500.
51B	924079	2	Stud	MD17D SPEC 867681, -682, -683., MD17C SPEC 867500.
51C	955783	2	Hexagon nut	MD17D SPEC 867681, -682, -683., MD17C SPEC 867500.
51D	833422	1	Coolant pipe	MD17D SPEC 867681, -682, -683., MD17C SPEC 867500., OBSOLETE PART
51E	800326	1	Gasket	MD17D SPEC 867681, -682, -683., MD17C SPEC 867500.
51F	955275	2	Hexagon screw	MD17D SPEC 867681, -682, -683., MD17C SPEC 867500.
51G	941906	2	Spring washer	MD17D SPEC 867681, -682, -683., MD17C SPEC 867500.
51H	952969	X	Hose	MD17D SPEC 867681, -682, -683., MD17C SPEC 867500., L = 55 MM
51I	943472	1	Hose clamp	MD17D SPEC 867681, -682, -683., MD17C SPEC 867500.
55	960630	1	Plug	FOR EXHAUST MANIFOLD 829950.
56	957178	1	Gasket	FOR EXHAUST MANIFOLD 829950.
57				