

TMD100A

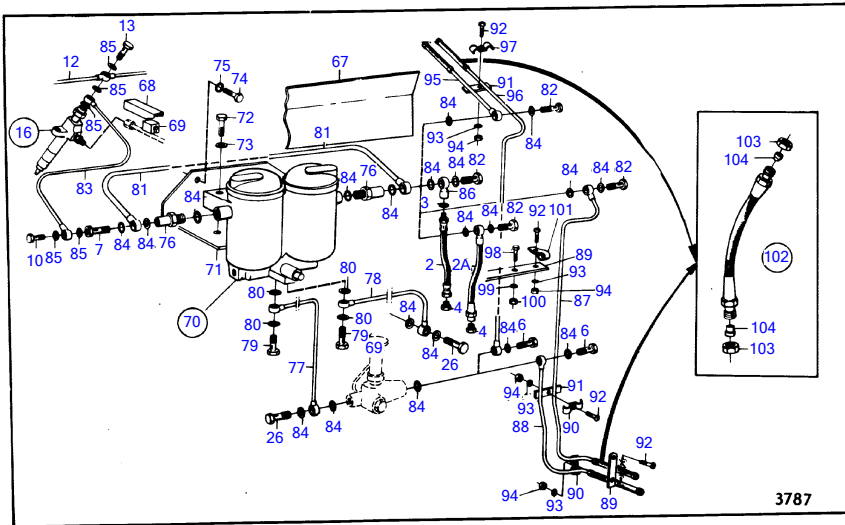
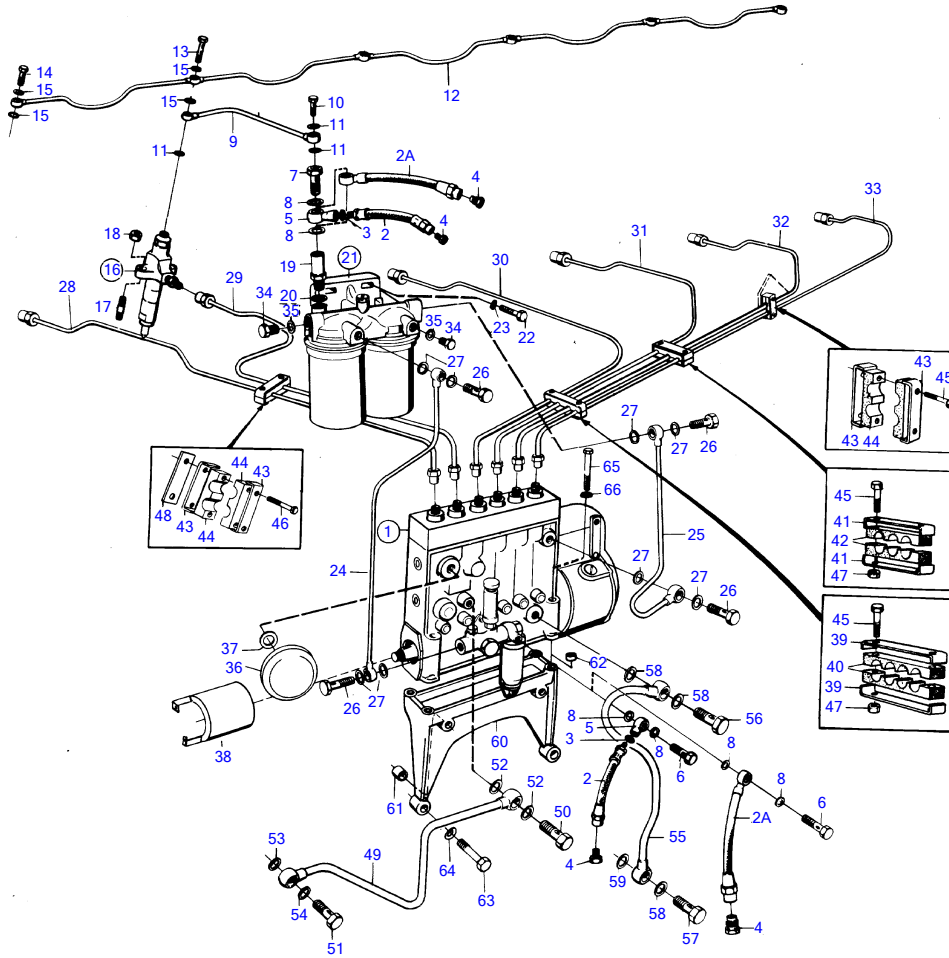

TMD100A

REF	PART NO.	QTY	DESCRIPTION	NOTES
1		1		Included in fuel injector.
		1		For generating unit.
	836907	1	Injection pump	Repl by 843569
	843569	1	Injection pump	Obsolete part
2		2	fuel hose	Std Repl by 837363
		2	fuel hose	Spec VER Repl by 837364
2A	845372	2	Fuel hose	(837363)
2	845372	2	Fuel hose	(837363)
3	11998	2	Gasket	
4	22753	2	Nipple	
5	26016	2	Banjo nipple	Obsolete part
6	25167	1	Hollow screw	
7	16496	1	Hollow screw	
8	18671	4	Gasket	
9	823528	1	Leak-off line	Obsolete part
10	74033	1	Hollow screw	
11	957171	3	Gasket	
12	424202	1	Leak-off pipe	
13	74034	1	Hollow screw	
14	74033	5	Hollow screw	
15	957171	12	Gasket	
16	240346	6	Injector	
17	941928	12	Stud	
18	417110	12	Nut	
19	35096	1	Overflow valve	
20	18671	1	Gasket	
21	241672	1	Filter housing	Replaced by 77989.
	471172	1	Filter housing	
22	940162	2	Hexagon screw	
23	942336	2	Spring washer	
24	823526	1	Fuel pipe	Obsolete part
25	823527	1	Fuel pipe	Obsolete part
26	25167	4	Hollow screw	
27	18671	8	Gasket	
28	896730	1	Delivery pipe	Cyl. no. 1, Obsolete part
29	896731	1	Delivery pipe	Cyl. no. 2, Obsolete part
30	896732	1	Delivery pipe	Cyl. no. 3, Obsolete part
31	896733	1	Delivery pipe	Cyl. no. 4, Obsolete part
32	896734	1	Delivery pipe	Cyl. no. 5, Obsolete part
33	896735	1	Delivery pipe	Cyl. no. 6, Obsolete part
34	960630	2	Plug	
35	957178	2	Gasket	
36	466398	1	Pressure equalizer	
37	957178	1	Gasket	
38				
39	414348	2	Attaching clamp	Obsolete part
40	414349	2	Attaching clamp	Obsolete part
41	414346	2	Attaching clamp	
42	414347	2	Attaching clamp	
43	414344	4	Attaching clamp	
44	414345	4	Attaching clamp	
45	955247	6	Hexagon screw	
46	955248	2	Hexagon screw	
47	955780	4	Hexagon nut	
48	414736	1	Nut plate	
49	422245	1	Oil feed pipe	
50	48634	1	Hollow screw	
51	942081	1	Hollow screw	Early type see group 2B
	837709	1	Hollow screw	Late type see group 2B
52	957173	2	Gasket	
53	18666	1	Gasket	
54	11994	1	Gasket	
55	422246	1	Return pipe	

TMD100A

REF	PART NO.	QTY	DESCRIPTION	NOTES
56	25167	1	Hollow screw	
57	954394	1	Hollow screw	
58	18671	3	Gasket	
59	11998	1	Gasket	
60	468558	1	Bracket	
61	423161	2	Guide sleeve	Obsolete part
62	417588	1	Guide sleeve	
63	955566	4	Hexagon screw	
64	940280	4	Spring washer	
65	940156	4	Hexagon screw	
66	190509	4	Washer	
67	824377	1	Protecting plate	MOXXXXX/1496-, Obsolete part
68	824379	6	Protecting plate	MOXXXXX/1496-, Obsolete part
69	836456	6	Protecting sleeve	MOXXXXX/1496-, Obsolete part
70	243405	1	Fuel filter kit	MOXXXXX/1496-
71	845319	1	Bracket	MOXXXXX/1496-, (836365)
72	940134	2	Hexagon screw	MOXXXXX/1496-
73	941909	2	Spring washer	MOXXXXX/1496-
74	940115	2	Hexagon screw	MOXXXXX/1496-
75	942336	2	Spring washer	MOXXXXX/1496-
76	35096	2	Overflow valve	MOXXXXX/1496-
77	837106	1	Fuel pipe	MOXXXXX/1496-, Obsolete part
78	837107	1	Fuel pipe	MOXXXXX/1496-, Obsolete part
79	26013	2	Hollow screw	MOXXXXX/1496-
80	11998	4	Gasket	MOXXXXX/1496-
81	836748	1	Pipe	MOXXXXX/1496-
82	180211	1	Hollow screw	MOXXXXX/1496-
83	844720	1	Pipe	MOXXXXX/1496-, (837108), Obsolete part
84	18671	11	Gasket	MOXXXXX/1496-
85	957171	5	Gasket	MOXXXXX/1496-
86	26016	1	Banjo nipple	MOXXXXX/1496-, Obsolete part
87	844721	1	Fuel pipe	MOXXXXX/1496-, (837108), Obsolete part
88	837607	1	Fuel pipe	MOXXXXX/1496-, Obsolete part
89	821625	1	Anchorage	MOXXXXX/1496-, Obsolete part
90	941492	2	Clamp	MOXXXXX/1496-, Obsolete part
91	821076	1	Anchorage	MOXXXXX/1496-, Obsolete part
92	950046	2	Cross recessed screw	MOXXXXX/1496-
93	941906	2	Spring washer	MOXXXXX/1496-
94	955825	2	Hexagon nut	MOXXXXX/1496-
95	837608	1	Fuel pipe	MOXXXXX/1496-, Obsolete part
96	837609	1	Fuel pipe	MOXXXXX/1496-, Obsolete part
97	941492	1	Clamp	MOXXXXX/1496-, Obsolete part
98	955550	1	Hexagon screw	MOXXXXX/1496-
99	955896	1	Washer	MOXXXXX/1496-
100	940157	1	Hexagon nut	MOXXXXX/1496-
101	952625	1	Clamp	MOXXXXX/1496-
102		2		MOXXXXX/1496-, Repl by 845450
103	956983	4	• Fitting nut	MOXXXXX/1496-
104	956969	4	• Ferrule	MOXXXXX/1496-