

D9A2A D9A-MG, D9A2A MG

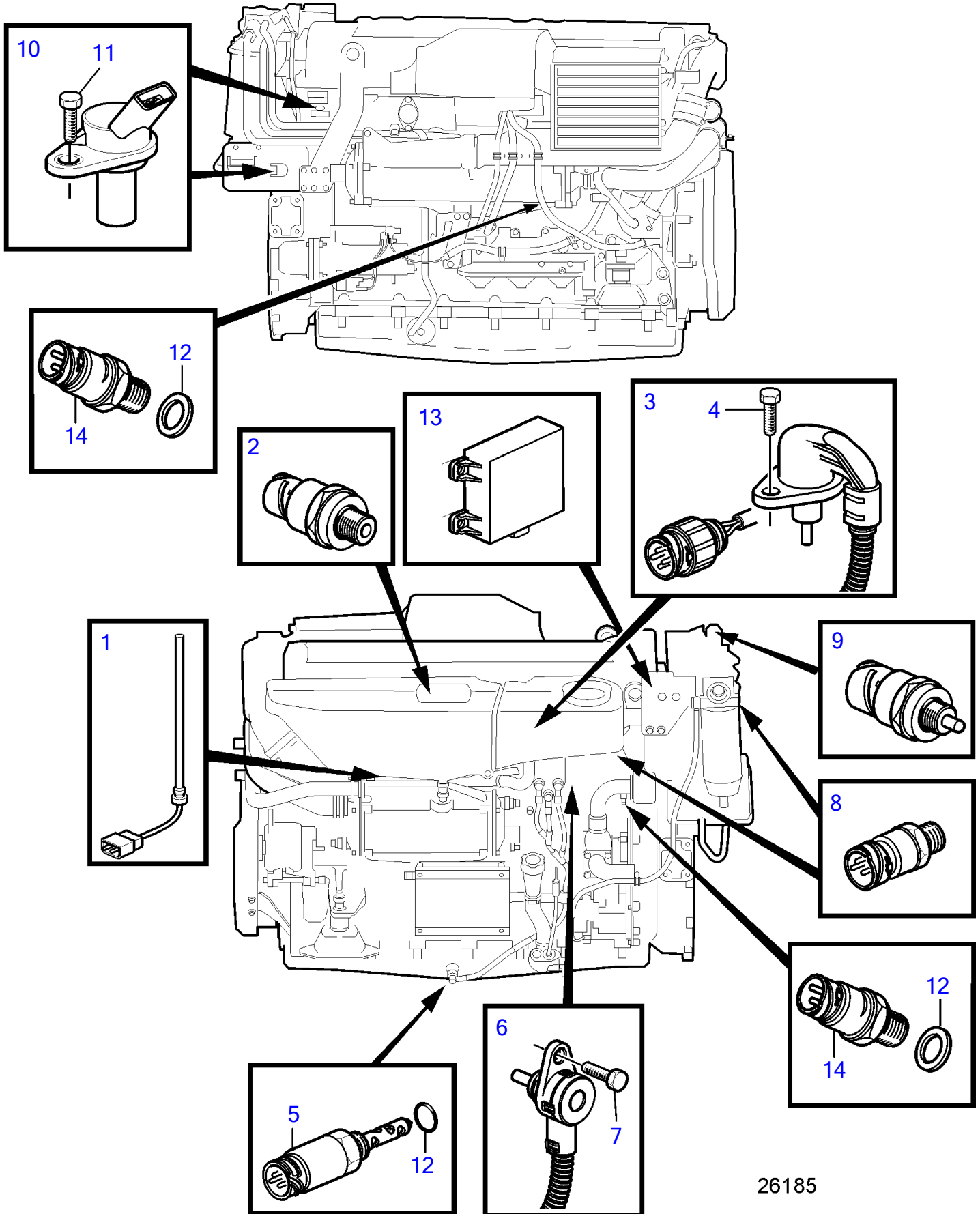

26185

D9A2A D9A-MG, D9A2A MG

REF	PART NO.	QTY	DESCRIPTION	NOTES
1	3588990	1	Level sensor, expansion tank	
2	20796744	1	Pressure sensor	(20499340)
3	20909613	1	Sensor, charge air pressure/temp	
4	946934	1	Flange screw	
5	874328	1	Level guard, oil	
6	20576617	1	Sensor	(20429956)
7	946440	1	Flange screw	
8	20898038	2	Pressure sensor, fuel/oil pressure	(20886108)
9	1077574	1	Sensor, oil pressure/temperature	
10	20513343	2	Sensor, rpm cam gear, flywheel	
11	946544	1	Flange screw	
12	968559	2	O-ring	
13	3842462	1	Voltage converter	12V, When replacing the DC/DC converter must also the cable kit be exchanged., Spare parts no. 21506656
14	874329	1	Sensor	Replaced by 3808805.
	3808805	2	Pressure sensor	