

D30A-MT, D30A-MS

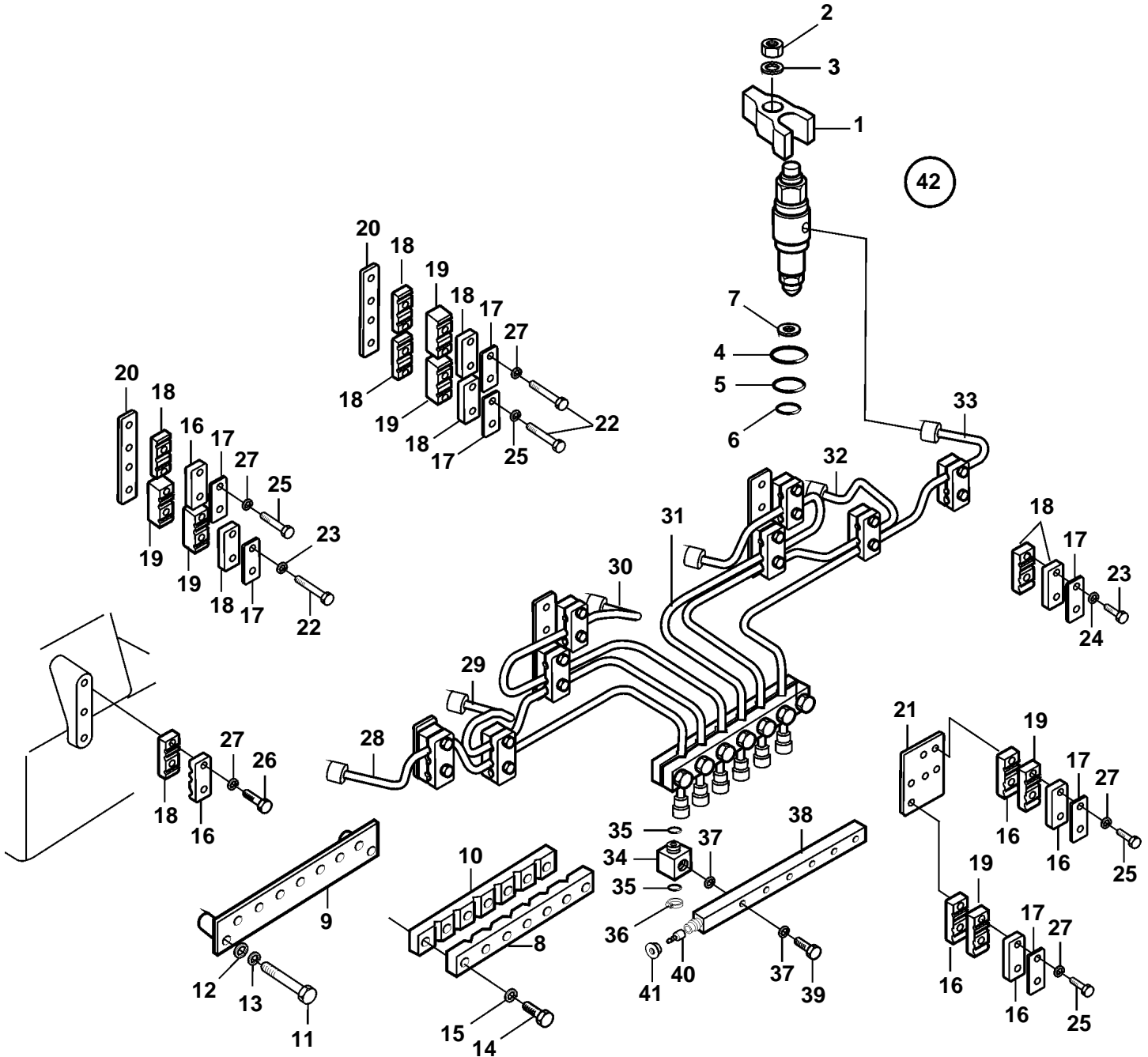

18662

D30A-MT, D30A-MS

REF	PART NO.	QTY	DESCRIPTION	SEE SEC.	NOTES
1	3831889	6	Seal		
2	3832205	6	Nut		
3	3831669	6	Washer		
4	3835114	6	O-ring		
5	3831561	6	O-ring		
6	3835113	6	O-ring		
7	3831900	6	Gasket		
8	3831892	1	Clamp		
9	3833185	1	Clamp		
10	3834482	1	Seat		
11	3832206	2	Screw		
12	3835208	2	Spacer		
13	3832245	2	Spring washer		
14	3831546	7	Screw		
15	3832245	7	Spring washer		
16	3807066	8	Clamp		(3831913)
17	3831914	8	Plate		
18	3807065	8	Clamp		(3831911)
19	3831949	5	Seat		
20	3831948	2	Plate		
21	3836369	1	Plate		
22	3832054	6	Screw		
23	3835724	4	Screw		
24	3832233	4	Spring washer		
25	3832051	4	Screw		
26	3832050	2	Screw		
27	3832233	14	Spring washer		
28	3838556	1	Delivery pipe		
29	3838557	1	Delivery pipe		
30	3838558	1	Delivery pipe		
31	3838559	1	Delivery pipe		
32	3838560	1	Delivery pipe		
33	3838561	1	Delivery pipe		
34	3807123	6	Connector		(3831893)
35	3831912	12	O-ring		
36	3832294	6	Snap ring		
37	3831586	12	Sealing washer		
38	3831888	1	Fuel pipe		
39	3831618	6	Screw		
40	3832319	1	Nipple		
41	3832213	1	Nut		
42	3835102	6	Injector		
				4852	