

D16C-A MH, D16C-A MG

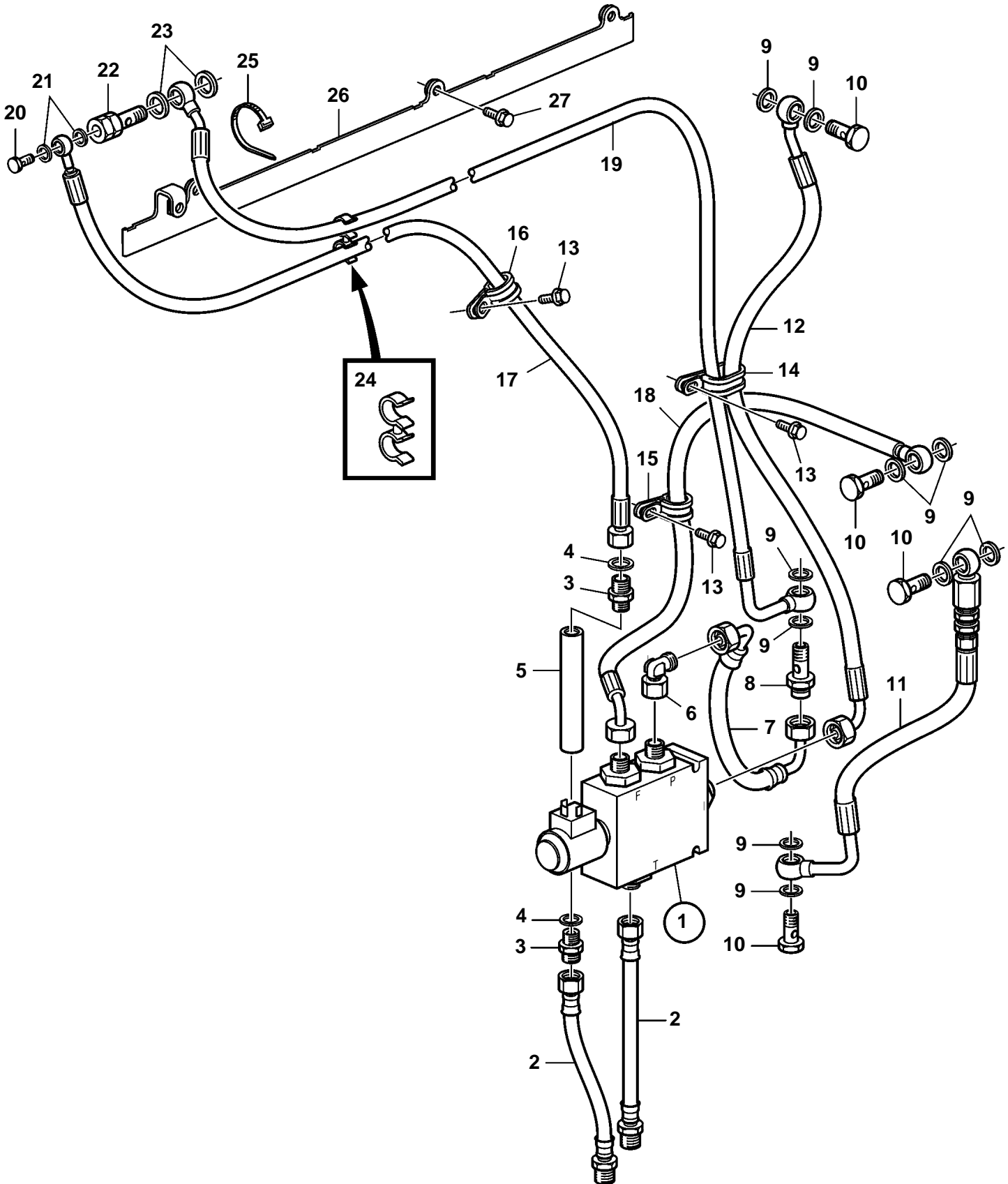

D16C-A MH, D16C-A MG

REF	PART NO.	QTY	DESCRIPTION	SEE SEC.
1	3835754	1	Shut-off valve	
				9904
2	3817202	2	Fuel hose	
3	963948	2	Nipple	
4	11996	2	Gasket	
5		1	Bracket	
6	964016	1	Nipple	
7	3588994	1	Fuel hose	
8	3819880	1	Nipple	
9	11996	10	Gasket	
10	941686	4	Hollow screw	
11	3888103	1	Fuel hose	
12	3589008	1	Fuel hose	
13	946440	3	Flange screw	
14	981664	1	Clamp	
15	949747	1	Clamp	
16	949746	1	Clamp	
17	3588992	1	Fuel hose	
18	3841380	1	Fuel hose	
19	3588996	1	Fuel hose	
20	48634	1	Hollow screw	
21	947281	2	Gasket	
22	20754813	1	Overflow valve	
23	11996	2	Gasket	
24	981857	1	Retainer	
25	948616	3	Strip clamp	
26		1	Bracket	
27	946173	3	Flange screw	
26	946173	3	Flange screw	