

D12D-A MP, D12D-B MH

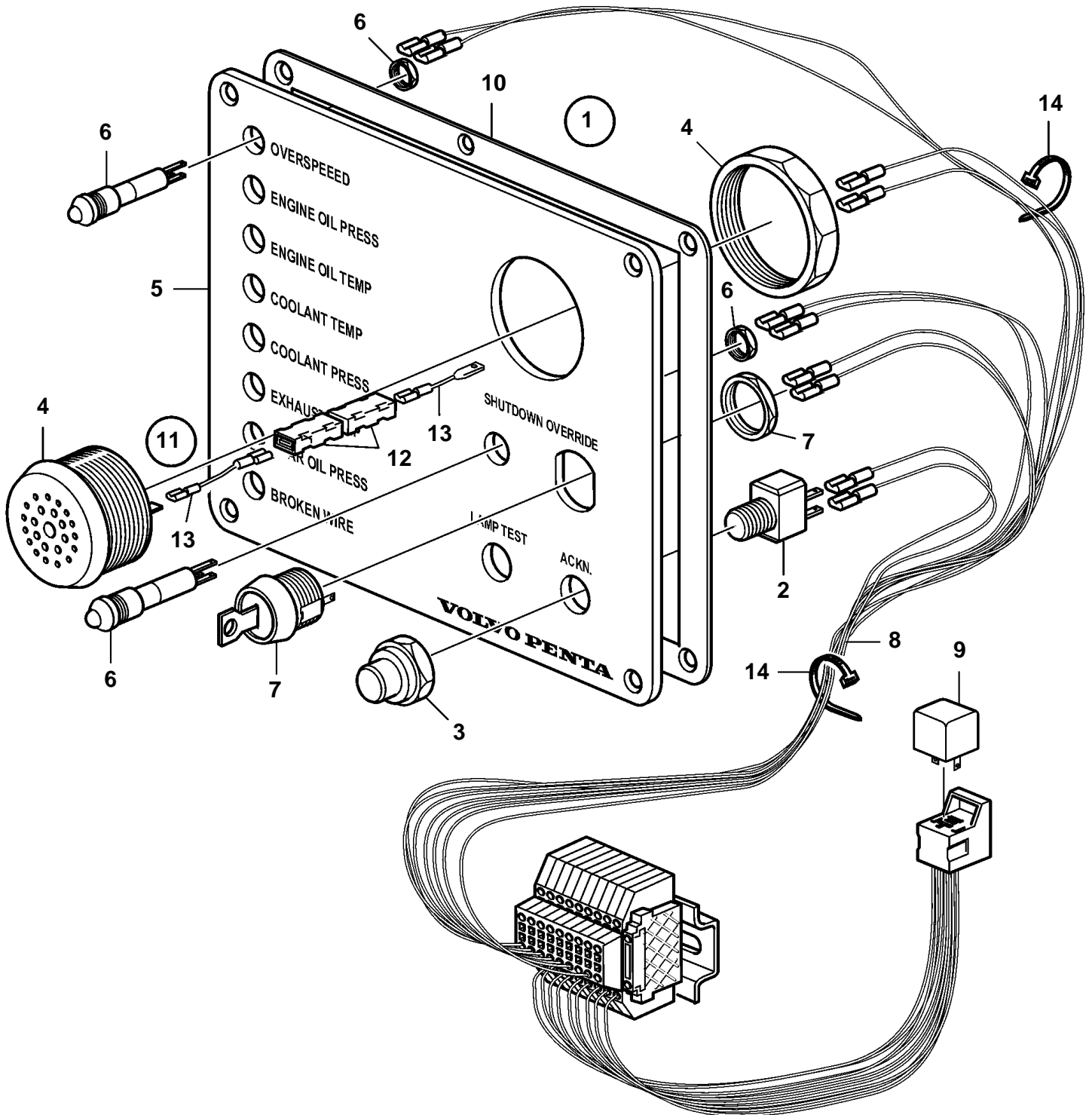

19731

D12D-A MP, D12D-B MH

REF	PART NO.	QTY	DESCRIPTION		NOTES
1	881959	1	Control panel		
2	828584	2	· Switch		
3	828586	2	· Nut		
4	828587	1	· Buzzer		
5		1	· Instrument panel		
6	881956	9	· Diode		
7	881963	1	· Switch	SO	
8	881999	1	· Cable kit		
9	20374662	1	· · Relay		
10	862331	1	Gasket		
11	859427	1	Diode kit		Contains parts for single and twin installation.
12	20382270	4	· Diode		
13		1	· Cable kit		
14	948702	X	Strip clamp		