

TAMD70E

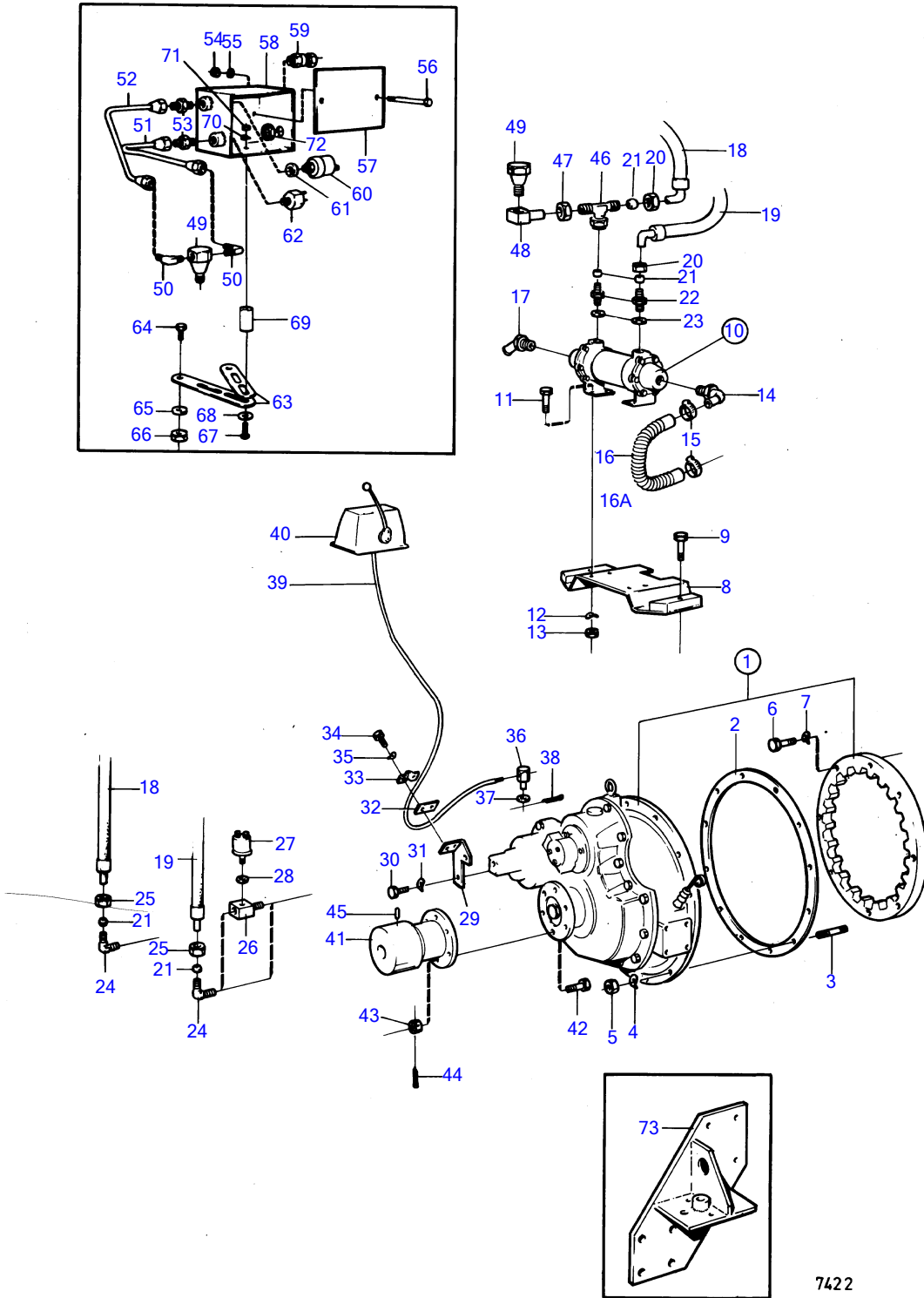

TAMD70E

REF	PART NO.	QTY	DESCRIPTION	SEE SEC.	NOTES
1		1	rev.gear, ratio 1,00:1		
		1	rev.gear, ratio 1,51:1		
		1	rev.gear, ratio 1,98:1		
		1	rev.gear, ratio 2,99:1		
		1	* component not spec		
2	862623	1	Gasket		
3	953486	11	Stud		L=45mm
	955536	1	Hexagon screw		
4	942336	12	Spring washer		
5	955827	11	Hexagon nut		
6	940162	8	Hexagon screw		
7	942336	8	Spring washer		
8	(847020)	1	Bracket		Obsolete part
9	955592	2	Hexagon screw		
10	844114	1	Oil cooler		
			*	16893	
11	940135	4	Hexagon screw		
12	941907	4	Spring washer		
13	955826	4	Hexagon nut		
14		1	pipe		See group 2B
15	836778	1	Gasket		
16	940135	2	Hexagon screw		
16A	941907	2	Spring washer		
17	(836759)	1	Hose attachment		Obsolete part
18	847165	1	Hose		L=580mm
19	848254	1	Hose		L=660mm
20	941331	2	Fitting nut		
21	956970	5	Ferrule		
22	943755	2	Fitting		
23	957184	2	Gasket		
24	941757	2	Elbow nipple		
25	956984	2	Fitting nut		
26	842425	1	Nipple		
27	837781	1	Oil pressure sensor		See group 3
28	947624	1	Gasket		
29	(848223)	1	Bracket		Obsolete part
30	955309	2	Hexagon screw		
31	955894	2	Washer		
32	819068	1	Washer		
33	21471054	1	Bracket		
34	950021	2	Cross recessed screw		
35	941905	2	Spring washer		
36	(813674)	1	Cube		Obsolete part
37	940191	1	Washer		
38	17276	1	Split pin		
39		X	control cable		See group 9
40		X	control		See group 9
41	842106	1	Companion flange		
	(837055)	1	Clutch flange		Obsolete part, For ratio 2,99:1.
42	955738	6	Hexagon screw		
	(955750)	6	Hexagon screw		Obsolete part, For ratio 2,99:1.
43	955886	6	Castle nut		
	955887	6	Castle nut		For ratio 2,99:1.
44	907861	6	Split pin		
45	17178	2	Taper pin		For ratio 2,99:1.
46	(964049)	1	T-nipple		Obsolete part
47	941331	1	Fitting nut		
48	(847024)	1	Nipple		Obsolete part
49	942490	1	T-nipple		
50	954342	2	Elbow nipple		
51	(845645)	1	Tube		Obsolete part
52	(846334)	1	Tube		Obsolete part
53	954335	2	Nipple		

TAMD70E

REF	PART NO.	QTY	DESCRIPTION	SEE SEC.	NOTES
54	955825	2	Hexagon nut		
55	941906	2	Spring washer		
56	(955518)	2	Hexagon screw		Obsolete part
57	843225	1	Cardboard tube		
58	(843224)	1	Box		Obsolete part
59	822327	1	Grommet		
60	837781	1	Oil pressure sensor		
61	947624	1	Gasket		
62	848368	1	Pressure switch		
63	965534	4	Bracket		
64	940135	2	Hexagon screw		
65	941907	2	Spring washer		
66	955826	2	Hexagon nut		
67	940180	2	Hexagon screw		
68	960140	4	Washer		
69	821541	2	Spacer sleeve		
70	941906	2	Spring washer		
71	955825	2	Hexagon nut		
72	880243	1	Nut		
73		2	engine mounts		See group 2A