

TAMD70D

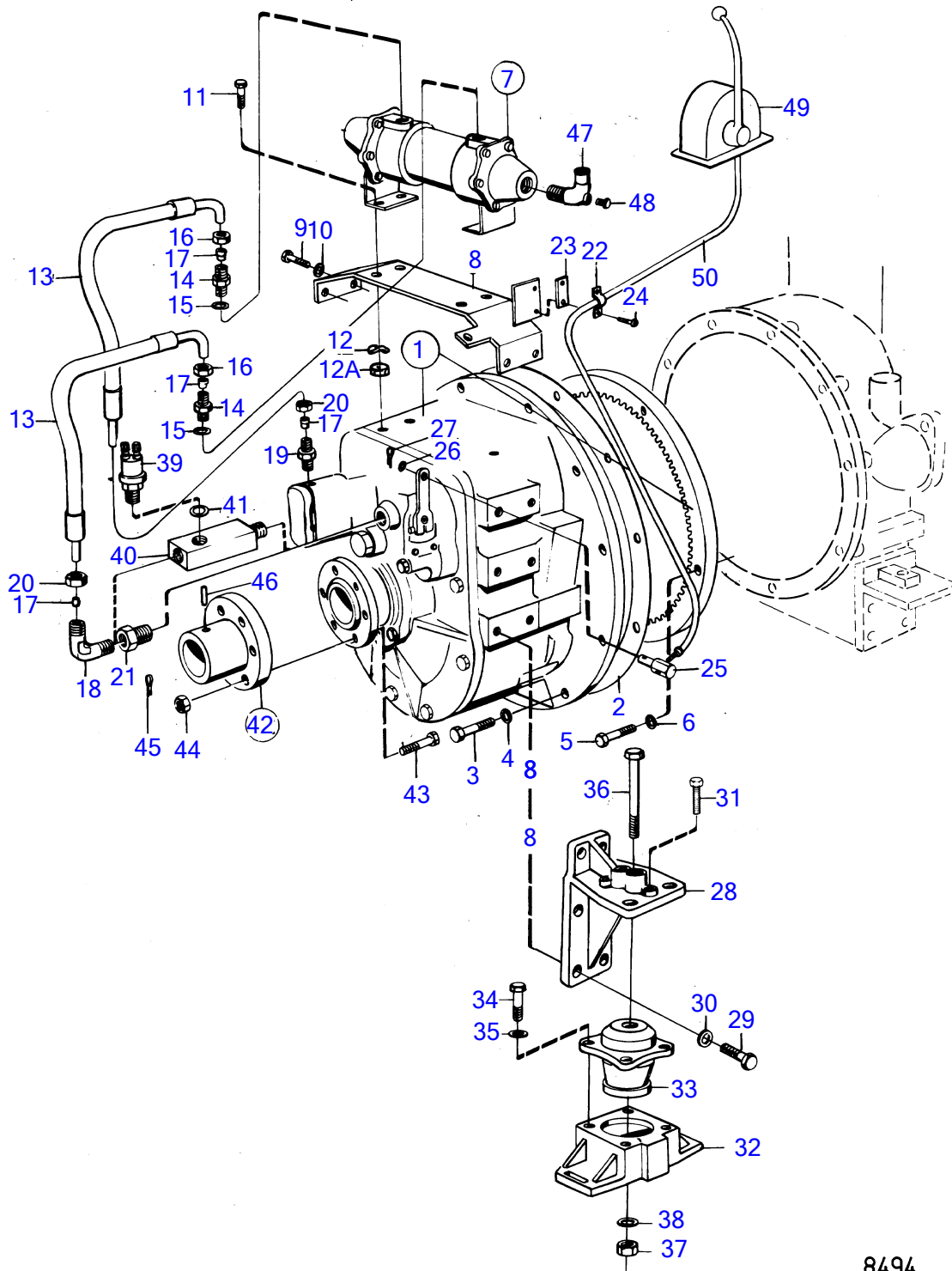

8494

## TAMD70D

REF	PART NO.	QTY	DESCRIPTION	SEE SEC.	NOTES
1		1	rev.gear, ratio 1:1		
		1	rev.gear, ratio 1,47:1		
		1	rev.gear, ratio 1,93:1		
		1	rev.gear, ratio 2,93:1		
			• components not spec.		
2	862623	1	Gasket		
3	940115	12	Hexagon screw		L=25mm
4	942336	12	Spring washer		
5	940162	8	Hexagon screw		
6	942336	8	Spring washer		
7	804472	1	Oil cooler		
			.	16893	
8	(837315)	1	Bracket		Obsolete part
9	955560	4	Hexagon screw		
10	940280	4	Spring washer		
11	940113	4	Hexagon screw		
12	941907	4	Spring washer		
12A	955826	4	Hexagon nut		
13	837355	2	Hose assembly		
14	943755	2	Fitting		
15	957184	2	Gasket		
16	941331	2	Fitting nut		
17	956970	4	Ferrule		
18	941750	2	Nipple		
19	941750	1	Nipple		
20	956984	2	Fitting nut		
21	804533	1	Nipple		
22	21471054	1	Bracket		
23	819068	1	Washer		
24	950021	2	Cross recessed screw		
25	(813674)	1	Cube		Obsolete part
26	940191	1	Washer		
27	17276	1	Split pin		
28	(837715)	2	Bracket		Obsolete part
29	955561	12	Hexagon screw		
30	940280	12	Spring washer		
31	837717	2	Screw		
32	(837716)	2	Anchorage		Obsolete part
33	837826	2	Rubber cushion		
34	955317	8	Hexagon screw		
35	941908	8	Spring washer		
36	(955378)	2	Hexagon screw		Obsolete part
37	955785	2	Hexagon nut		
38	941912	2	Spring washer		
39	837781	1	Oil pressure sensor		See group 3
40	842425	1	Nipple		
41	957181	1	Gasket		
42	830737	1	Clutch flange		
	(837054)	1	Clutch flange		For ratio:3,8-4,5, Obsolete part
43	955737	6	• Hexagon screw		
	(955750)	6	• Hexagon screw		For ratio:3,8-4,5, Obsolete part
44	955886	6	• Castle nut		
	955887	6	• Castle nut		For ratio:3,8-4,5
45	907861	6	• Split pin		
	17178	2	• Taper pin		For ratio:3,8-4,5
46	907619	1	Taper pin		
47	(942334)	1	Hose attachment		See group 2B, Obsolete part
48	192134	1	Plug		See group 2B
49		1	control		See group 9
50		1	control cable		See group 9