

AQD70D, TAMD70D

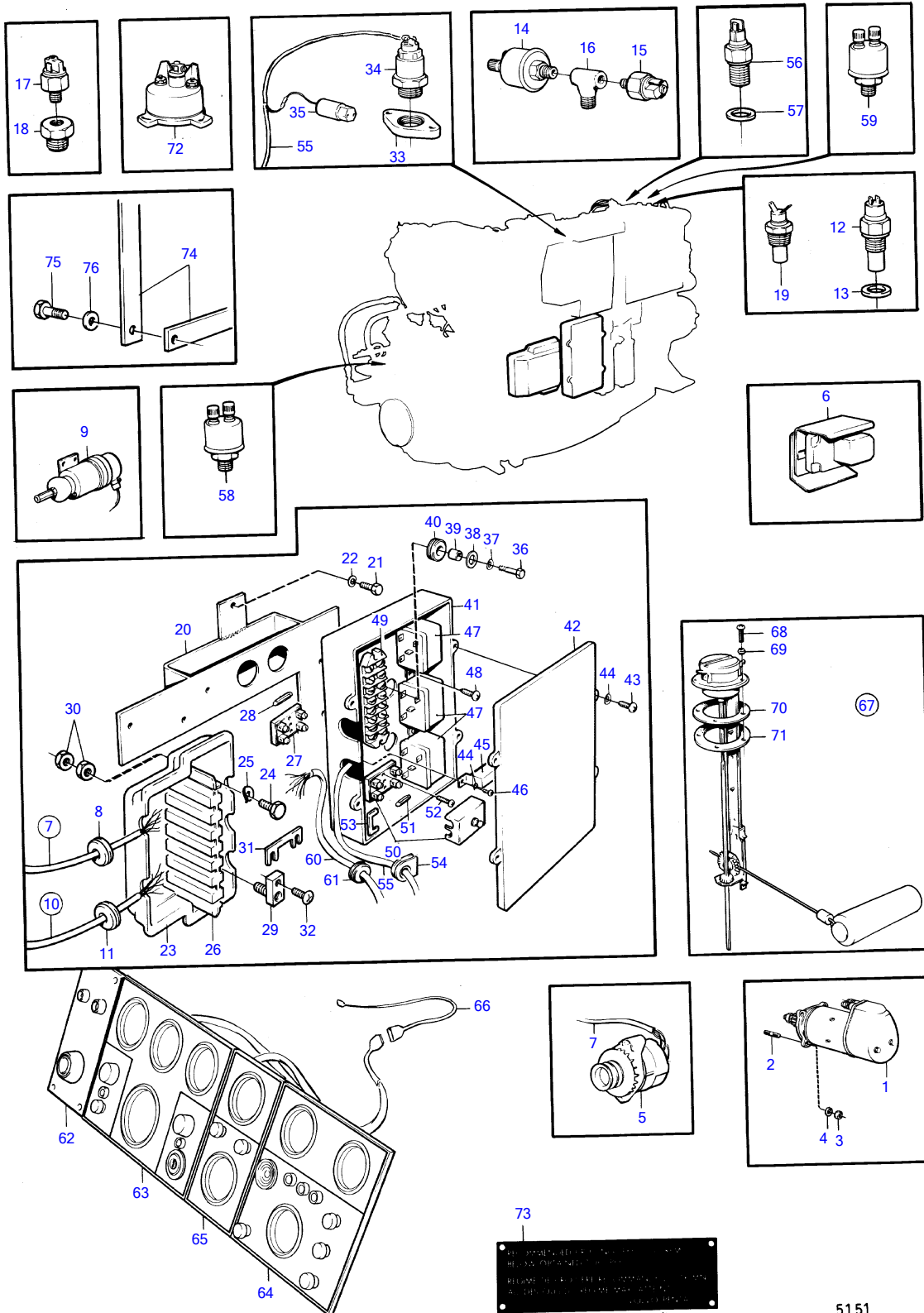

5151

AQD70D, TAMD70D

REF	PART NO.	QTY	DESCRIPTION	SEE SEC.	NOTES
1	(843511)	1	Starter motor		12V repl by 847306, Obsolete part
			.	16861	
	843510	1	Starter motor		24V repl by 847307
			.	16861	
	847306	1	Starter motor		12V later prod
			.	16862	
	847307	1	Starter motor		24V later prod
			.	16863	
2	953486	3	Stud		
3	955827	3	Hexagon nut		
4	942336	3	Spring washer		
5		1	alternator and installation components		12V38A,24V25A
				16875	
		1	alternator and installation components		24V60A
				16854	
6		1	charging relay and installation components		12V38A,24V25A
				16875	
	(823766)	1	Charge regulator		Obsolete part, 24V60A
			.	16860	
7	(843195)	1	Cable trunk		Obsolete part, Alternator,starter,fuse,charging relay., 12V38A,24V25A
	(843209)	1	Cable trunk		Obsolete part, Alternator,starter,fuse,charging relay., 24V60A
8	941265	1	• Grommet		
9		1	stop solenoid and installation components		See group 2D
10	(837821)	1	Cable trunk		Obsolete part
11	941265	1	• Grommet		
12	827150	1	Sensor		
13	11996	1	Gasket		
14	843231	1	Oil pressure sensor		
15	881348	1	Pressure switch		Stop
16	942490	1	T-nipple		
17	880281	1	Pressure monitor		
18	180002	1	Nipple		
19	822858	1	Thermo monitor		
20	(837825)	1	Bracket		Obsolete part
21	940135	3	Hexagon screw		
22	941907	3	Spring washer		
23	837791	2	Clutch housing		MO 12338/XXXX-
24	955524	3	Hexagon screw		
25	941907	3	Spring washer		
26	(837829)	1	Terminal block		Obsolete part
27	(88578)	1	Fuse box		Obsolete part
28	943905	2	Fuse		
29	(837796)	4	Fitting screw		Obsolete part
30	17602	8	Hexagon nut		
31	77796	2	Fuse		50A
	239148	2	Fuse		80A
32	(941616)	4	Cross recessed screw		Obsolete part
33		1	flange		See group 2B
34		1	flame glow plug		See group 2C
35		1	solenoid valve		See group 2C
36	956571	2	Hex. socket screw		
37	941907	2	Spring washer		
38	960141	2	Washer		
39	(837372)	2	Spacer sleeve		Obsolete part
40	(837369)	2	Bushing		Obsolete part
41	(837335)	1	Clutch housing		Obsolete part
42	(823617)	1	Cardboard tube		Obsolete part
43	950047	4	Cross recessed screw		

7743260-30-16872

5151

Upd:2011-02-14

AQD70D, TAMD70D, TAMD70E

VOLVO
PENTA

AQD70D, TAMD70D

REF	PART NO.	QTY	DESCRIPTION	SEE SEC.	NOTES
44	941906	6	Spring washer		
45	(844486)	1	Timer relay		Obsolete part, 12V
	(837344)	1	Resistor		Obsolete part, 24V
46	950044	2	Cross recessed screw		
47	870670	3	Relay		12V
	870451	3	Relay		24V
48	(950009)	4	Screw		Obsolete part
49	(942558)	1	Terminal block		Obsolete part
50	(88578)	1	Fuse box		Obsolete part
51	943905	2	Fuse		25A
52	(950011)	4	Cross recessed screw		Obsolete part
53	(842390)	1	Bridge connector		Obsolete part
54	823759	2	Rubber bushing		
55	(837822)	1	Cable trunk		Obsolete part
56	354671	1	Tachometer sensor		See group 2A
57	925059	1	O-ring		See group 2A
58		1	oil pressure sensor		See group 4A
59		1	air pressure sensor		See group 2B
60	(837836)	1	Cable trunk		Obsolete part, Connector,instrument panel.
61	941265	2	• Grommet		
62	(844443)	1	Instrument panel		Obsolete part, 12V alt
			•	16869	
		1			24V alt
			•	16869	
63	(837820)	1	Instrument panel		Obsolete part, 12V alt
			•	16864	
	(837819)	1	Instrument panel		Obsolete part, 24V alt
			•	16864	
64	(837993)	1	Instrument panel		Obsolete part, -instrument panel for hour indicator and extra alarm device., 12V
			•	16865	
	(837994)	1	Instrument panel		Obsolete part, -instrument panel for hour indicator and extra alarm device., 24V
			•	16865	
65	(837995)	1	Instrument panel		Obsolete part, Instrument panel for tank gauge and rudder angel indicator, 12V
			•	16866	
	(837996)	1	Instrument panel		Obsolete part, Instrument panel for tank gauge and rudder angel indicator, 24V
			•	16866	
66	825738	X	Cable trunk		L=2500mm
	820419	X	Cable trunk		L=7000mm
	839180	X	Extension cable\verl		Use together with instr.panel 844443 and 844444. ND 844444, L=5000mm
	839180	X	Extension cable\verl		Use together with instr.panel 844443 and 844444. ND 844444, L=7000mm
67	837999	1	Sensor		
68	956078	4	• Cross recessed screw		L=16mm
	956081	1	• Cross recessed screw		L=25mm
69	834481	5	• Gasket		
70	89865	1	• Gasket		
71	834480	1	• Flange		
72	837772	1	Position sensor		
73	(837374)	1	Sign		Obsolete part
74		1	cable holders		
75	950044	1	Cross recessed screw		
76	941906	1	Spring washer		