

AD30A, AQAD30A, MD30A, TAMD30A, TMD30A

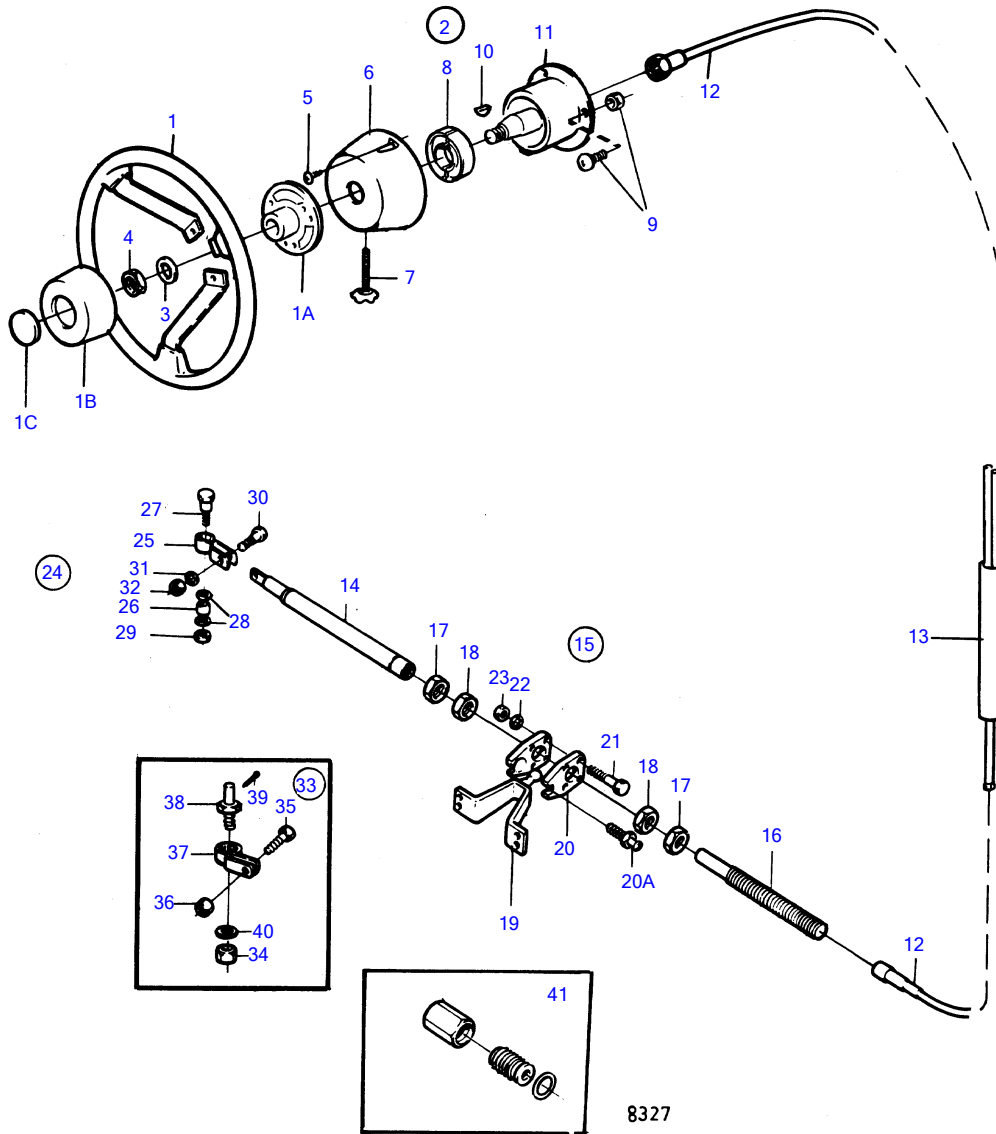

AD30A, AQAD30A, MD30A, TAMD30A, TMD30A

REF	PART NO.	QTY	DESCRIPTION	NOTES
1	850936	1	Steering wheel	
1A		1	• Steering wheel hub	
1B	828943	1	• Steering wheel pad	OBSOLETE PART
1C	850938	1	• Emblem	OBSOLETE PART
2	853182	1	Mounting kit	90°
	1140023	1	Mounting kit	90° BLACK
	853183	1	Mounting kit	70°
	1140024	1	Mounting kit	70° BLACK
3		1	• WASHER	
4		1	• NUT	
5		2	• SCREW	
6		1	• COVER	
7		1	• BRAKE SCREW	
8		1	• BRAKE	
9		4	• SCREW AND NUT	
10		1	• KEY	
11	853181	1	Steering gear	
12	828886	X	Steering cable	L = 2000 MM
	828887	X	Steering cable	L = 2250mm
	828888	X	Steering cable	L = 2500 MM
	828889	X	Steering cable	L = 2750mm
	853185	X	Steering cable	L = 3000 MM
	853186	X	Steering cable	L = 3250mm
	853187	X	Steering cable	L = 3500mm
	853188	X	Steering cable	L = 3750 MM
	853189	X	Steering cable	L = 4000 MM
	853190	X	Steering cable	L = 4250 MM
	853191	X	Steering cable	L = 4500 MM
	853192	X	Steering cable	L = 4750mm
	853193	X	Steering cable	L = 5000 MM
	828863	X	Steering cable	L = 5250mm
	853194	X	Steering cable	L = 5500 MM
	828864	X	Steering cable	L = 5750mm
	853195	X	Steering cable	L = 6000 MM
	828865	X	Steering cable	L = 6250mm
	853196	X	Steering cable	L = 6500mm
	828866	X	Steering cable	L = 6750 MM
	853197	X	Steering cable	L = 7000 MM
	853286	X	Steering cable	L = 7500 MM
	853287	X	Steering cable	L = 8000 MM
	853288	X	Steering cable	L = 8500 MM
	853289	X	Steering cable	L = 9000 MM
	828867	X	Steering cable	L = 9750mm, OBSOLETE PART
	828868	X	Steering cable	L = 10500 MM, OBSOLETE PART
	828869	X	Steering cable	L = 11250mm, OBSOLETE PART
	828874	X	Steering cable	L = 12000 MM, OBSOLETE PART
13	853291	1	Ds unit	Only for fly bridge., OBSOLETE PART
14	851059	1	Steering cylinder	FOR PORT MOUNTING., OBSOLETE PART
	851147	1	Steering cylinder	FOR STARBOARD MOUNTING., OBSOLETE PART
15	853290	1	Stern attachment	
16	850771	1	• Anchorage	
17	850778	2	• Nut	
18	853306	2	• Nut	
19	851093	1	• Bracket	
20	851077	2	• Anchorage	EARLY TYPE, OBSOLETE PART
	828854	1	• Anchorage	LATE TYPE
	828857	1	• Anchorage	LATE TYPE
20A	951739	1	• Lubricating nipple	FOR 828857
21	940101	4	• Hexagon screw	EARLY TYPE
	940101	2	• Hexagon screw	LATE TYPE
22	941906	4	• Spring washer	EARLY TYPE
	941906	2	• Spring washer	LATE TYPE
23	963105	4	• Lock nut	EARLY TYPE

7744050-64-18211

8327

Upd:2010-07-01

AD30A, AQAD30A, MD30A, TAMD30A, TMD30A, AD30, AQAD30, MD30, TAMD30, TMD30

AD30A, AQAD30A, MD30A, TAMD30A, TMD30A

REF	PART NO.	QTY	DESCRIPTION	NOTES
	963105	2	• Lock nut	LATE TYPE
24	851122	1	• Ball joint kit	REPL BY 828924
25		1	• • BRACKET	
26	851121	1	• • Sleeve	OBSOLETE PART
27	851117	1	• • Shoulder screw	OBSOLETE PART
28	942551	2	• • Washer	
29	966172	1	• • Lock nut	OBSOLETE PART
30	851118	1	• • Shoulder screw	OBSOLETE PART
31	941670	1	• • Washer	
32	966171	1	• • Lock nut	
33	828924	1	• Ball joint kit	
34	963119	1	• Lock nut	
35	851118	1	• Shoulder screw	OBSOLETE PART
36	966171	1	• Lock nut	
37		1	• BRACKET	
38		1	• SPLIT PIN SCREW	
39	967707	1	• Split pin	
40	955897	1	• Washer	
41	853214	X	Adapter	FOR FOREIGN STEERING CABLES.