

AQAD30A, MD30A, TAMD30A, TMD30A

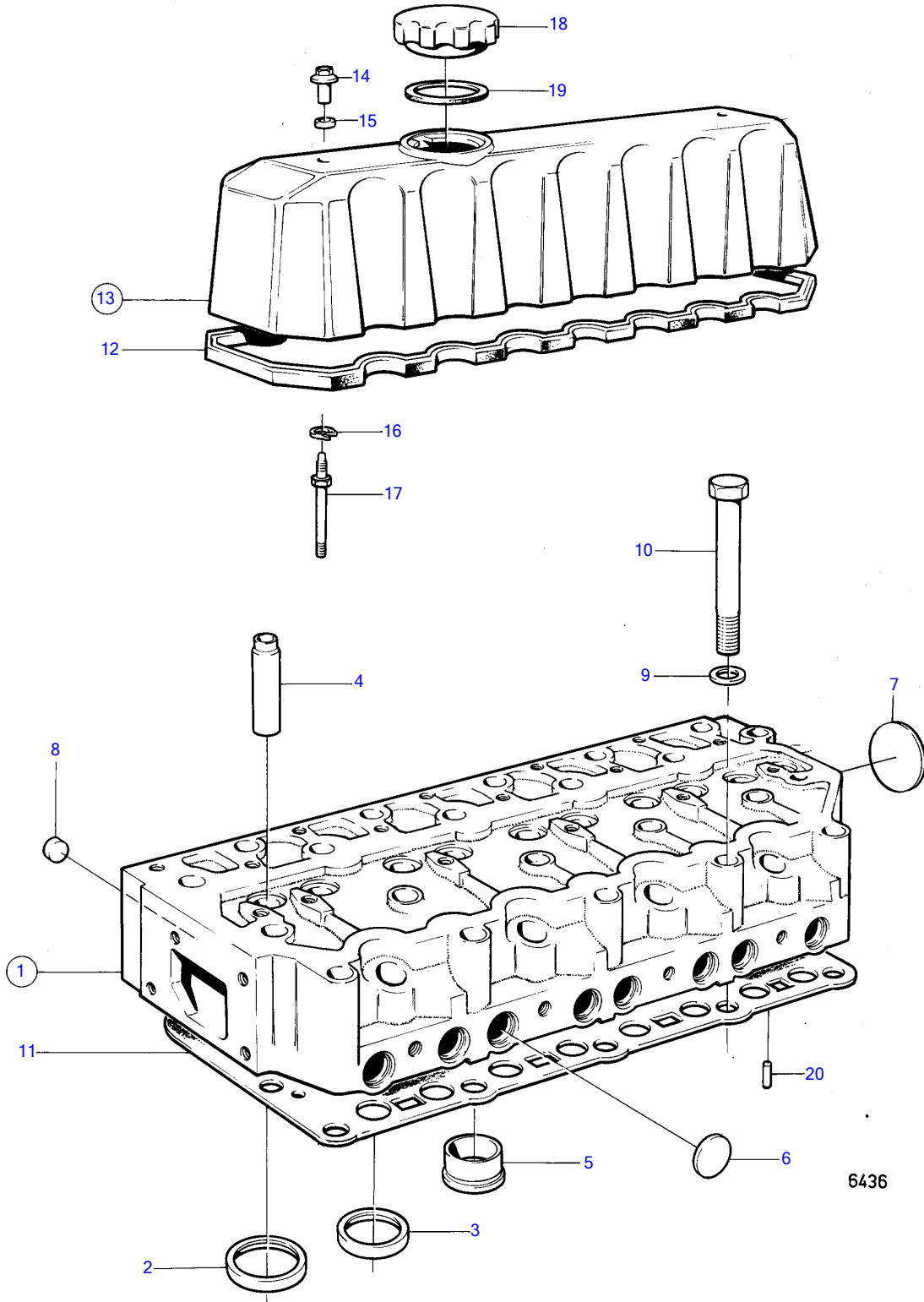

6436

AQAD30A, MD30A, TAMD30A, TMD30A

| REF | PART NO. | QTY | DESCRIPTION | SEE SEC. | NOTES |
|-----|----------|-----|-----------------------|----------|----------------------------------|
| 1 | 3803023 | 1 | Cylinder head, exch | | (1544110) |
| 2 | 1545174 | 4 | • Valve seat, INTAKE | | |
| | 1545175 | | • Valve seat, INTAKE | | OBSOLETE PART, OVER SIZE 0,20 MM |
| 3 | 1545177 | 4 | • Valve seat, EXHAUST | | |
| | 1545178 | | • Valve seat, EXHAUST | | OVER SIZE 0,20 MM |
| 4 | 419653 | 8 | • Valve guide | 18137 | |
| 5 | | 4 | • EMULSION BLOCK | | |
| 6 | 192426 | 12 | • Expansion plug | | |
| 7 | 1542264 | 1 | • Expansion plug | | OBSOLETE PART |
| 8 | 967853 | 4 | • Cap plug | | (955081) |
| 9 | 1542316 | 19 | Washer | | OBSOLETE PART, MO-7774 |
| 10 | 838775 | 19 | Screw | | (1542144) |
| | | | | | MO-7774 |
| | 838775 | 19 | Screw | | MO7775- |
| 11 | 1544109 | 1 | Gasket | | |
| 12 | 1544119 | 1 | Gasket | | |
| 13 | 1544117 | 1 | Valve cover | | OBSOLETE PART |
| 14 | 1542286 | 2 | • Cap nut | | |
| 15 | 469846 | 2 | • Sealing ring | | (424342) |
| 16 | 914449 | 2 | • Snap ring | | |
| 17 | 1542283 | 2 | Stud | 18137 | |
| 18 | 420292 | 1 | Oil filler cap | | |
| 19 | 940096 | 1 | Gasket | | |
| 20 | 946402 | 2 | Grooved pin | 18135 | |