

**4.75 IN/120.65MM
 TORPEDO DIA.**

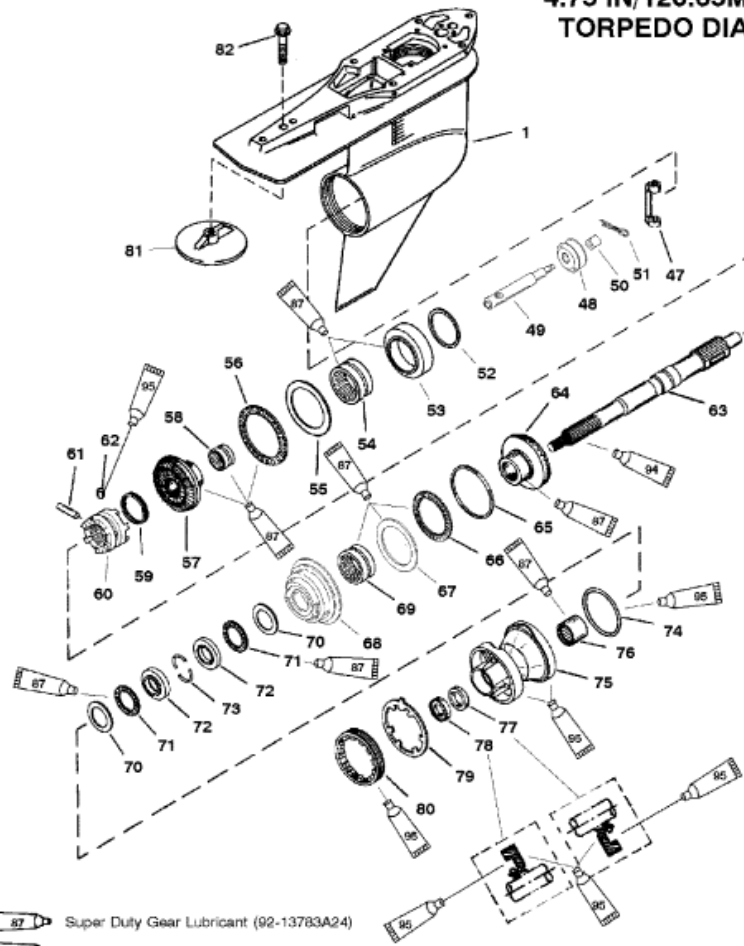

- Super Duty Gear Lubricant (92-13783A24)
- Anti-Corrosion Grease (92-78376A6)
- Loctite Quick Tite (Obtain Locally)

11095

Parts List

| Ref | Class | Part | Description | Qty | Comment | Footnote |
|-----|-------|-----------|----------------------------------|-----|---------|----------|
| 1 | 1623 | 859399T18 | GEAR HOUSING, Basic | 1 | (BLACK) | |
| 47 | | 823903 | SHIFT CRANK | 1 | | |
| 48 | | 19755T 7 | SPOOL ASSEMBLY | 1 | | |
| 49 | | NSS | NOT SOLD SEPARATE, Spool | 1 | | |
| 50 | | NSS | NOT SOLD SEPARATE, Sleeve | 1 | | |
| 51 | | NSS | NOT SOLD SEPARATE, Cotter F | 1 | | |
| 52 | 15 | 44491A 1 | SHIM SET | AR | | |
| 53 | | 828830A 2 | BEARING ADAPTOR ASSEMBLY | 1 | | |
| 54 | 31 | 814653T | ROLLER BEARING | 1 | | |
| 55 | 12 | 815481 | THRUST WASHER, | 1 | | |
| 56 | 31 | 815480 | BEARING, Thrust | 1 | | |
| 57 | 43 | 828696T 2 | GEAR, Reverse (12/21) | 1 | | |
| 58 | 31 | 15844 | BEARING ASSEMBLY, Roller | 1 | | |
| 59 | 24 | 30893 | SPRING | 1 | | |
| 60 | 52 | 859340T | CLUTCH | 1 | | |
| 61 | 17 | 30632 | PIN, Cross | 1 | | |
| 62 | 17 | 828356 | PIN, Detent | 1 | | |
| 63 | 44 | 824111 | SHAFT, Propeller | 1 | | |
| 64 | 43 | 828695A 1 | GEAR SET, Forward/Pinion (12/21) | 1 | | |
| 65 | 23 | 17615 14 | SPACER SHIM, (.206) | AR | | |
| 65 | 23 | 17615 15 | SPACER SHIM, (.208) | AR | | |
| 65 | 23 | 17615 16 | SPACER SHIM, (.210) | AR | | |
| 65 | 23 | 17615 17 | SPACER SHIM, (.212) | AR | | |
| 65 | 23 | 17615 18 | SPACER SHIM, (.214) | AR | | |
| 65 | 23 | 17615 19 | SPACER SHIM, (.216) | AR | | |
| 65 | 23 | 17615 20 | SPACER SHIM, (.218) | AR | | |
| 65 | 23 | 17615 21 | SPACER SHIM, (.220) | AR | | |
| 65 | 23 | 17615 22 | SPACER SHIM, (.222) | AR | | |
| 65 | 23 | 17615 23 | SPACER SHIM, (.224) | AR | | |
| 65 | 23 | 17615 24 | SPACER SHIM, (.226) | AR | | |
| 65 | 23 | 17615 25 | SPACER SHIM, (.228) | AR | | |
| 65 | 23 | 17615 26 | SPACER SHIM, (.230) | AR | | |
| 66 | 31 | 815480 | BEARING, Thrust | 1 | | |
| 67 | 12 | 815481 | THRUST WASHER, | 1 | | |
| 68 | | 828831A 3 | BEARING ADAPTOR ASSEMBLY | 1 | | |
| 69 | 31 | 814653T | ROLLER BEARING | 1 | | |
| 70 | 12 | 18448 | THRUST WASHER | 2 | | |
| 71 | 31 | 15842 | BEARING, Thrust | 2 | | |
| 72 | | 818291 1 | RACE, Thrust | 2 | | |
| 73 | | 814605 | KEEPER | 2 | | |
| 74 | 25 | 21524 | O-RING | 1 | | 15 |