

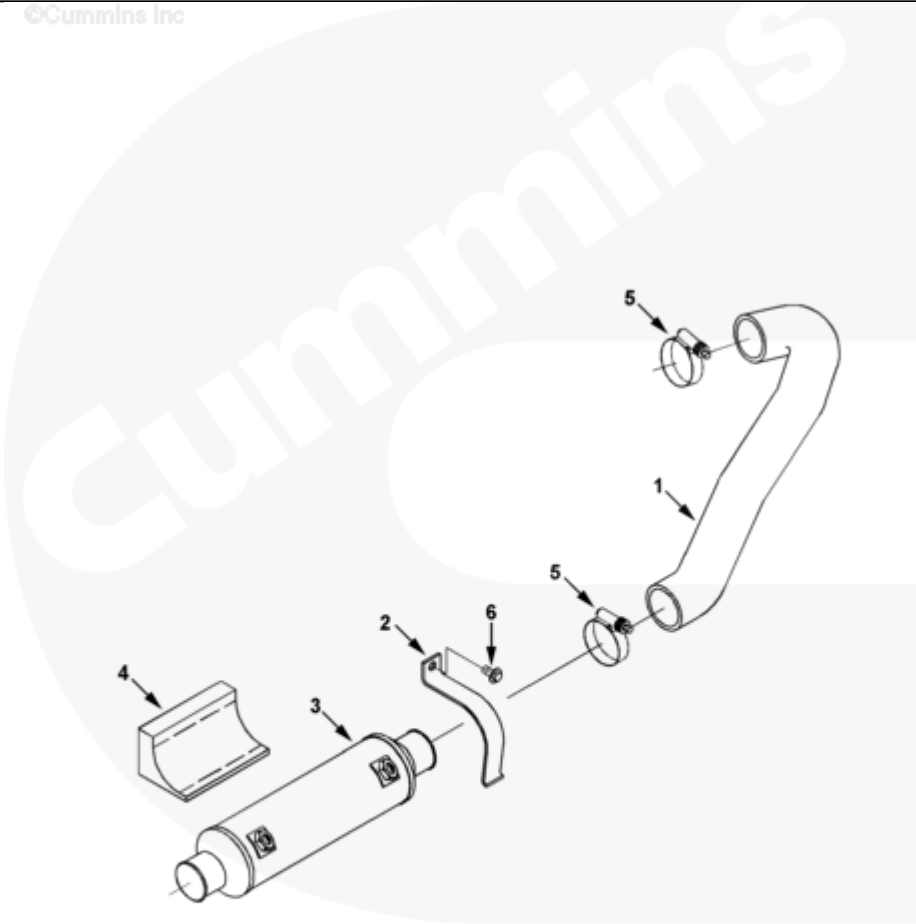

Parts Catalog - Option Detail

Electronic Parts Catalog - Option Detail				
Option	Group	Graphic	Film Card	Date
OC9033	16.05.4	oc940gd	Z	23-OCT-96
Engines	6C8.3, C GAS PLUS CM556, G8.3, G8.3 CM558, GTA8.3 CM558, ISC CM2150, ISC CM554, ISC CM850, ISC8.3 CM2250, ISC8.3 G CM2180 C101, ISL CM2150, ISL CM554, ISL CM850, ISL G CM2180, ISL8.9 CM2150 L110, ISL8.9 CM2880 L112, ISL9 CM2150 SN, ISL9 CM2250, ISL9 CM2350 L101, ISL9 CM2350 L111, ISLE4 CM850, L GAS PLUS CM556, L8.9, L8.9 L121, L8.9G CMOH2.0 L125B, L9 CM2350 L116B, L9 CM2350 L119B, L9 CM2350 L120C, L9 CM2350 L123B, L9.3 L105, L9.5 L117, L9N CM2380 L124B, QSC8.3 CM2250, QSC8.3 CM2880 C102, QSC8.3 CM554, QSC8.3 CM850(CM2850), QSL9 CM2250, QSL9 CM2250 L115, QSL9 CM2350 L102, QSL9 CM2350 L107, QSL9 CM2350 L118, QSL9 CM2350 L122, QSL9 CM554, QSL9 CM850(CM2850), QSL9 G CM558, QSL9 M CM2250 L106, QSL9.3 CM2880 L113			



oc940gd

Cart	Ref No	Part Number	Part Description	Required	Remarks
View My Cart					
		OC9033	Marine Gear Oil Cooler		MR - COOLER, MARINE GEAR OIL...(More)
					Marine Gear Oil Cooler for
					Use With Sea Water
					Aftercooled C Series
					Engines Where Oil Cooler is
					Mounted on the Inboard Side
					of the Aftercooler Bracket
					NOTE: This Option Does Not
					Contain Hoses to the Gear
<input type="checkbox"/>	1	3866050	Molded Hose	1	
<input type="checkbox"/>	2	3897179	Retainer Clamp	2	
<input type="checkbox"/>	3	3912146	Oil Cooler	1	
<input type="checkbox"/>	4	3912987	Vibration Isolator	1	
<input type="checkbox"/>	5	3922846	Hose Clamp	2	
<input type="checkbox"/>	6	3925883	Hexagon Flange Head Cap Screw	2	M8 X 1.25 X 16