

# "V"OL"V"OPEN'T.A. .

Volvo Penta of the Americas  
1300 Volvo Penta Drive  
Chesapeake, Virginia 23320-9810

## Parts Bulletin

Group	Number	Version
<b>P-44-1</b>	<b>2</b>	<b>01</b>

### Shift mechanism

Models: DP-D2, DPX-S1

Distribution: Parts   Date: 12-2004   Binder: Parts   Replaces: VPA 64-911, VPS 48-38

New shift mechanism parts were introduced during the production run of these drives. The new parts provide better shifting.

The table and picture below show the early parts and the later improved parts.

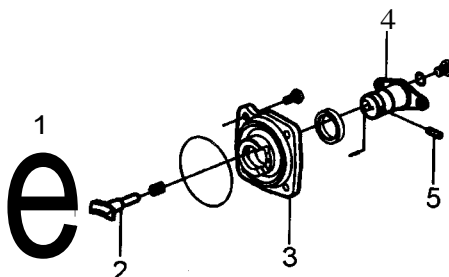

23642

### Shift mechanism

		Part No.	Part No.
Ref. No.	Description	early	late
1	Shift Cone	854222	3855783
2	Shift shoe	814603	3856502
3	Housing	872993	3855785
4	Eccentric	897816	3856008
5	Pin	942871	973593

For identification, the part number is stamped on the cone and housing. The parts shown are not interchangeable and should not be mixed when repairing these drives. Use either all early parts or all later parts.

Also see Parts Bulletins P-44-1-7 and P-44-1-8.