

V8-380-C-A, V8-380-C-B

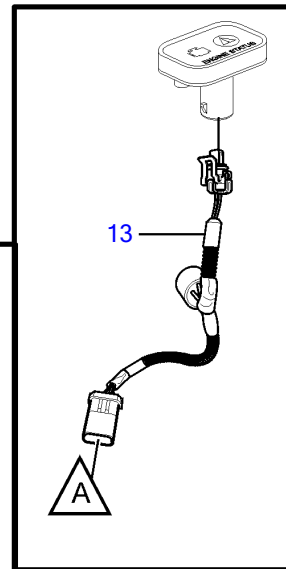
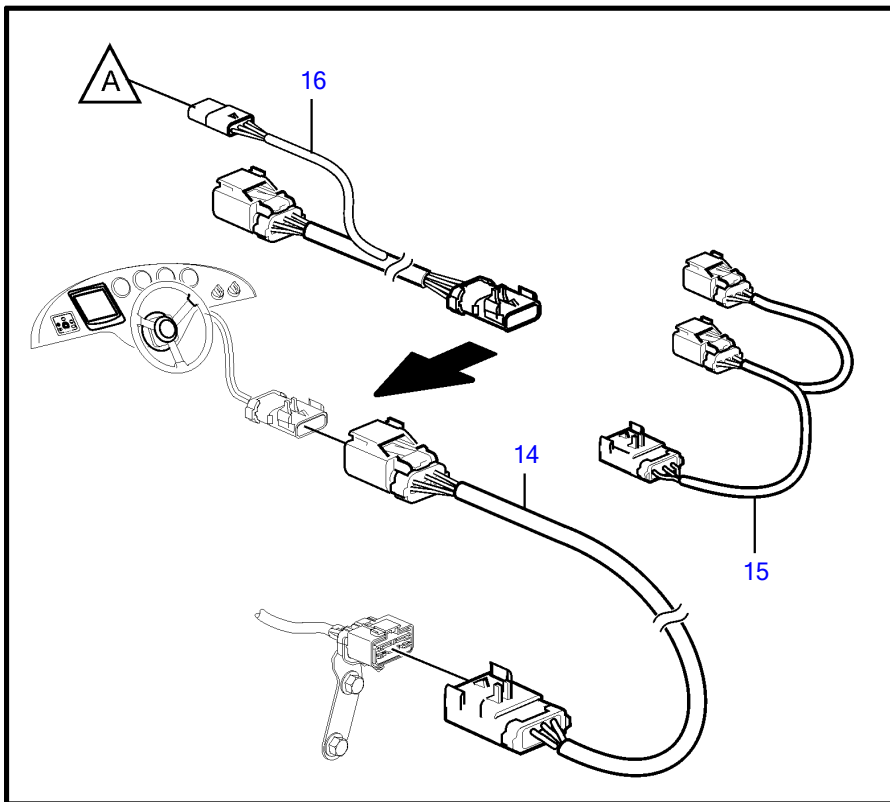
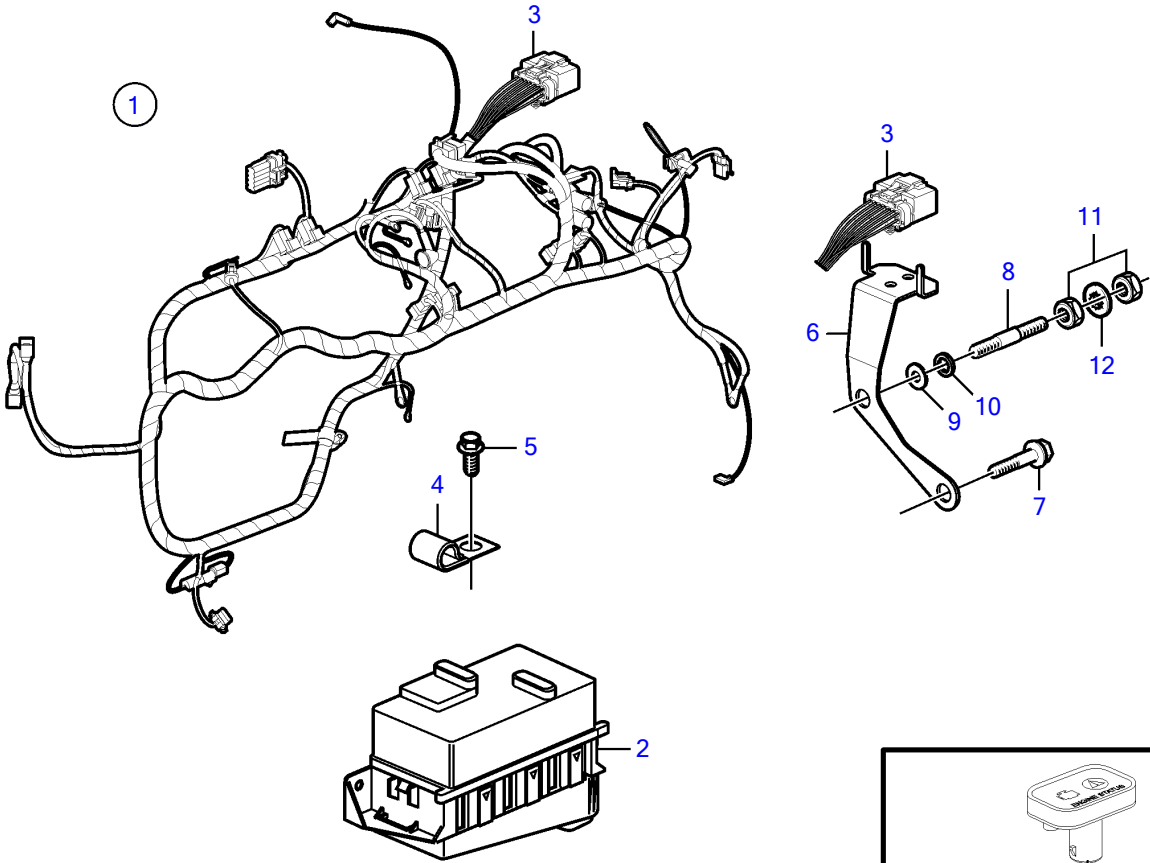

V8-380-C-A, V8-380-C-B

REF	PART NO.	QTY	DESCRIPTION	SEE SEC.	NOTES
1	21533267	1	Wiring harness		
2		1	• Fuse box	36998	not sold separately
3		1	• Connector, 14 pin		not sold separately
4	3852092	2	Attaching clamp, J		D=.500" (12.7mm)
	3852434	2	Clamp, J		D=.750" (19.0mm)
5	946441	1	Flange screw		
	3595499	1	Flange screw		
6		1	Bracket		
7	946441	1	Flange screw		Starboard, starter lead
8	3857937	1	Stud, ground		Port, cam sensor lead
9	980933	1	Washer		
10	3852046	1	Spring washer		
11	971071	2	Hexagon nut		
12	982679	2	Toothed washer		
13	21178777	1	Wiring harness		for alarm panel
14	21147169	1	Wiring harness		L=3.0m, 10 ft.
	21147170	1	Wiring harness		L=6.0m, 19.7 ft.
	21147171	1	Wiring harness		L=8.0m, 26.2 ft.
15	3887733	1	Wiring harness, y		
16	21200148	1	Wiring harness, y		for alarm panel