

V8-225-C-A, V8-300-C-A, V8-320-C-A

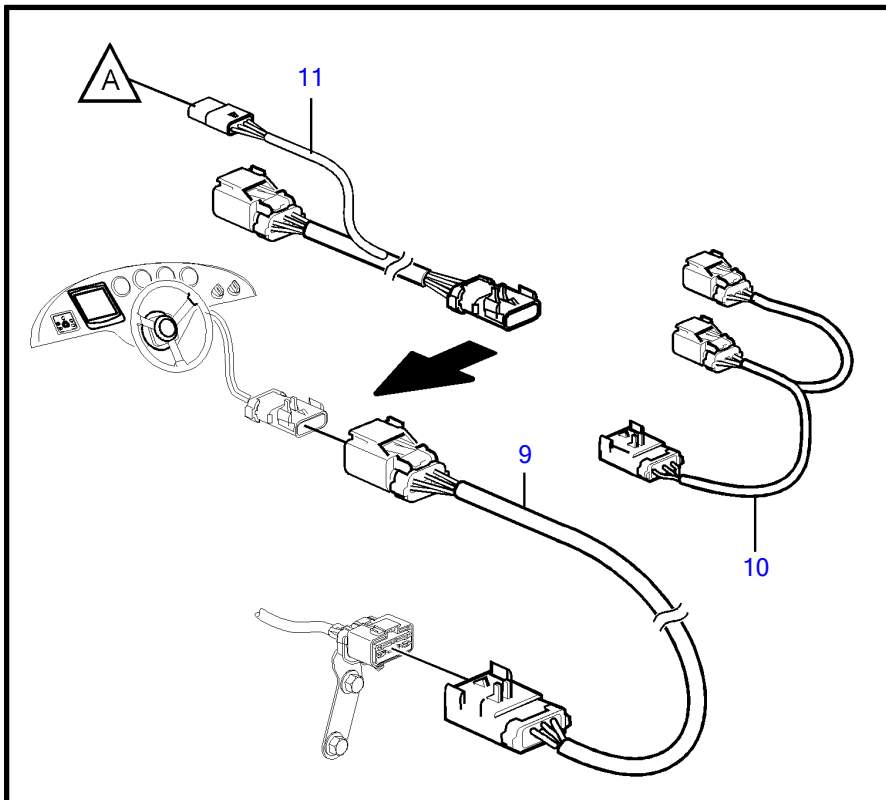
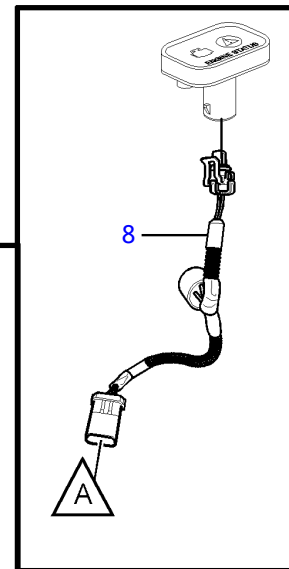
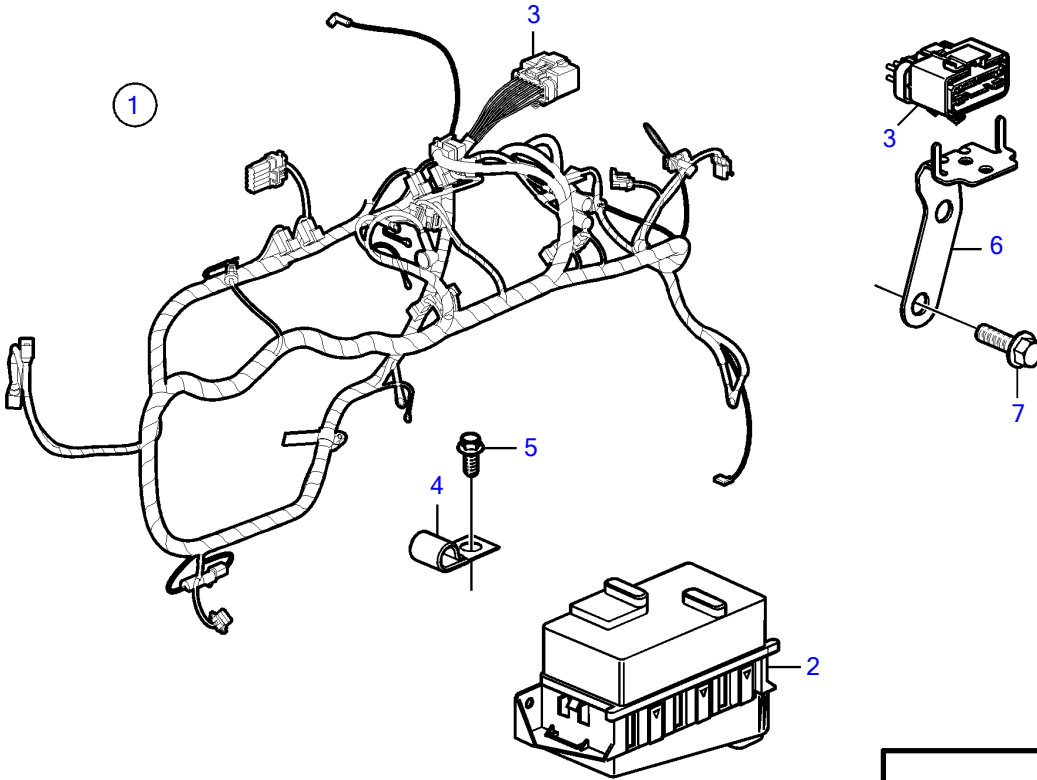

25734

V8-225-C-A, V8-300-C-A, V8-320-C-A

REF	PART NO.	QTY	DESCRIPTION	NOTES
1	21512118	1	Wiring harness	
2		1	• Fuse box	not sold separately
3		1	• Connector, 14 pin	not sold separately
4	(3852146)	2	Clamp, J	Obsolete part, D=.375" (9.5mm)
	3852434	2	Clamp, J	D=.750" (19.0mm)
	3852490	1	Attaching clamp	
5	(3853557)	2	Flange screw	Obsolete part, 3/8" - 16 unc, L=0.75" (19mm)
6	3884234	1	Bracket	
7	(3853557)	2	Flange screw	Obsolete part, 3/8" - 16 unc, L=0.75" (19mm)
8	21178777	1	Wiring harness	for alarm panel
9	21147169	1	Wiring harness	L=3.0m, 10 ft.
	21147170	1	Wiring harness	L=6.0m, 19.7 ft.
	21147171	1	Wiring harness	L=8.0m, 26.2 ft.
10	3887733	1	Wiring harness, y	
11	21200148	1	Wiring harness, y	for alarm panel