

MB10A

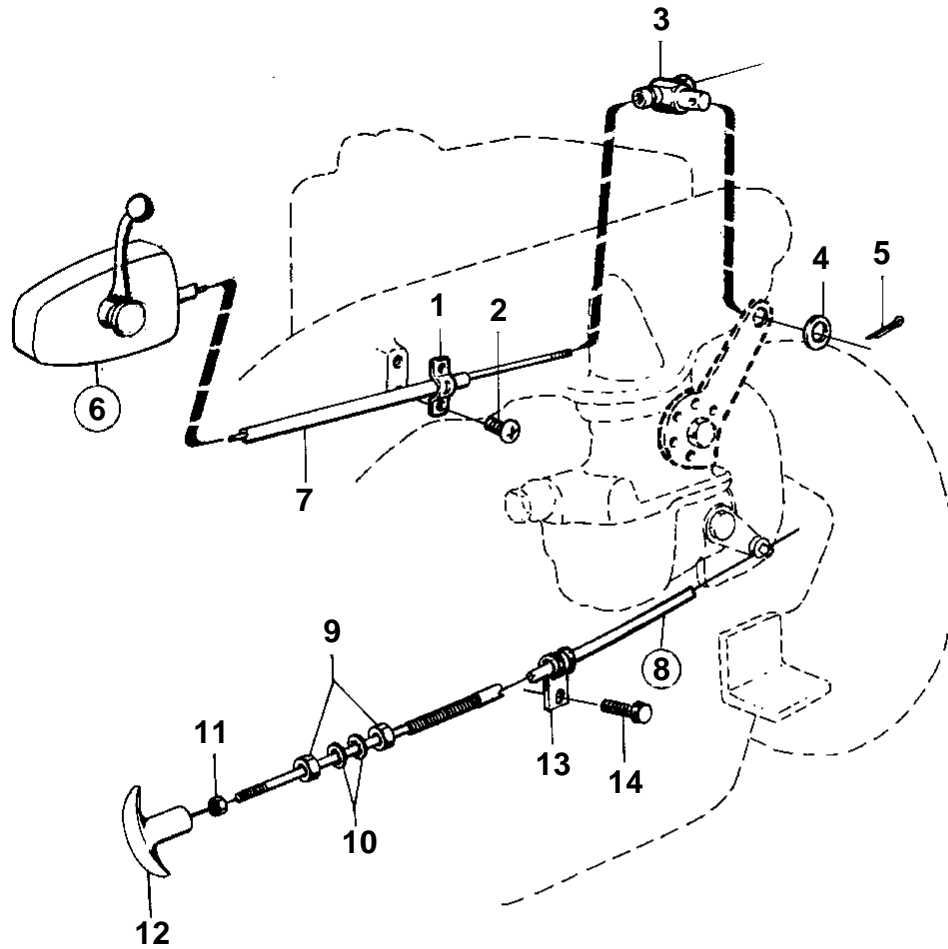

3201

MB10A

REF	PART NO.	QTY	DESCRIPTION	NOTES
1	21471054	1	Bracket	
2		2	Cross recessed screw	
3		1	Cube	
4	940191	1	Washer	
5	17253	1	Split pin	
6		X	CONTROL	SEE GROUP 9
7		X	CONTROL CABLE	SEE GROUP 9
8		1	Push pull control	L = 3300 MM
	818470	1	Push pull control	L = 6900 MM
9	955857	2	• Hexagon nut	
10	955950	2	• Toothed washer	
11	955844	1	• Hexagon nut	
12	829241	1	• Handle	
13	952622	1	Clamp	
14	955511	1	Hexagon screw	