

COMMON

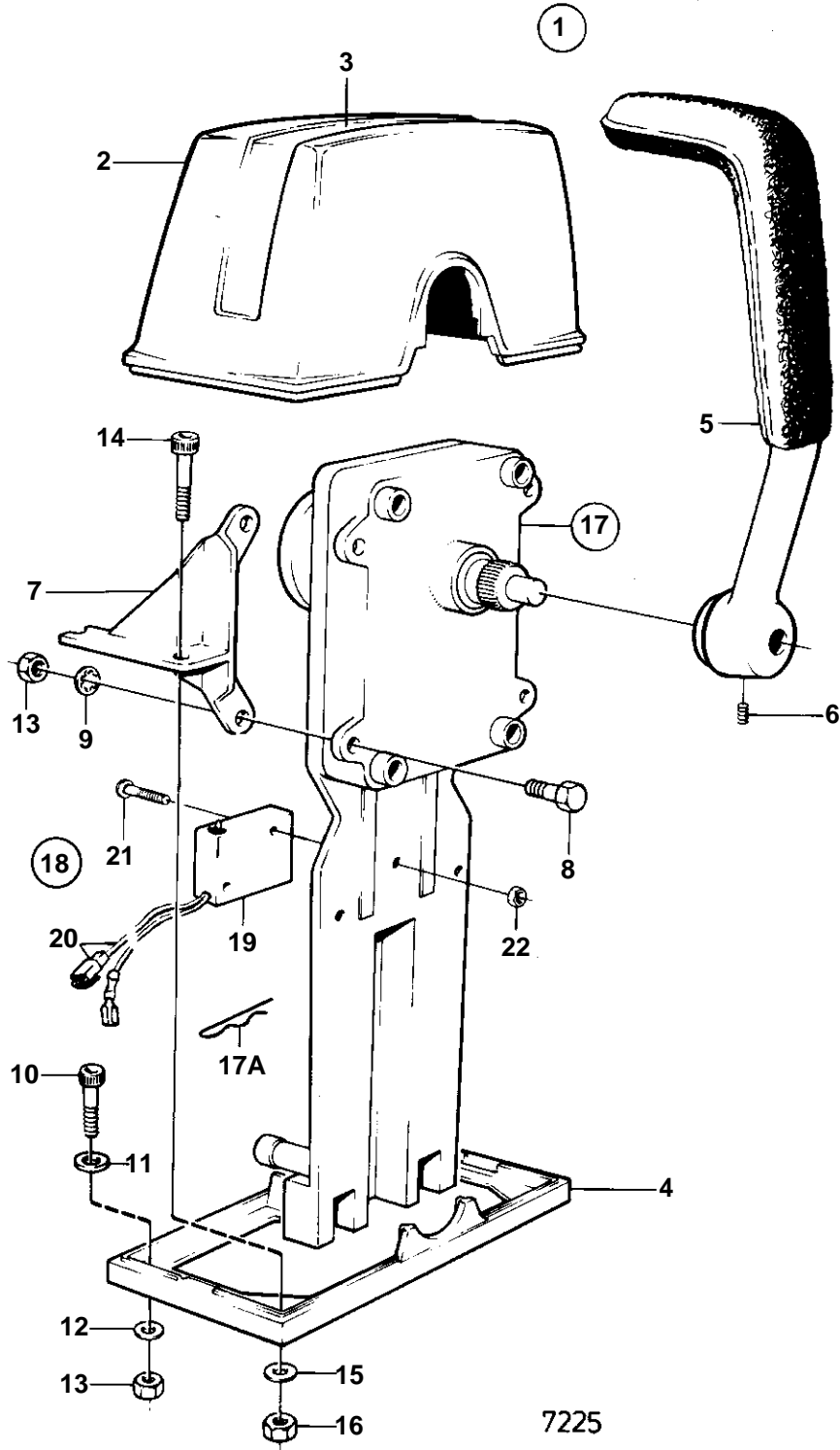

COMMON

| REF | PART NO. | QTY | DESCRIPTION | SEE SEC. | NOTES |
|-----|----------|-----|--------------------------|----------|-----------------|
| 1 | 851602 | 2 | Mounting kit | | |
| 2 | 839472 | 2 | · Cover | | |
| 3 | 851004 | 2 | · Decal | | |
| 4 | 839474 | 2 | · Plate | | |
| 5 | 839475 | 2 | · Lever | | |
| 6 | 839693 | 2 | · Lock screw | | M8 |
| 10 | 947671 | 4 | · Allen head screw | | |
| 11 | 940090 | 4 | · Washer | | |
| 12 | 960138 | 4 | · Washer | | |
| 13 | 955780 | 4 | · Nut | | |
| 14 | 947671 | 4 | · Allen head screw | | |
| 15 | 960138 | 4 | · Washer | | |
| 16 | 955780 | 4 | · Nut | | |
| 17 | 851600 | 2 | Control | 090-0280 | |
| 17A | 852924 | 1 | · Clip | | |
| 18 | 841165 | 1 | Switch | | MAIN STATION. |
| | 841166 | 1 | Switch | | SECOND STATION. |
| 19 | 850200 | 2 | · Switch | | |
| 20 | | X | · · CABLES AND TERMINALS | | SEE GROUP 3 |
| 21 | 946177 | 4 | · Screw | | |
| 22 | 947536 | 4 | · Nut | | |