

AQ231A, AQ231B

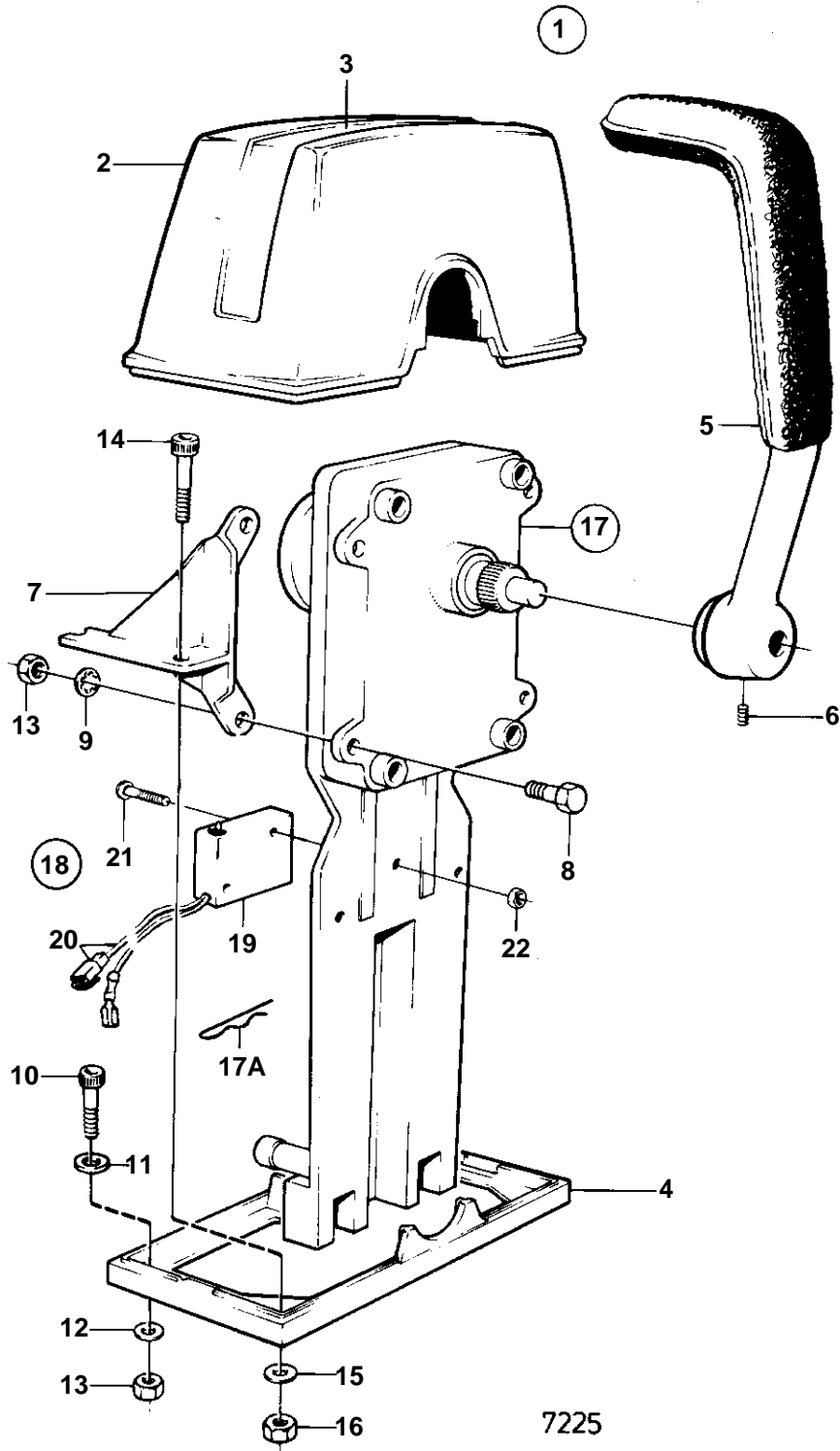

AQ231A, AQ231B

REF	PART NO.	QTY	DESCRIPTION	NOTES
1	851602	1	Mounting kit	
2	839472	1	• Cover	
3		1	• Decal	
4	839474	1	• Plate	
5	839475	1	• Hand lever	
6	839693	1	• Lock screw	M8
10	947671	2	• Hex. socket screw	
11	940090	2	• Washer	
12	960138	2	• Washer	
13	955780	2	• Hexagon nut	
14	947671	2	• Hex. socket screw	
15	960138	2	• Washer	
16	955780	2	• Hexagon nut	
17	851600	1	Control	
17A	852924	1	• Clip	
18	855352	1	Neutral position con	MAIN STATION., (841165)
19	850200	1	• Toggle switch	
20		X	• • CABLES AND TERMINALS	SEE GROUP 3
21	946177	2	• Cross recessed screw	
22	947536	2	• Hexagon nut	