

COMMON

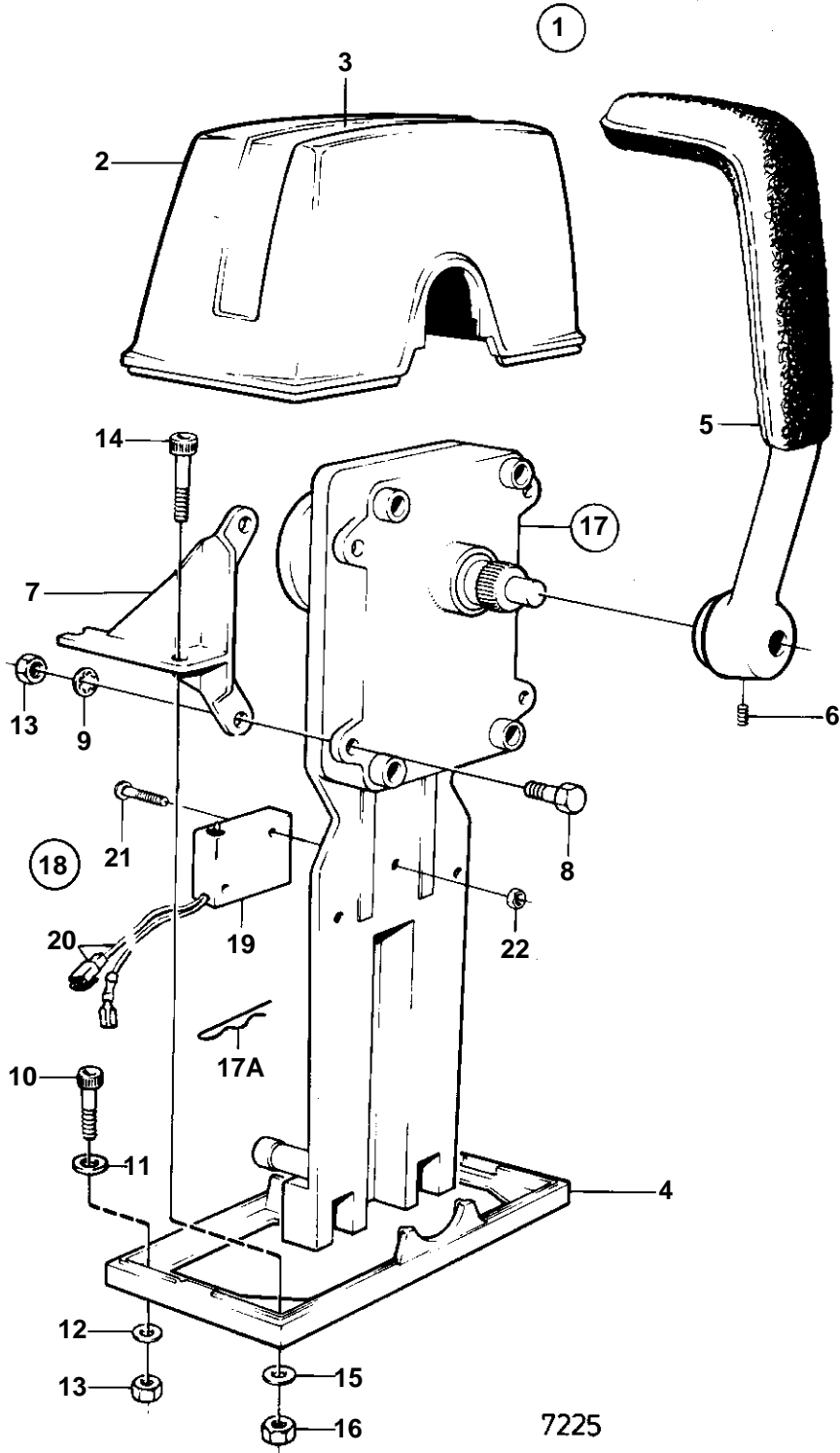

COMMON

| REF | PART NO. | QTY | DESCRIPTION | SEE SEC. | NOTES |
|-----|----------|-----|--------------------------|----------|-------------------------|
| 1 | 839470 | 2 | Mounting kit | | REPL BY 851602 |
| 2 | 839472 | 2 | · Cover | | |
| 4 | 839474 | 2 | · Plate | | |
| 5 | 839475 | 2 | · Lever | | |
| 6 | 946786 | 2 | · Lock screw | | M5 |
| | 839693 | 2 | · Lock screw | | M8 |
| 7 | 839480 | 2 | · Bracket | | MARKED 839480 |
| | 839481 | 2 | · Bracket | | MARKED 839481 |
| 8 | 955244 | 8 | · Screw | | |
| 9 | 955946 | 8 | · Lock washer | | |
| 10 | 947671 | 4 | · Allen head screw | | |
| 12 | 960138 | 4 | · Washer | | |
| 13 | 955780 | 12 | · Nut | | |
| 14 | 947672 | 4 | · Allen head screw | | |
| 15 | 960139 | 4 | · Washer | | |
| 16 | 955781 | 4 | · Nut | | |
| 17 | 839469 | 2 | Control | | REPL BY 851600 |
| | | | | 090-0280 | |
| 18 | 855352 | 1 | Neutral posit contac | | (841165). MAIN STATION. |
| | 855352 | 1 | Neutral posit contac | | SECOND STATION. |
| 19 | 850200 | 2 | · Switch | | |
| 20 | | X | · · CABLES AND TERMINALS | | SEE GROUP 3 |
| 21 | 946177 | 4 | · Screw | | |
| 22 | 947536 | 4 | · Nut | | |