

AQ200D

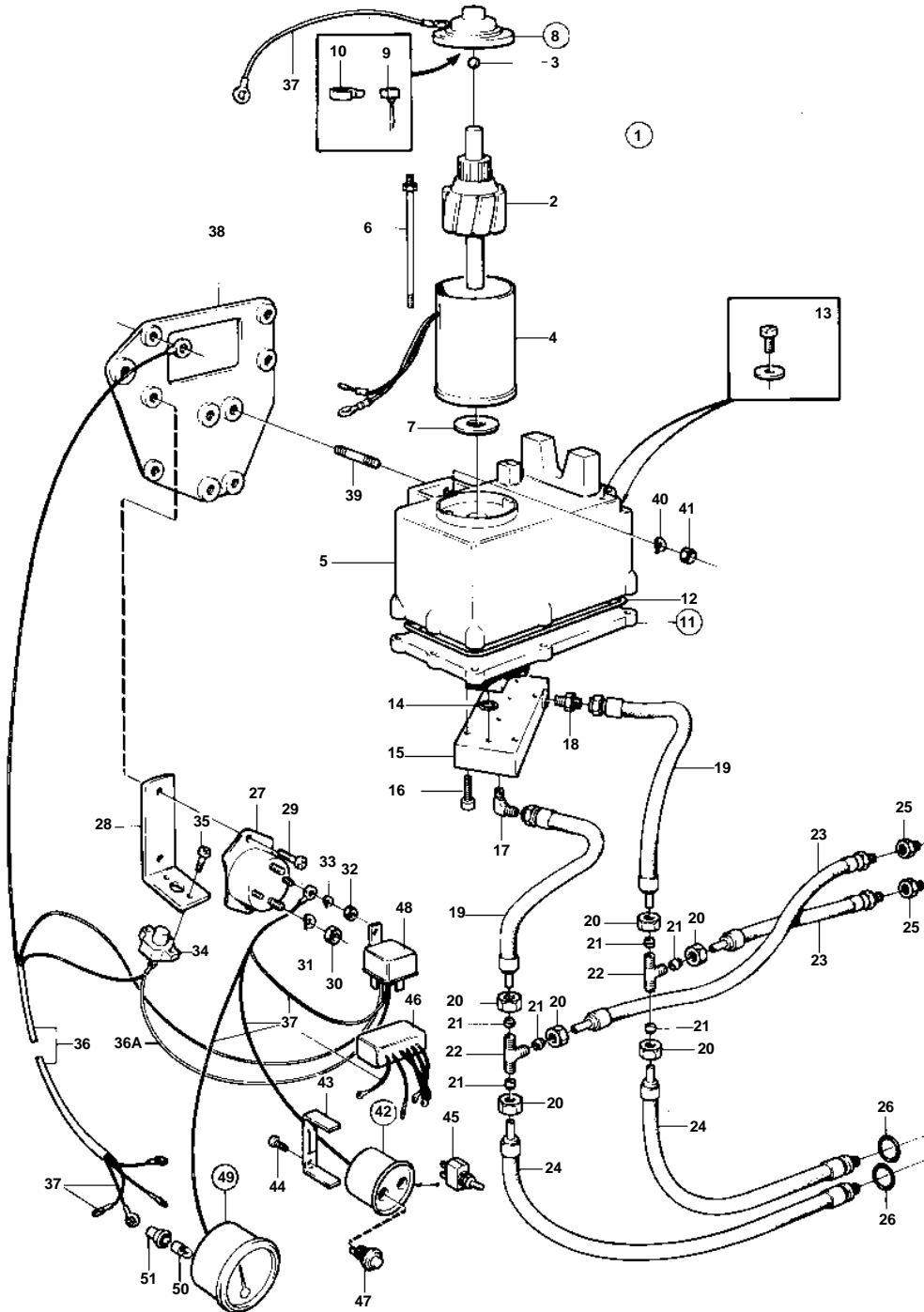

7566

## AQ200D

REF	PART NO.	QTY	DESCRIPTION	SEE SEC.	NOTES
1	850922	1	Hydraulic pump		REPLACED BY HYDRAULIC PUMP 852500 + BRACKET 852568 + 4EA SCREW 950161 + 4EA NUT 955826.
2		1	• Rotor		
3		1	• Ball		
4		1	• Housing		
5		1	• Oil reservoir		
6		1	• Screw kit		
7		X	• Thrust washer kit		
8		1	• Housing		
9		1	• • Carbon brush set		
10		2	• • Spring kit		
11		1	• Pump unit		
12		1	• • Sealing ring		
13		1	• Screw kit		
14		1	• O-ring		
15	851082	1	• Valve housing		REPLACED BY HYDRAULIC PUMP 852500 + BRACKET 852568 + 4EA SCREW 950161 + 4EA NUT 955826.
16		4	• Screw		
17	850916	1	Elbow nipple		
18	850903	1	Tube fitting		
19		2	Hose		
20	941521	9	Fitting nut		
21	956967	6	Ferrule		
22	964034	2	T-nipple		
23	850909	2	Hose		
24	850908	2	Hose		
25	851042	2	Nipple	17092	
26	941820	2	O-ring	17092	
27	852565	2	Relay		
28		1	Bracket		
29	950046	3	Cross recessed screw		
30	955834	4	Hexagon nut		
31	941907	4	Spring washer		
32	955844	4	Hexagon nut		
33	941905	4	Spring washer		
34	841178	1	Automatic fuse		40AMP
35	950013	2	Cross recessed screw		
36		1	Cable trunk		
36A		1	Cable trunk		
37		X	CABLE AND CABLE TERMINALS		SEE GROUP 3
38	850803	1	Bracket		REPLACED BY 1EA BRACKET 852568, 4EA SCREW 950161 AND 4EA NUT 955826.
39	941872	4	Stud		
40	941906	4	Spring washer		
41	955825	4	Hexagon nut		
42		1	Instrument panel		EXCL USA MO-893180., USA
		1	Instrument panel		EXCL USA MO 893181-., EXCL USA
43	850372	1	• Attaching brace		
44	944201	2	• Cross recessed screw		
45	814322	1	• Toggle switch		
46	851771	1	• Trimming limiter		MO893181-
47	852026	1	• Switch		MO893181-
48	876040	1	• Relay kit		MO893181-
49	851502	1	• Trim indicator		INCLUDED ONLY IN 851501., EXCL USA MO893181-
50	192451	1	• • Bulb		
51	841954	1	• • Lamp socket		