

AQ200D

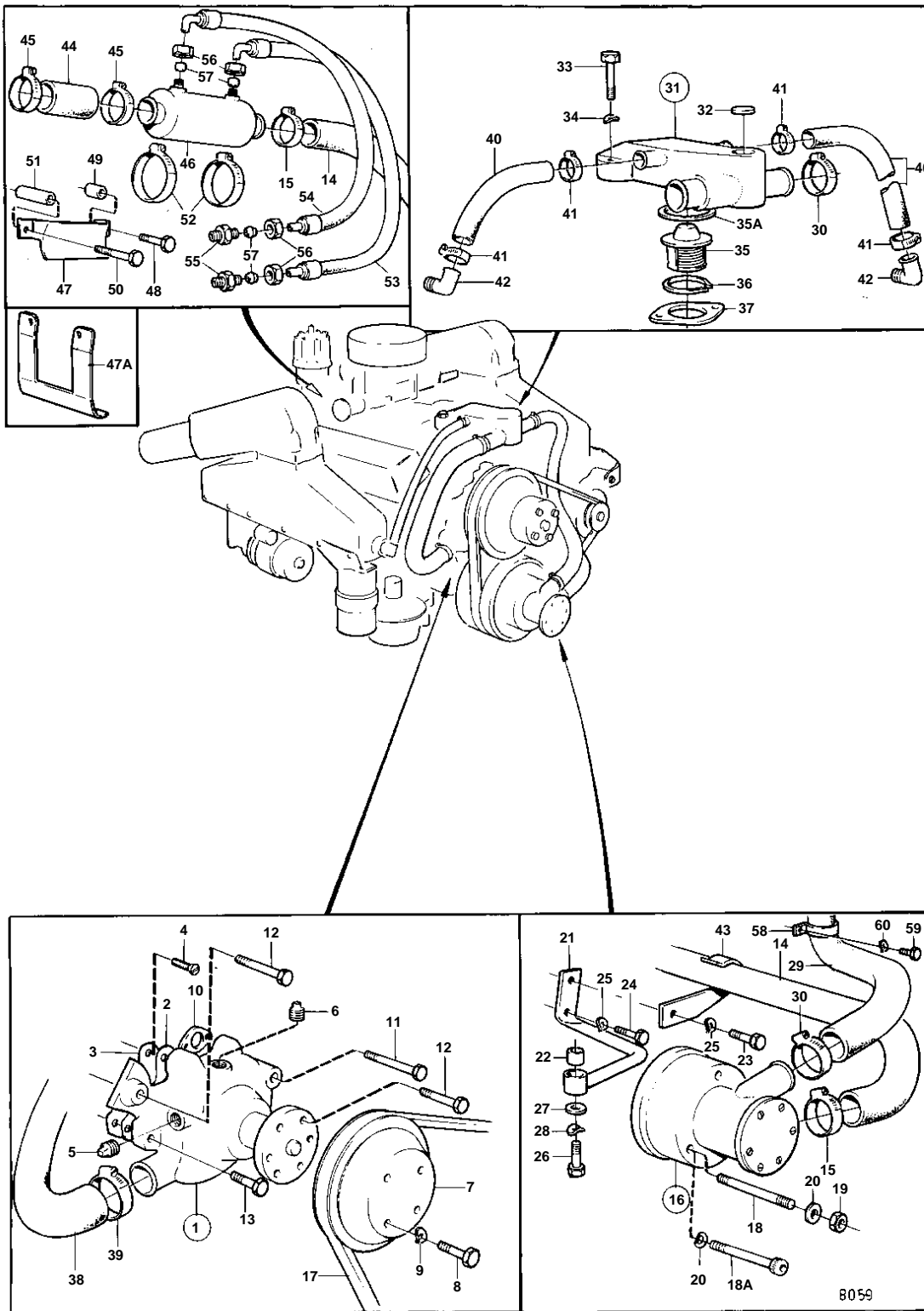

AQ200D

REF	PART NO.	QTY	DESCRIPTION	SEE SEC.	NOTES
1	835390	1	Water pump		
2	841036	1	· Gasket		
3		1	· Plate		
4	841426	6	· Screw		
5	952358	1	· Plug		
6	952359	1	· Plug		
7	855283	1	Pulley		
8	955655	4	Hexagon screw		
9	941907	4	Spring washer		
10	835210	2	Gasket		
11	940162	1	Hexagon screw		
12	955536	2	Hexagon screw		
13	955540	1	Hexagon screw		
14	834770	1	Hose		FOR ENGINE WITH DRIVE UNIT 280.
	855373	1	Hose		FOR ENGINE WITH DRIVE UNIT 290.
15	961669	2	Hose clamp		
16	826456	1	Sea water pump		REPL. BY 1EA 841640, 3EA 948324, 3EA 955894 AND 3EA 942336.
				17065	
	841640	1	Sea water pump		
				17065	
17	958498	1	V-belt		
18	826500	3	Stud		EARLY TYPE
18A	948324	3	Hex. socket screw		LATE TYPE
19		3	Lock nut		
20	941907	3	Spring washer		EARLY TYPE
	942336	3	Spring washer		LATE TYPE
21	826421	1	Torque rod		
22	826422	1	Rubber bushing		
23	940115	1	Hexagon screw		
24	955534	1	Hexagon screw		SEE GROUP 3
25	942336	2	Spring washer		
26	955523	1	Hexagon screw		
27	960141	1	Washer		
28	941907	1	Spring washer		
29	826423	1	Hose		
30	961669	2	Hose clamp		
31	841923	1	Thermostat housing		REPLACED BY 1EA 855485 THERMOSTAT HOUSING, 1EA 855486 CIRCLIP AND 1EA 1317466 SEAL RING., EARLY TYPE
	855485	1	Thermostat housing		LATE TYPE
32	192426	1	· Expansion plug		
33	955537	2	Hexagon screw		
34	942336	2	Spring washer		
35	875794	1	Thermostat kit		
35A	416033	1	Sealing ring		LATE TYPE (1317466)
36	835552	1	Lock ring		EARLY TYPE
	855486	1	Lock ring		LATE TYPE
37	835417	1	Gasket		
38	834906	1	Hose		
39	961671	2	Hose clamp		
40	952970	X	Hose		L = 2X350 MM
41	841037	4	Hose clamp		
42	961610	2	Hose nipple	17061	
43	834974	1	Clamp		FOR ENGINE WITH DRIVE UNIT 280.
		1	Clamp		FOR ENGINE WITH DRIVE UNIT 290.
		1	Clamp		FOR ENGINE WITH DRIVE UNIT 290., INSTALLS ON THE FLYWHEEL COVER.
44			HOSE		EXCL AQ200D
45			CLAMP		EXCL AQ200D
46			OIL COOLER		EXCL AQ200D
47			BRACKET		EXCL AQ200D
47A			BRACKET		EXCL AQ200D
48			SCREW		EXCL AQ200D
49			SPACER SLEEVE		EXCL AQ200D

AQ200D

REF	PART NO.	QTY	DESCRIPTION	SEE SEC.	NOTES
50			SCREW		EXCL AQ200D
51			SPACER SLEEVE		EXCL AQ200D
52			HOSE CLAMP		EXCL AQ200D
53			HOSE		EXCL AQ200D
54			HOSE		EXCL AQ200D
55			NIPPLE		EXCL AQ200D
56			NUT		EXCL AQ200D
57			FERRULE		EXCL AQ200D
58	841307	1	Clamp		
59	955534	1	Hexagon screw		
60	942336	1	Spring washer		