

AQ200C, AQ225C

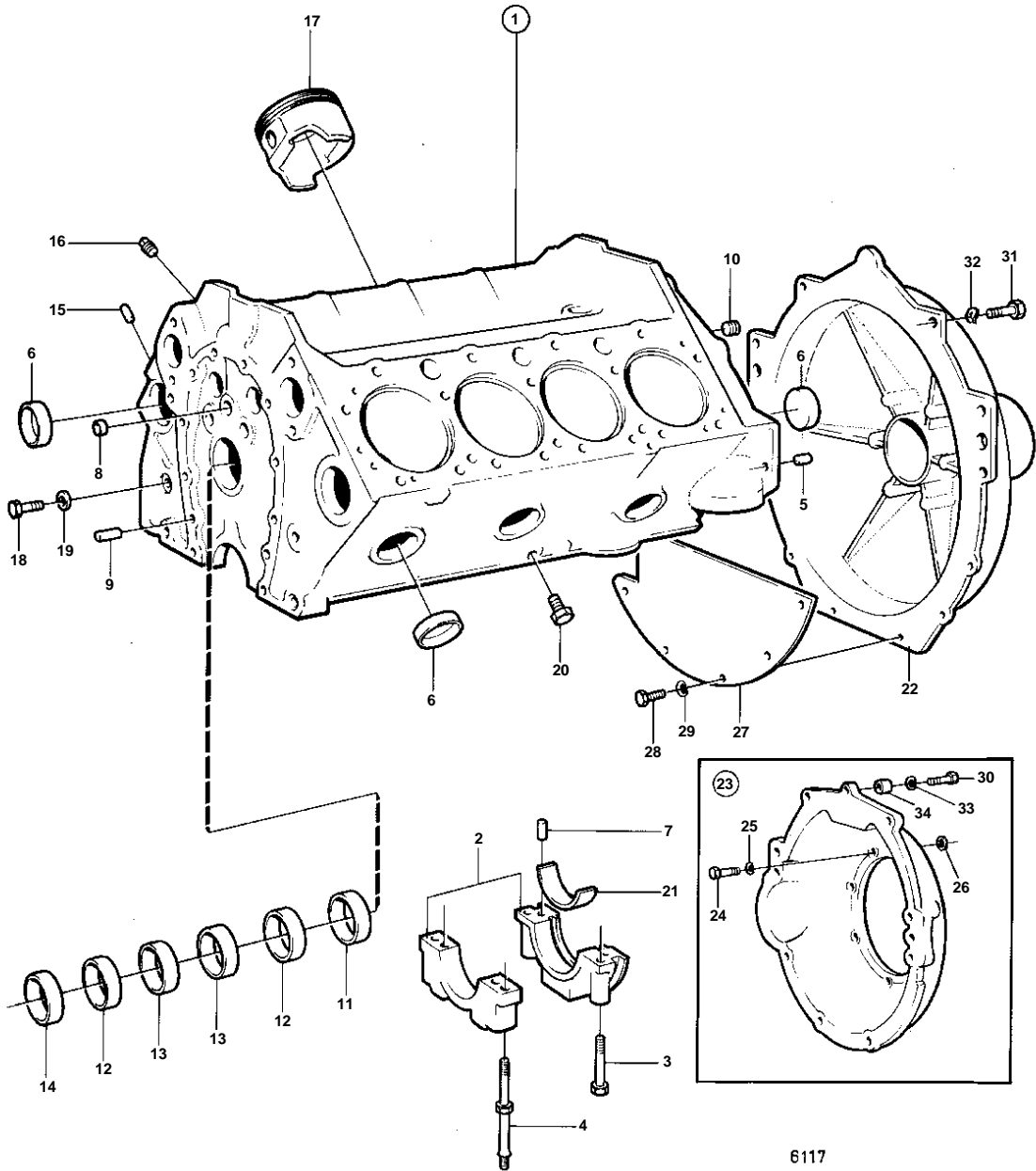

## AQ200C, AQ225C

REF	PART NO.	QTY	DESCRIPTION	SEE SEC.	NOTES
1		1	Cylinder block		
2		5	· BEARING CAP		
3	835037	10	· Screw		
4	835038	5	· Stud	13097	
5		2	· Locating pin		
6	835039	8	· Plug		
7	835040	2	· Locating pin		
8		4	· Plug		
9	835040	2	· Locating pin		
10	952075	5	· Plug		
11	835496	1	· Plug		
12	841423	2	· Bushing		
13	841424	2	· Bushing		
14	841422	1	· Bearing		
15	835497	4	· Locating pin		
16	952069	1	· Plug		
17	826465	8	· Piston	13090	
18	940133	1	· Hexagon screw		
19	18651	1	· Gasket		
20	192134	2	· Plug		
21			· MAIN BEARING KIT	13090	
23	839484	1	Flywheel housing		
24	955551	6	· Hexagon screw		
25		6	· Washer		
26	951075	6	· Snap ring		
27		1	Protecting plate		
28	955512	5	Hexagon screw		
29	940135	5	Hexagon screw		
30	955537	1	Hexagon screw		L = 51 MM
31	940162	5	Hexagon screw		L = 38 MM
32	942336	6	Spring washer		
33	940097	3	Washer		
34		1	Spacer sleeve		