

AQ130A,AQ130B,AQ130C,AQ130D

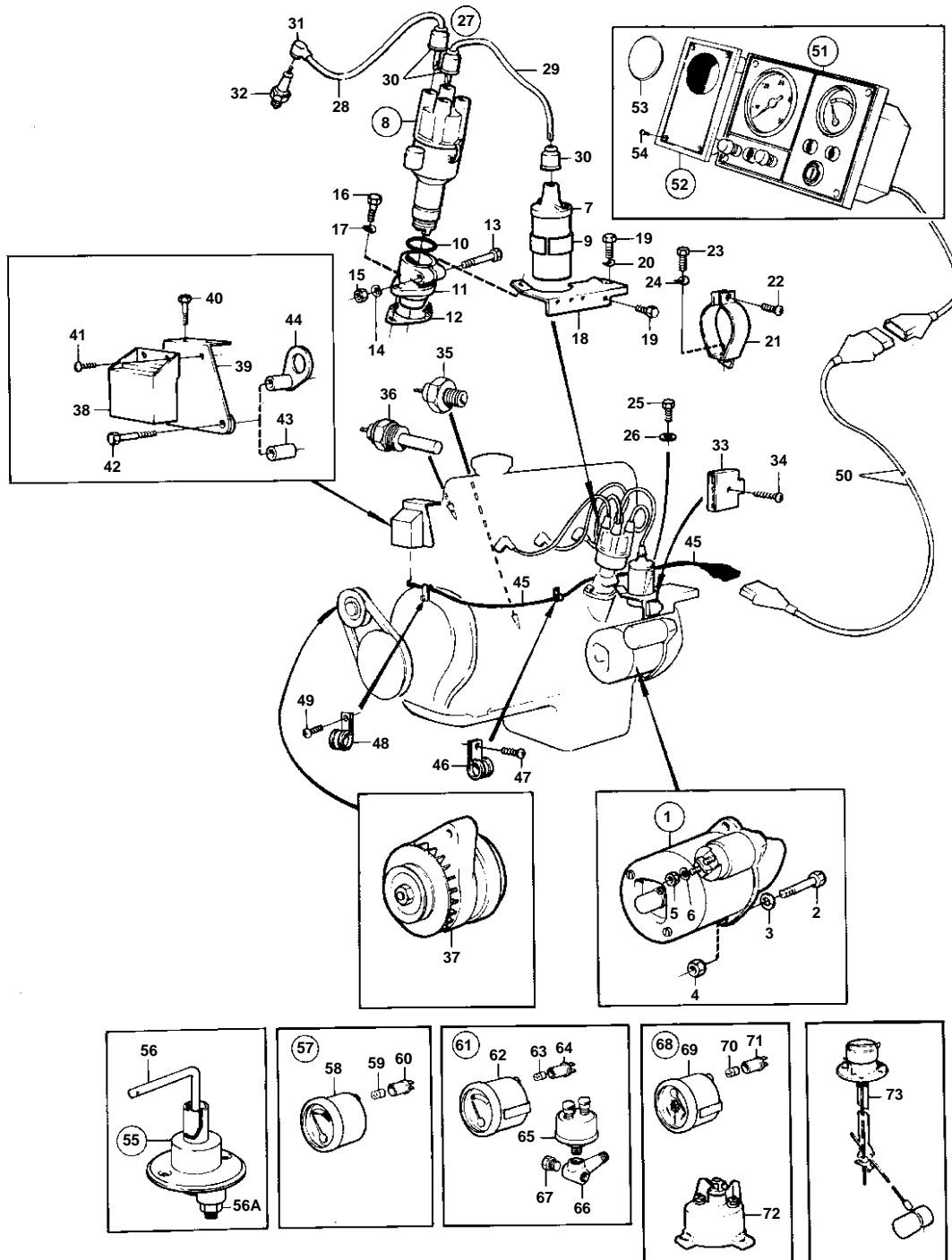

6104

AQ130A,AQ130B,AQ130C,AQ130D

REF	PART NO.	QTY	DESCRIPTION	SEE SEC.	NOTES
1	870977	1			POUR SECTION CABLE 0,5-1,5 MILLIM%ETRE-CARR%E1
				030-1450	
	834339	1	Starter motor		MOXXXX/114815-
	3803074	1	Starter motor, exch		Exchange unit
				030-1460	
2	940184	2	Screw		
3	955896	2	Washer		
4	940157	2	Nut		
5	955782	1	Nut		
6	941907	1	Spring washer		
7		1	IGNITION COIL		MO-XXXX/120676. FOR CABLE AREA 0,75-2,0 SQMM.
	834462	1	Ignition coil		MOXXXX/120677-
8	241531	1	Distributor		ALT. FOR CABLE AREA 1,5-2,5 SQMM.. FOR CABLE AREA 6,5-10,5 SQMM.
				030-0650	
	834465	1	Distributor		ALT. FOR CABLE AREA 10,5-16,0 SQMM.
				030-0650	
9	834530	1	Intermediate ring		MO-XXXX/120676
10	925060	1	O-ring	IK	
11	418276	1	Flange		
12	418265	1	Gasket	IK	
13	955515	1	Screw		
14	941906	1	Spring washer		
15	955825	1	Nut		
16	955524	2	Screw		
17	941907	2	Spring washer		
18		1	BRACKET		FOR CABLE AREA 3,0-6,0 SQMM.
	824862	1	Bracket		MO-XXXX/103956
	831866	1	Bracket		MOXXXX/103957-
19	955524	2	Screw		MO-XXXX/103956
20	941907	1	Spring washer		MO-XXXX/103956
21	831867	1	Clamp, CLAMP		MOXXXX/103957-
					MO-XXXX/120676
	834460	1	Clamp		MOXXXX/120677-
22	834371	1	Screw		MOXXXX/103957-
23	955524	1	Screw		MOXXXX/103957-
24	955894	1	Washer		MOXXXX/103957-
25	940113	1	Screw		MOXXXX/103957-
26	941907	1	Spring washer		MOXXXX/103957-
27	875363	1	Ignition cable kit		
28		4	· IGNITION CABLE	IK	
29		1	· IGNITION CABLE	IK	
30	241608	6	· Protective sleeve	IK	
31	956913	4	· Cable terminal	IK	
32	875803	1	Spark plug kit		(241627)
33		1	FUSE BOX		EARLY TYPE. FOR CABLE AREA 16 SQ MM.
	824823	1	Fuse box		LATE TYPE
34	831837	2	Screw		EARLY TYPE
	831837	1	Screw		LATE TYPE
35	1266085	1	Pressure switch		(672910)
36	824552	1	Temperature sensor		
37		1	ALTERNATOR AND INSTALLATION COMPONENTS	030-0800	
38		1	CHARGING RELAY BRACKET		MO-XXXX/75892. REPLACED BYLATE TYPE 845108.
39	824592	1	Bracket		MO-XXXX/75892
40	955528	2	Screw		SEE GROUP 2B
41	950019	3	Screw		MO-XXXX/75892
42	955539	1	Screw		MO-XXXX/75892

7736850 - 030 - 030-0200

6104

Upd: 22 NOV 2005

AQ115, BB115, MB20, AQ130, AQ165, BB165, AQ170, BB170, AQD21A, MD21A

VOLVO
PENTA

AQ130A,AQ130B,AQ130C,AQ130D

REF	PART NO.	QTY	DESCRIPTION	SEE SEC.	NOTES
43	824754	1	Tube		EARLY TYPE. AQ200D MO-11576, AQ225D MO-11736, AQ260A MO-11506, AQ290A MO-12259.
44	824736	1	Lifting eye, LIFT EYE		LATE TYPE. AQ200D MO-11576, AQ225D MO-11736, AQ260A MO-11506, AQ290A MO-12259.. AQ200D MO 11577-, AQ225D MO 11737-, AQ260A MO 11507-, AQ290A MO12260-.
		1	LIFT EYE		MO-XXXX/75892
45	824934	1	Cable trunk		MO-XXXX/103956
	831863	1	Cable trunk		MO-XXXX/103957-
46	952627	1	Clamp		MO-XXXX/103956
47	950046	1	Screw		MO-XXXX/103956
48	946834	2	Clamp		MO-XXXX/103956
	946834	1	Clamp		MO-XXXX/103957-
49	950059	2	Screw		MO-XXXX/103956
	950059	1	Screw		MO-XXXX/103957-
50	825738	X	Cable trunk		L = 2500 MM
	820419	X	Cable		L = 7000 MM
		X	LIFT DEVICE		SEE GROUP 4A, 9
51	824595	1	Instrument panel, INSTRUMENT PANEL SINGLE INSTALLATION		EARLY TYPE
				030-1750	
	824596	1	Instrument panel, INSTRUMENT PANEL TWIN INSTALLATION		EARLY TYPE
			COMPONENTS		SEE GROUP 9
	831482	1			MO-XXXX/114815. REPLACED BY 1EA 846622 FLOW SWITCH AND 1EA 846632 NIPPLE.. ACC. TO CLASSIFICATION.
				030-1800	
	831994	1	Instrument panel		MO-XXXX/114815-. ACC. TO CLASSIFICATION.
				030-1800	
52	840013	1	Instrument panel		
53	839128	1	• Plug		
54	944540	4	• Screw		
55	870980	1	Switch		
56	243700	1	• Handle		
56A	955783	2	• Nut		
57	834397	1	Voltmeter		12V
58	834374	1	• Voltmeter		
59	19923	1	• Bulb		
60	808175	1	• Bulb socket		
61	834398	1	Instrument		
62	834376	1	• Instrument		
63	19923	1	• Bulb		
64	808175	1	• Bulb socket		
65	881432	1	• Pressure sensor		
66	834391	1	• Nipple		
67	191026	1	• Plug		
68	834401	1	Rudder indicator		
69	834383	1	• Rudder indicator		
70	19923	1	• Bulb		
71	808175	1	• Bulb socket		
72	837772	1	• Rudder position sens		
73	834400	1	Tank gauge		SEE GROUP 9
			DRINKING WATER		
	834399	1	Tank gauge		SEE GROUP 9
			FUEL		