

AQ170A, AQ170B

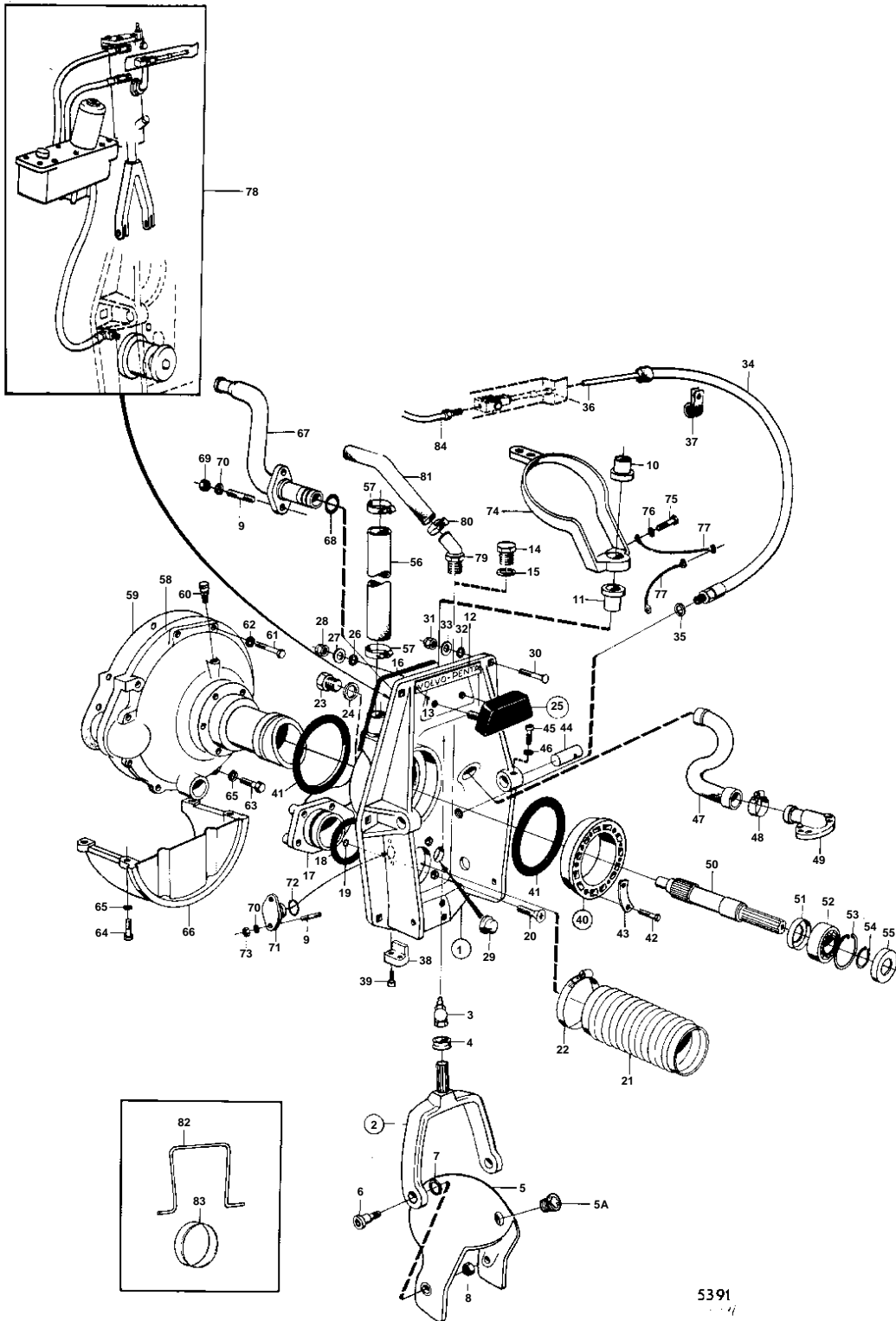

5391

AQ170A, AQ170B

REF	PART NO.	QTY	DESCRIPTION	SEE SEC.	NOTES
1		1	Shield		
2		1	• Steering yoke		
3	914169	1	• • Lubricating nipple		
4	839195	1	• • Ring		
			Bulletin 48-23	48-23-EN	Seal Ring
5		1	• Protective helmet		MO-XXXX/187079
	851267	1	• Protective helmet		MOXXXX/187080-
5A	851262	1	• • Bushing		FOR BEARING PIN WITH 2 BOLTS.
6		2	• Screw		
7		2	• Washer		
8		2	• Nut		
9	941872	4	• Stud		
10	832651	1	• Bushing		
11	832652	1	• Bushing		
12	832608	1	• Plate		
13	804269	2	• Drive screw		
14		1	• Plug		MOXXXX/94050-
15	897745	1	• Gasket		MOXXXX/94050-
16	897726	1	Sealing strip		
17		1	Hull fitting		
18	925256	1	O-ring		
19	925055	4	O-ring		
20		4	Screw		
21	897631	1	Exhaust bellows		270T
	850443	1	Exhaust bellows		280T
22	961675	2	Hose clamp		
23		1	Plug		
24	897745	1	Gasket		
25	875531	1	Rubber cushion		
26	832565	2	• Gasket		
27	940097	2	• Washer		(960142)
28	950364	2	• Lock nut		
29	814473	1	Rubber plug		
30	943426	6	Screw		
31	940176	6	Hexagon nut		
32	850418	6	O-ring		
33	190878	6	Washer		
34	839091	1	Protecting hose		
35	897745	1	Gasket		
36		1	Control cable		L = 1800 MM
37	952635	1	Clamp		
38	832934	2	Zinc electrode		
39	941809	4	Hex. socket screw		
40	806310	1	Mounting kit		
41	804190	2	• Rubber ring		
42	191844	6	• Hexagon screw		
43	806624	3	• Striker plate		
44		2	Pivot pin		
45	941873	2	Hex. socket screw		
46	941670	2	Washer		
47	832831	1	Hose		
48	961668	2	Hose clamp		
49	851766	1	Hose connection		SEE GROUP 4C
50		1	Shaft		
51	946242	1	Sealing ring		
52	11013	1	Ball bearing		
53	914533	2	Snap ring		
54	914462	1	Snap ring		
55	958860	1	Sealing ring		
56	952986	X	Hose		L = 170 MM SEE GROUP 2B
57	943482	2	Hose clamp		(951799) SEE GROUP 2B
58		1	Flywheel housing		

AQ170A, AQ170B

REF	PART NO.	QTY	DESCRIPTION	SEE SEC.	NOTES
59		1	Gasket		
60		1	Lubricator		
61	955549	2	Hexagon screw		L = 45 MM
	940160	2	Hexagon screw		L = 38 MM
62	941909	4	Spring washer		
63	940162	2	Hexagon screw		
64	955535	4	Hexagon screw		
65	942336	6	Spring washer		
66		1	Bracket		
67		1	Grommet		
68	925063	1	O-ring		
69	950352	2	Lock nut		
70	955893	4	Washer		
71		1	Seal flange		
72	925063	1	O-ring		
73	950352	2	Lock nut		
74		1	Spindle arm		
75	955537	1	Hexagon screw		
76	940097	1	Washer		
77		X	CABLES AND CABLE TERMINALS		SEE GROUP 3
78			HYDRAULIC SYSTEM AND INSTALLATION COMPONENTS	12880	
79	804429	1	Hose attachment		MOXXXX/94050-
80	943473	2	Hose clamp		(951789) MOXXXX/94050-
81	952969	X	Hose		L = 500 MM MOXXXX/94050-
82	897824	1	Transport lock		FOR TRANSPORT.
83	944738	1	Plug		FOR TRANSPORT.
84		X	CONTROL CABLE		SEE GROUP 9
	875192	1	Gasket kit		SEE GROUP 10