

MB20B

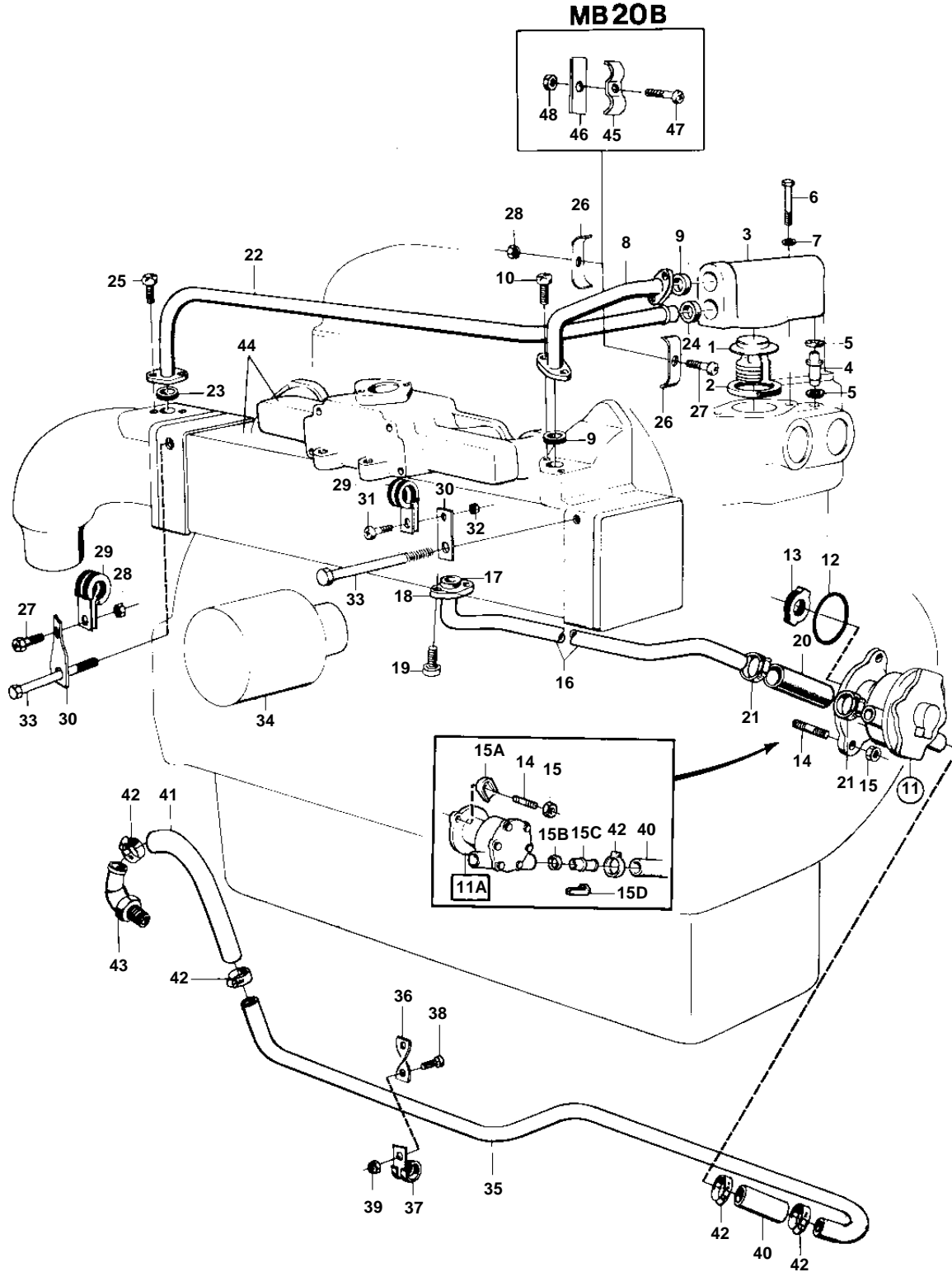

6353

MB20B

REF	PART NO.	QTY	DESCRIPTION	SEE SEC.	NOTES
1	829813	1	Thermostat		(824833)
2	416033	1	Sealing ring		(418361)
3		1	Thermostat housing		
4	806215	1	Tube		
5	829714	2	Sealing ring		
6	955528	2	Hexagon screw		
7	120265	2	Washer		
8		1	Coolant pipe		
9	418445	2	Sealing ring		
10	950046	4	Cross recessed screw		
11	825916	1	Water pump, COOLING WATER PUMP COOLING WATER PUMP		SHAFT AND SPACER RING 910396 REPLACES EARLY TYPE WITHOUT SPACER RING
11A	829895	1	Sea water pump		
12	925091	1	O-ring		
13	806256	1	Companion flange		
14		2	Stud		
15	950352	2	Lock nut		
15A	833878	2	Clamp		REPLACED BY 1EA 4804105, 1EA 350578.
15B	418411	2	Sealing ring		REPLACED BY 1EA 4804105, 1EA 350578.
15C	829901	2	Connection pipe		REPLACED BY 1EA 4804105, 1EA 350578.
15D	829898	2	Clamp		REPLACED BY 1EA 4804105, 1EA 350578.
16		1	Coolant pipe		
17	418445	1	Sealing ring		
18		1	Flange		
19	950046	2	Cross recessed screw		
20	952969	1	Hose		L = 55 MM
21	943473	2	Hose clamp		(951789)
22	824673	1	Pipe		
23	418445	1	Sealing ring		
24	418411	1	Sealing ring		
25	950046	2	Cross recessed screw		
29	952629	2	Clamp		
30		2	Anchorage		
31	950047	2	Cross recessed screw		
32	950352	2	Lock nut		
33	959793	2	Hexagon screw	12786	
34	1266286	1	Oil filter		SEE GROUP 2A
35		1	Coolant pipe		SPEC.9969, 867113.
36		1	Anchorage		SPEC.9969, 867113.
37	952631	1	Clamp		SPEC.9969, 867113.
38	950046	1	Cross recessed screw		SPEC.9969, 867113.
39	950352	1	Lock nut		SPEC.9969, 867113.
40	943368	X	Rubber hose		SPEC.9969, 867113., L = 50 MM
41	943368	X	Rubber hose		SPEC.9969, 867113., L = 225 MM
42	943472	4	Hose clamp		SPEC.9969, 867113.
43	804429	1	Hose attachment		SEE GROUP 4A
44					
45		2	Clamp		MO-XXXX/108911
46		2	Washer		MO-XXXX/108911
47	950046	2	Cross recessed screw		MO-XXXX/108911
48	950352	2	Lock nut		MO-XXXX/108911
	828065	1	Muffler, EXHAUST MUFFLER		SEE GROUP 9
		1	WATER COOLED EXHAUST LINE		SEE GROUP 9