

740A, 740A/MS5

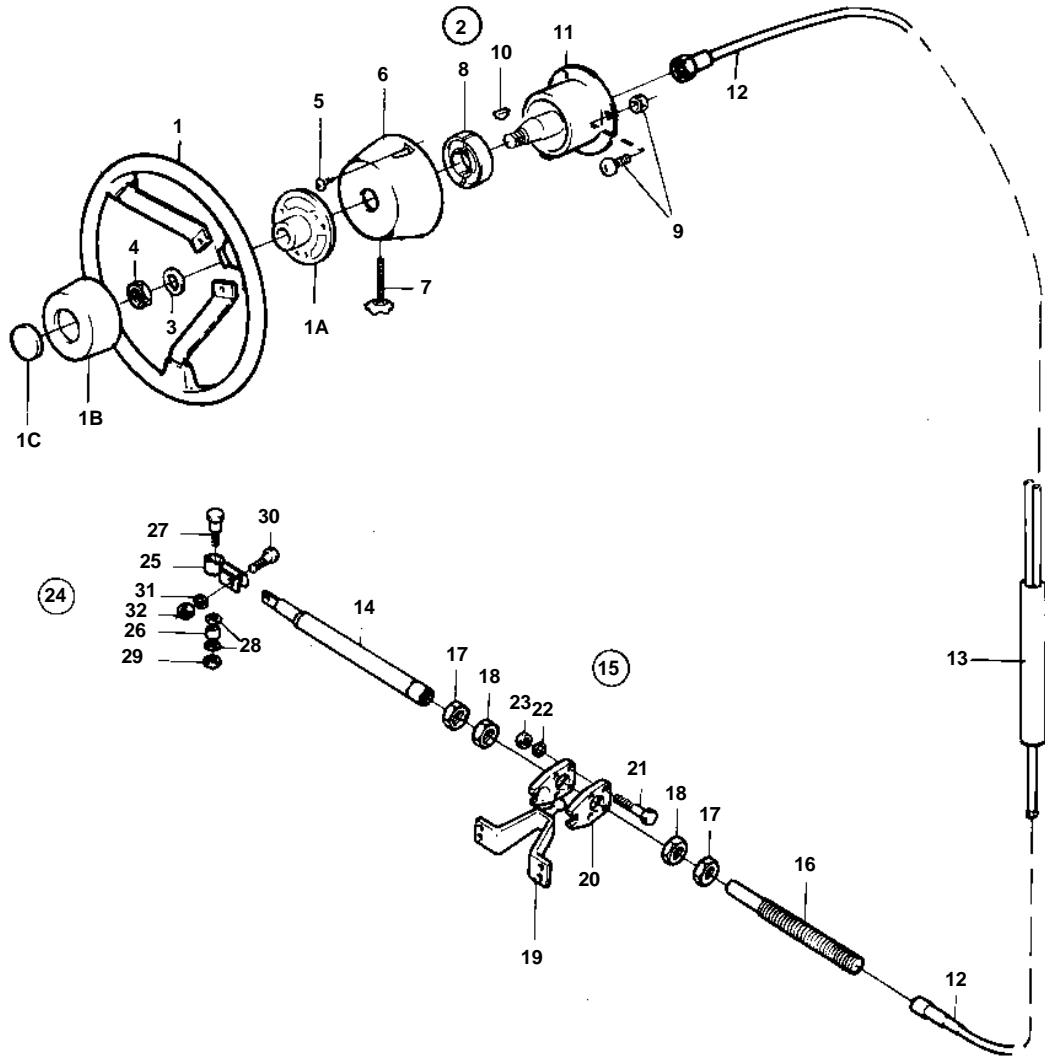

7533

740A, 740A/MS5

REF	PART NO.	QTY	DESCRIPTION	NOTES
1	850936	1	Steering wheel	
1A		1	• Steering wheel hub	
1B		1	• Steering wheel pad	
1C		1	• Emblem	
2	853182	1	Mounting kit	90°
	1140023	1	Mounting kit	90° BLACK
	853183	1	Mounting kit	70°
	1140024	1	Mounting kit	70° BLACK
3		1	• WASHER	
4		1	• NUT	
5		2	• SCREW	
6		1	• COVER	
7		1	• BRAKE SCREW	
8		1	• BRAKE	
9		4	• SCREW AND NUT	
10		1	• KEY	
11	853181	1	Steering gear	
12	828886	X	Steering cable	L = 2000 MM
	828887	X	Steering cable	L = 2250mm
	828888	X	Steering cable	L = 2500 MM
	828889	X	Steering cable	L = 2750mm
	853185	X	Steering cable	L = 3000 MM
	853186	X	Steering cable	L = 3250mm
	853187	X	Steering cable	L = 3500mm
	853188	X	Steering cable	L = 3750 MM
	853189	X	Steering cable	L = 4000 MM
	853190	X	Steering cable	L = 4250 MM
	853191	X	Steering cable	L = 4500 MM
	853192	X	Steering cable	L = 4750mm
	853193	X	Steering cable	L = 5000 MM
	828863	X	Steering cable	L = 5250mm
	853194	X	Steering cable	L = 5500 MM
	828864	X	Steering cable	L = 5750mm
	853195	X	Steering cable	L = 6000 MM
	828865	X	Steering cable	L = 6250mm
	853196	X	Steering cable	L = 6500mm
	828866	X	Steering cable	L = 6750 MM
	853197	X	Steering cable	L = 7000 MM
	853286	X	Steering cable	L = 7500 MM
	853287	X	Steering cable	L = 8000 MM
	853288	X	Steering cable	L = 8500 MM
	853289	X	Steering cable	L = 9000 MM
		X	Steering cable	L = 9750mm
		X	Steering cable	L = 1050 MM
		X	Steering cable	L = 1125 MM
		X	Steering cable	L = 1200 MM
13		1	Ds unit	Only for fly bridge.
14		1	Steering cylinder	FOR PORT MOUNTING.
		1	Steering cylinder	FOR STARBOARD MOUNTING.
15	853290	1	Stern attachment	
16	850771	1	• Anchorage	
17	850778	2	• Nut	
18	853306	2	• Nut	
19	851093	1	• Bracket	
20		2	• Anchorage, ATTACHMENT	REPL BY 828854 + 828857 + 951739
21	940101	4	• • Hexagon screw	
22	941906	4	• • Spring washer	
23	955781	4	• • Hexagon nut	
24	851122	1	• • Ball joint kit	REPL BY 828924
25		1	• • • BRACKET	
26		1	• • • Sleeve	
27		1	• • • Shoulder screw	

