

740A/MS5

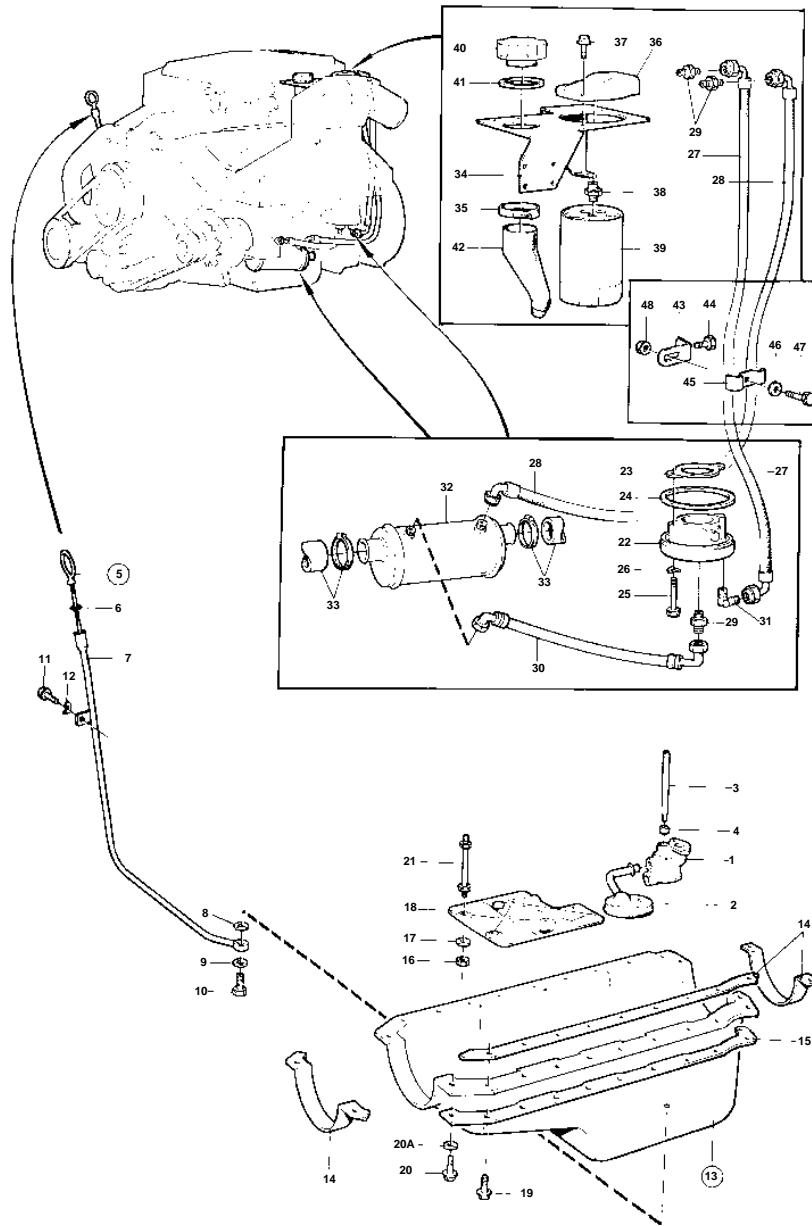

10957

740A/MS5

REF	PART NO.	QTY	DESCRIPTION	SEE SEC.	NOTES
1	856890	1	Oil pump		OIL PUMP 856890 IS ONLY STOCKED COMPLETE WITH STRAINER.
2		1	OIL STRAINER		
3	856602	1	Shaft		
4	835374	1	Sleeve		
5	856264	1	Oil dipstick		
6	949187	1	· O-ring		
7	856212	1	Pipe		
8	856295	1	Gasket		
9	841953	1	Gasket		
10	954393	1	Hollow screw		
11	940098	1	Hexagon screw		
12	942336	1	Spring washer		
13	856293	1	Sump		
14	856294	1	· Gasket kit		
15		2	Reinforcement		
16	946420	5	Lock nut		
17	940097	5	Washer		
18	856597	1	Baffle plate		
19	856599	20	Screw		
20	940100	2	Hexagon screw		
20A	955893	2	Washer		
21	856603	1	Stud		
22	841339	1	Connector		
23	856007	1	Gasket		
24	948882	1	O-ring		
25	955527	2	Hexagon screw		
26	941907	2	Spring washer		
27	856253	1	Hose assembly		EARLY TYPE
28		1	Hose assembly		EARLY TYPE
29	941750	3	Nipple		EARLY TYPE
30		1	Hose assembly		EARLY TYPE
31	941757	1	Elbow nipple		EARLY TYPE
32	856351	1	Oil cooler		EARLY TYPE
					REPL BY 856851
	856851	1	Oil cooler kit	19962	
33			COOLING WATER CONN.		SEE GROUP 2B
34	856479	1	Bracket		
35	943480	1	Hose clamp		
36	856265	1	Cardboard tube		
37	945444	2	Flange screw		
38	841174	1	Filter retainer		
39	835440	1	Oil filter		
			Bulletin P-21-7-1	P-21-7-1-EN	Oil Filters, GM gas engines
40	1378985	1	Filler cap		
41	940096	1	Gasket		
42	856266	1	Hose		
43	965537	1	Bracket		EARLY TYPE
44	955547	1	Hexagon screw		EARLY TYPE
45	942421	1	Clamp		EARLY TYPE
46	955896	1	Washer		EARLY TYPE
47	946544	1	Flange screw		EARLY TYPE
48	945407	1	Flange nut		EARLY TYPE